

TREE RETENTION CATEGORIES  
AS PER BS 5837:2005

-  A-CATEGORY TREE
-  B-CATEGORY TREE
-  C-CATEGORY TREE
-  R-CATEGORY TREE

© Crown Copyright 2008  
Reproduction in whole or in part is prohibited  
without the prior permission of Ordnance Survey.

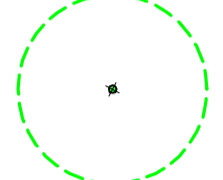
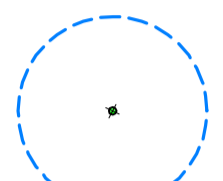
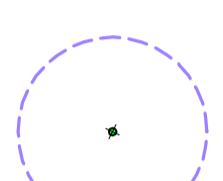
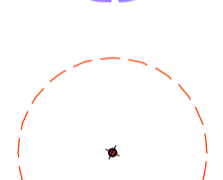
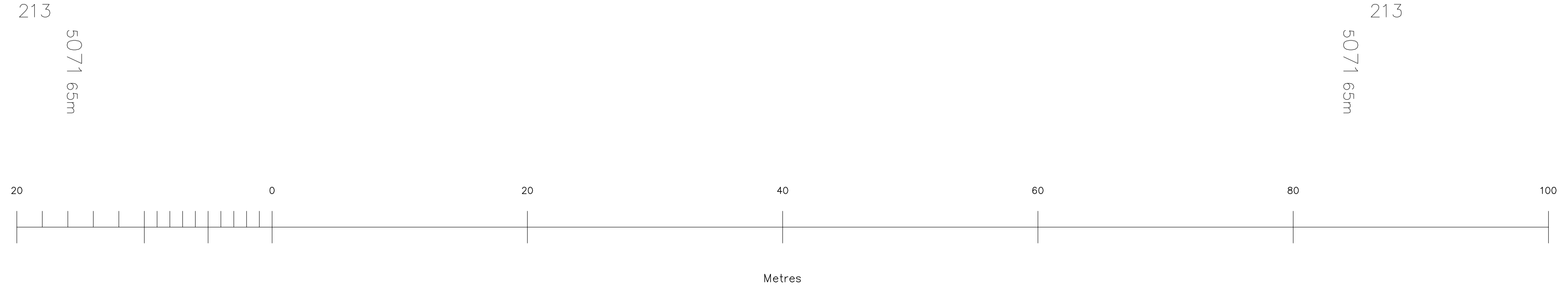
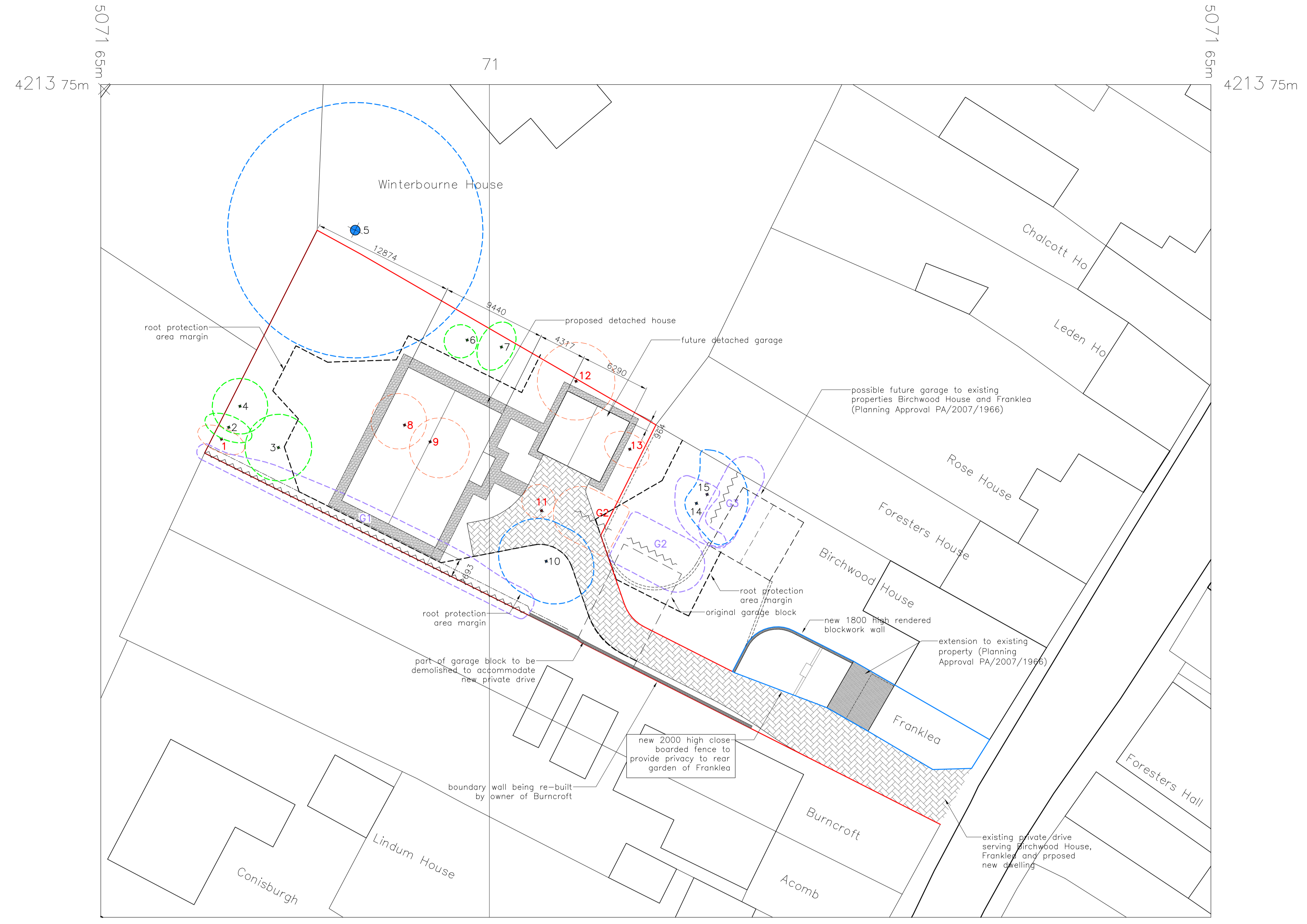

24/04/09	B	Information added.
24/08/08	A	Property reduced in scale & dividing walls added.
23/06/08	0	Issued for approval.
26/05/08	P	Preliminary issue for comment.
Date	Issue	Description

**J D Associates (Design Consultants) Ltd,**  
3 St James Road, Brigg, N Lincs. DN20 8DU.  
Tel/Fax; 01652 654333 e-mail; designs@jdassociates.co.uk

*Client*  
**Birchwood Developments (Lincs) Ltd,**  
4 Birch Gardens, Barton on Humber,  
N Lincs, DN18 5LD.

*Project*  
**Proposed detached house and garage,  
at rear of Franklea, High Street,  
Barrow on Humber, N Lincs, DN19 7AA.  
Site Plan indicating existing trees.**

Date: <b>May 2008</b>	Scales: <b>1:200</b>	Drawn: <b>AI</b>
<b>052007-05</b>	<b>Issue</b>	<b>P 0 A B</b>