

**PROPOSED SITE PLAN SCALE 1/100**

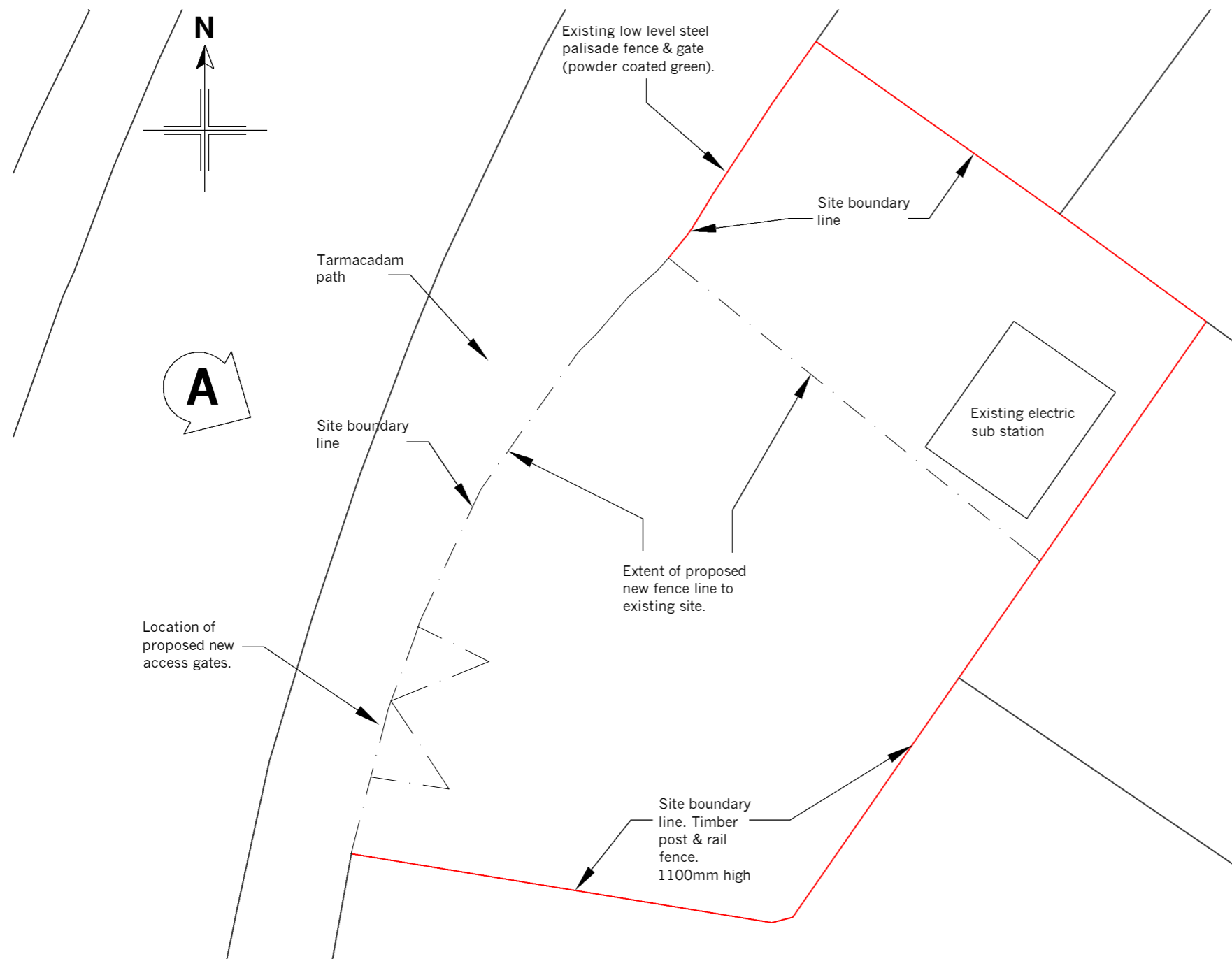

**OS SITE LOCATION PLAN SCALE 1/1250**

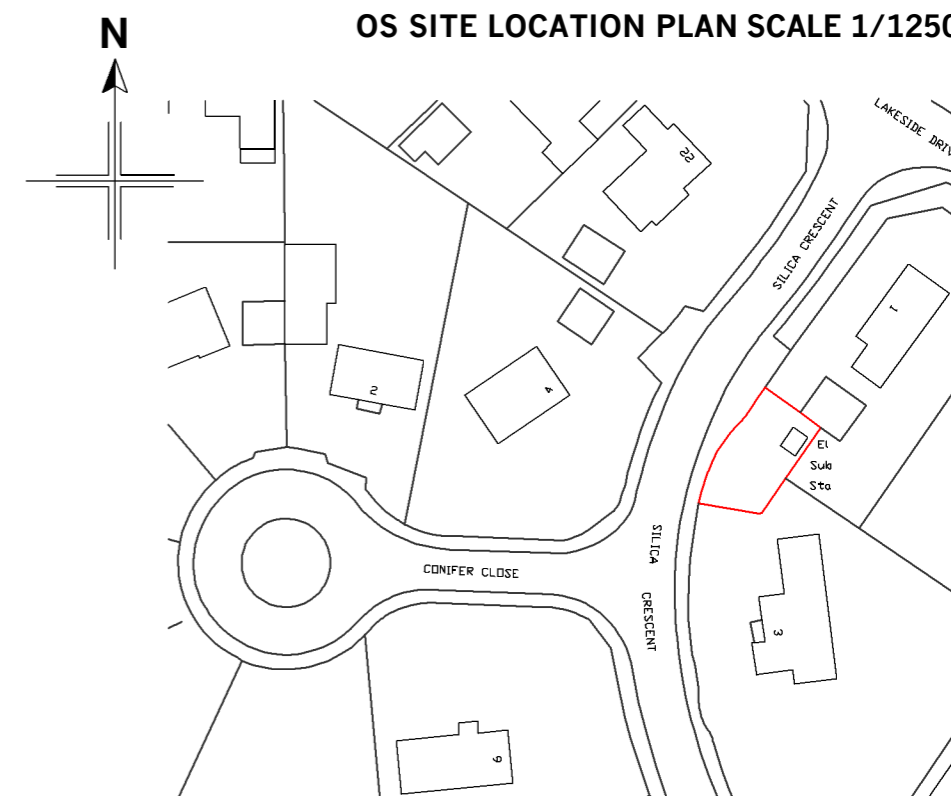

**Timber Fence**

New fence to be 1800mm high close boarded timber planks supported by timber fence posts and rails. Timber fence posts to be set into the ground with small concrete pad foundations and to be set at 2000mm centres.

2no. mild steel framed access gates to be installed to the right side of the front elevation both to be clad with close boarded timber planks to match the new fence line. Each gate leaf to be 1500mm wide and to open into the site.

The new fence and gates to be stained brown (colour to be approved by local authority)

**PROPOSED ELEVATION A SCALE 1/50**

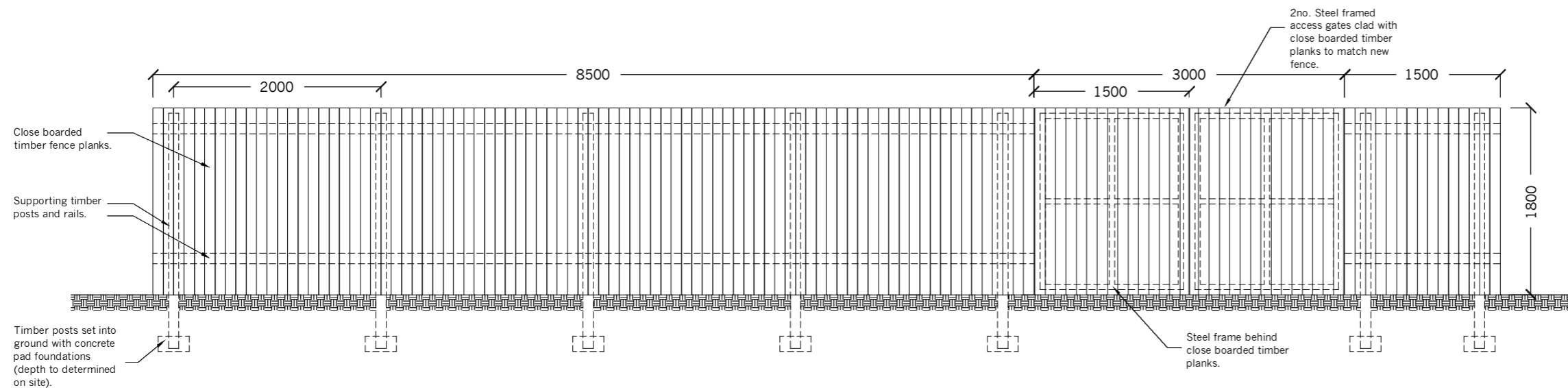

**Notes:**

© copyright. All rights reserved, this drawing must not be reproduced without the permission of Summers-Inman.

Dimensions must not be scaled from this drawing.

All dimensions are to be checked on site and discrepancies are to be referred to this office.

Drawn	DT	Date	16.05.12	Checked	MH
Rev	Date	Description			

Status: PLANNING



62 The Drive Gosforth, Newcastle upon Tyne, NE3 4AR  
 Tel: 0191 284 1121 Fax: 0191 285 5340  
 Email: enquiries@summers-inman.co.uk  
 Web Site: www.summers-inman.co.uk

Client: SEVERN TRENT WATER LTD.

Project: PROPOSED FENCE INSTALLATION - SILICA CRESCENT, SCUNTHORPE, DN17 2XA.

Title: OS SITE LOCATION PLAN, PROPOSED SITE PLAN & PROPOSED ELEVATION

Scale: AS SHOWN

Sht. A3

Drg. No. N9999/B/1/001

Rev. .