

- DO NOT SCALE
- This drawing is to be read in conjunction with all other relevant drawings.
- Should there be any conflict between the details indicated on this drawing and those indicated on other drawings the Engineer should be informed PRIOR to construction on site.
- Until technical approval has been obtained from the relevant Authority, it should be understood that all drawings and details issued are PRELIMINARY and NOT FOR CONSTRUCTION. Should the contractor commence site work prior to approval being given, it is entirely at his own risk.

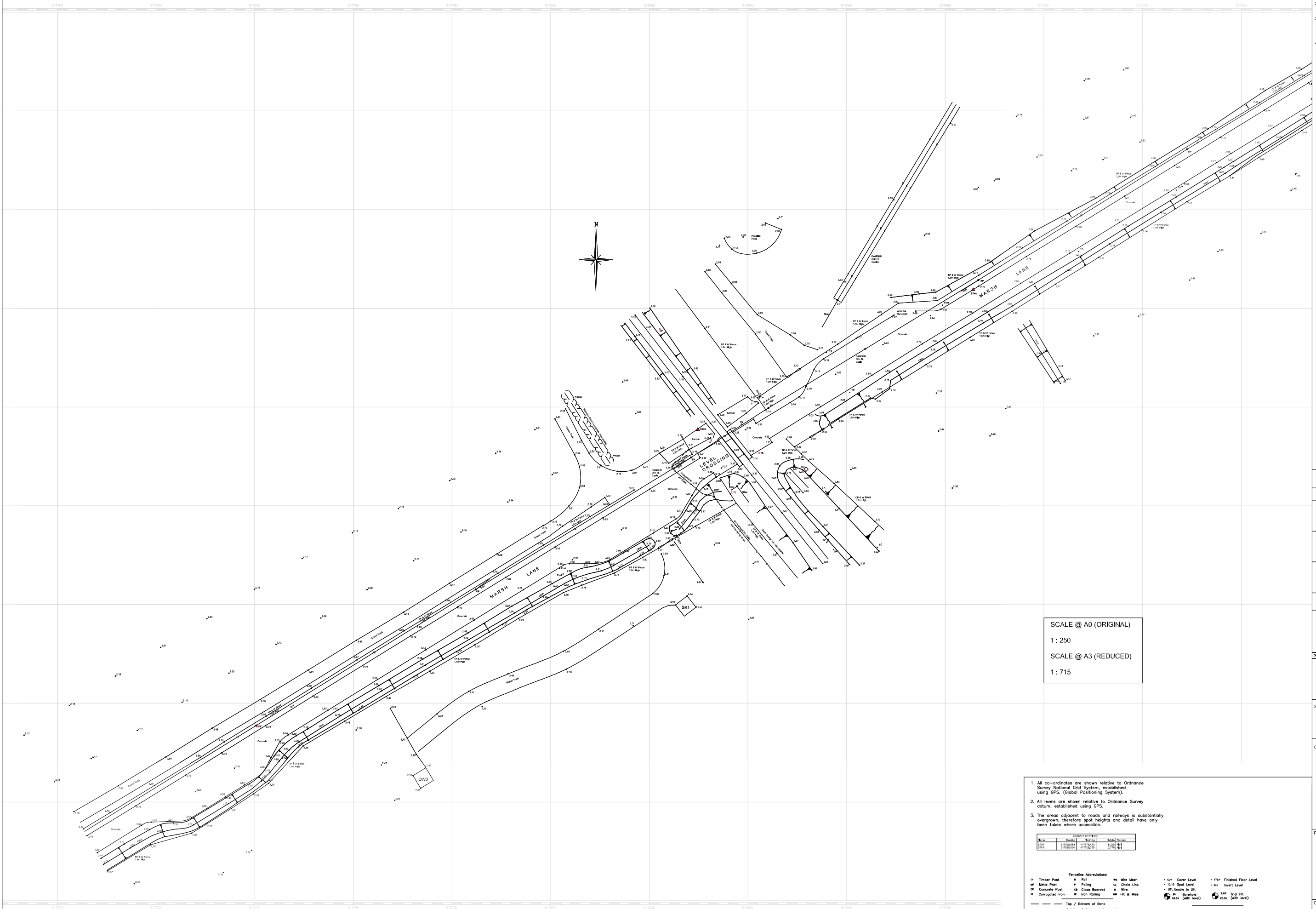

HEALTH, SAFETY AND ENVIRONMENTAL INFORMATION

In addition to the hazards/ risks associated with the types of work detailed on this drawing please note the following:

- Construction:
- 1)
 - 2)
 - 3)
- etc.
- Cleaning / Maintenance:
- 1)
 - 2)
 - 3)
- etc.
- Demolition:
- 1)
 - 2)
 - 3)
- etc.

It is assumed that all works will be carried out by a competent contractor working, where appropriate, to an approved method statement

DESCRIPTION	REV	DATE	BY	CHKD	APPD

HBPW 43 Bridgegate, Retford, Nottinghamshire DN22 7UX
 Civil & Structural Engineering Services Tel: (01777) 869896 Fax: (01777) 862481

STATUS FOR APPROVAL

CLIENT **ASSOCIATED BRITISH PORTS**
Network Rail

PROJECT
 MARSH LANE OVERBRIDGE CONSTRUCTION
 LOCATION : Marsh Lane, Immingham
 ELR : KIL2
 MILEAGE : 0m 1077yds
 OS REF : TA 177 177

DRAWING TITLE TOPOGRAPHICAL SURVEY

DRAWN	RH	DATE	JULY 2013
PROJECT ENGINEER	PM	SCALE	AS SHOWN @ A0
CHECKED	PM	APPROVED	PMW
DRAWING NUMBER	SL03517/101	REVISION	

SCALE @ A0 (ORIGINAL)
 1:250
 SCALE @ A3 (REDUCED)
 1:715

- All co-ordinates are shown relative to Ordnance Survey National Grid System, established using GPS. (Global Positioning System).
- All levels are shown relative to Ordnance Survey datum, established using GPS.
- The areas adjacent to roads and railways is substantially overgrown, therefore spot heights and detail have only been taken where accessible.

Station	Easting	Northing	Height
5174	51782.88	41752.42	5.22
5174	51783.04	41752.76	2.72

Fence/Line Abbreviations

TP Timber Post	W Wire Mesh	W Wire Mesh	W Wire Mesh
MP Metal Post	P Paving	CL Chain Link	CL Chain Link
CP Concrete Post	CB Close Boarded	W Wire	W Wire
CI Cast Iron	IR Iron Rolling	W HT & Mils	W HT & Mils

- 0.0 Cover Level	- FFL Finished Floor Level
- 10.0 Spot Level	- I.L. Invert Level
- U/L Unable to Lift	- 1.00 Trial Pit (with level)
- 20.00 (with level)	

△ Survey Station	□ 100 Marker Post	○ TL Traffic Light
□ 100 Marker	□ 100 Earth Road Cover	□ 100 Biting Beacon
□ CP Catchpit	□ 100 Road Cover	□ 100 Gully
□ IC Inspection Cover	□ 100 Electricity Cover	□ 100 Kerb Ortel
□ UT Unable to Survey	□ 100 British Telecom	□ 100 Water Pipe
□ SC Service Cover	□ 100 TV Cable	□ 100 Telephone Call Box
□ FH Fire Hydrant	□ 100 Telephone Post	□ 100 Urter Bin
□ GMS/GS Cover	□ 100 Electricity Post	
□ Tree / Scrub Canopy Line	□ 100 Lamp Column	
□ 100 Stop Post	□ 100 Stop Sign	
□ 100 Water Valve	□ 100 Road Sign	

EXISTING TOPOGRAPHICAL SURVEY Scale 1:250

