



MICHAEL COOPER M.ARB. Dip. P.R.A.
ARBORICULTURAL CONSULTANT



32 Parkland Close
Rossington
Doncaster
South Yorkshire
DN11 0BH

Tel No: [REDACTED]

Email: [REDACTED]

Mobile Tel No [REDACTED]

Tree Surveys
Mortgage Tree Surveys
Planning Applications
Planning Appeals
Public Enquiries
Expert Legal Witness

Our Ref MC

5TH September 2016

Dear Ian,

ARBORICULTURAL SURVEY, KING EDWARD STREET, BELTON.

I refer to our recent telephone conversation regarding the above subject.

- 1 The three trees on or adjacent to this site are all of mature status. I consider that the Horse Chestnut T1, is so poor it should be removed as a matter of routine. I have graded the second tree T2, which is the Lime, as a Category C. However, this is bordering on the point where it could also be considered for removal particularly in view of its close proximity to T1 which has suppressed it to some degree. It is not a good specimen and given the extent of the works that have been carried out around the rooting area it is debateable if it would survive in the long term.
- 2 T3 is growing within the garden of the adjacent property and its root protection area falls within the proposed development area. Care will need to be exercised near this section of the development to avoid any encroachment into the **Root Protection Area. (RPA)**
- 3 On the aspect of tree retention all development on site should comply with the requirements of **British Standard Institute Specification 5837, Trees in Relation to Design, Demolition and Construction, 2012.**
- 4 Any new tree/shrub planting should comply with **British Standards 4043, Transplanting root-balled trees and British Standard Institute Specification 3936, Nursery Stock Part 1. Specification for Trees and Shrubs.**
- 5 All tree surgery work should be carried in accordance with **British Standard Institute Specification 3998, Tree Surgery work;**

Always remember to use the professionals

- 6 Before any tree removal or tree surgery work is carried out, the site should be checked for the existence of any ***Tree Preservation orders, Conservation areas, Sites of Scientific Interest, Areas of Outstanding Natural Beauty, any deeds of covenant or/and other statutory instruments that may apply.***

Should you require further assistance with this matter please do not hesitate to contact me.

I do hope this is all satisfactory and I look forward to receiving your further instructions.

Kind regards,

Mick Cooper

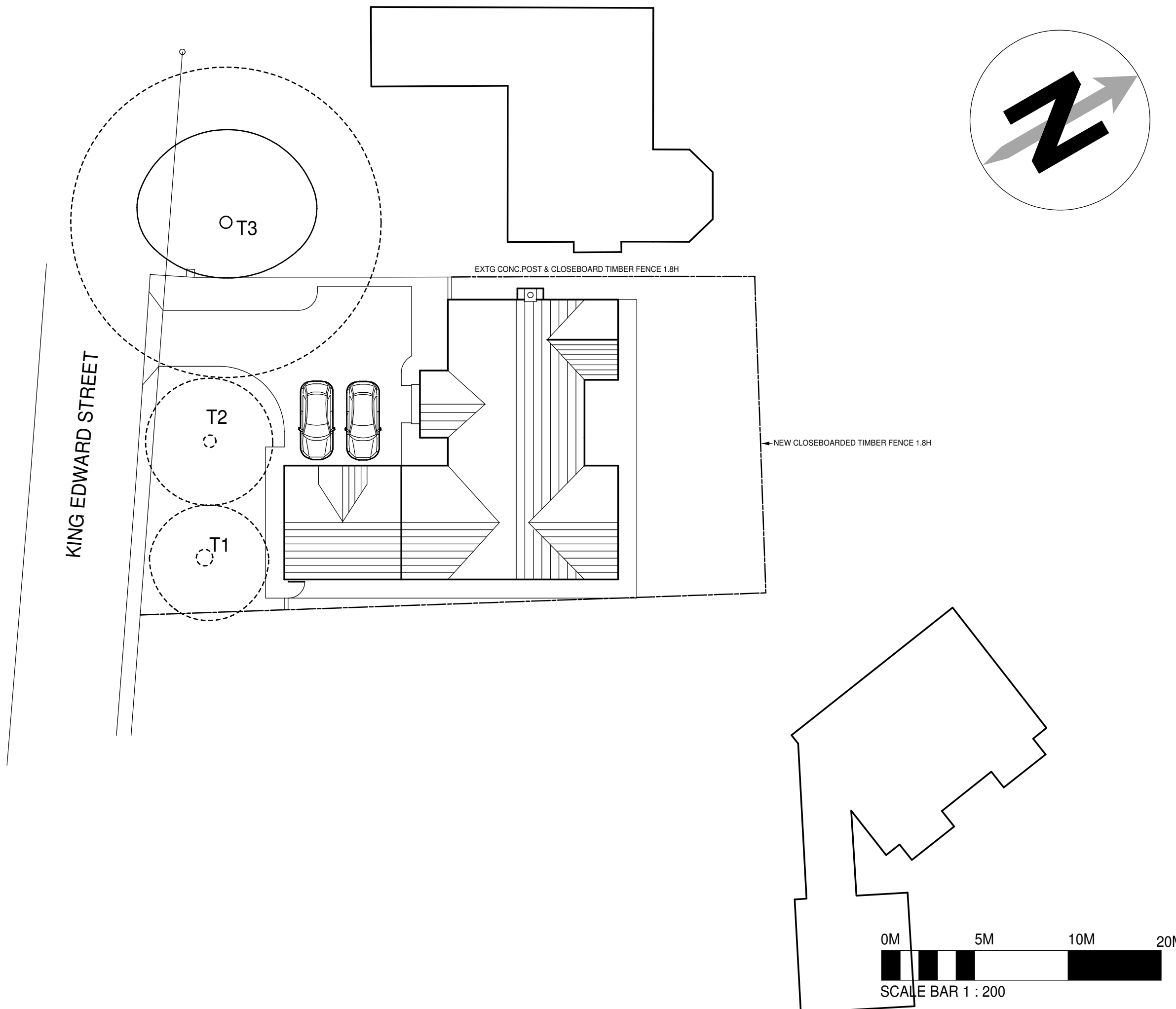

CLIENT MR D MUSCROFT

DRAWING TITLE SITE PLAN

PROJECT:
 PROPOSED NEW DWELLING
 OFF KING EDWARD STREET
 BELTON
 DONCASTER
 DN9 1QN

DRAWING No 016 / 032 / SL

DRAWING DATE JUNE 2016

DRAWN BY IKB SCALE 1:200 @A3

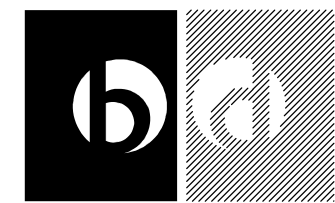

BARRATON
 DESIGN STUDIO

BARRATON DESIGN STUDIO
 UNIT 1
 BRANCROFT FARM
 AUSTERFIELD
 DONCASTER
 SOUTH YORKSHIRE
 DN10 6EZ
 TEL: 01302 771188
 EMAIL: ianbarraton30@gmail.com

Survey carried out in September 2016 by; Site: King Edward Street, Belton.
Michael Cooper. M.Arb. Dip. P.R.A

Carried out on behalf of Agent: Barraton design
Instructing Officer; Ian Barraclough.

TR NO	SPECIES	TRUNK DIAMETER	ROOT PROTECTION AREA RADIUS	OVERALL ROOT PROTECTION AREA
T1	Aesculus hippocastanum, Horse Chestnut.	U	U	U
T2	Tilia, Lime.	690mm	8.40m	221.70 sq mt
T3	Tilia, Lime	710mm	8.70m	237.82 sq mt

Survey carried out in September 2016 by;
 Michael Cooper. M.Arb. Dip. P.R.A
 Tel 01302 868733 Mobile 07758089737
 Email: arbor32@live.com

Site: King Edward Street,
 Belton

Carried out on behalf of client: Barraton design
 Instructing Officer; Ian Barraclough.

TR NO	SPECIES	HGT m	STEM DIAM mm	BR SPREAD m	HGT OF CRN CLRN m	A G E	PHYS COND	STRUCTURAL CONDITION.	PRELIMINARY MANAGEMENT RECOMMENDATIONS	EST. REMAIN CONT years	C A T
T1	Aesculus hippocastanum, Horse Chestnut.		850mm	N E S W		M	Poor	This tree is in a very poor condition with extensive crown die-back. The crown is sparse and numerous roots have been damaged at an earlier stage during works on this site.	Remove.	U	U
T2	Tilia, Lime	11m	690mm	N 4.0m E 4.5m S 5.0m W 5.0m	GL	M	Fair	Main trunk divides to two at 3.5m. Large wound/Cavity to the north at 2.5m at the point where a major limb has been lost. Extensive sucker shots at the basal area and into the crown. Some dead wood.	Remove sucker shoots	40	C2
T3	Tilia, Lime		710mm	N E S W	2m	M	fair	This is a private tree growing in the adjacent property.	No work required	40	B2

ROOT PROTECTION ZONE

The attached sheet(s) provide the root protection areas for each tree on site that is recommended for retention. This allows for developers to calculate the distance within which they can build in proximity to each tree.

I have provided two figures, these being;

The Overall Root protection zone.

This is in effect the total area around the trees canopy and rooting area which is required to be kept free of any development or encroachment to ensure it survives the development and post development period.

The Root Protection Radius

This is the radius of any area necessary to meet the requirements of the overall root protection zone. This should ideally be applied across the full width of the trees canopy.

NB These calculations are in accordance with the requirements of the British Standard Institute Specification 5837, Trees in Relation to Design, Demolition and Construction, 2012.

KEY TO M. COOPER TREE SURVEY HEADINGS

TR NO = TREE NUMBER

SPECIES= TREE SPECIES

HGT= OVERALL HEIGHT

STEM DIAM=TRUNK DIAMETER WHEN MEASURED AT 1.5 METRES FROM GROUND LEVEL

BR SPREAD = BRANCH SPREAD IN METRES ON ALL DIRECTIONS

HGT OF CRN CLRN= HEIGHT OF CROWN CLEARANCE TO THE BOTTOM BRANCH

AGE = YT= YOUNG TREE, SM = SEMI MATURE, M =MATURE, OM = OVER MATURE, VT = VETERAN

PHYS COND=PHYSIOLOGICAL CONDITION IE GOOD, FAIR, POOR, DEAD

STRUCTURAL CONDITION=OVERALL CONDITION, WEAKNESSES, DEFECTS ETC

PRELIMINARY MANAGEMENT RECOMMENDATIONS=SUGGESTED TREE SURGERY WORK

CAT = CATEGORY IN ACCORDANCE WITH BRITISH STANDARD INSTITUTE SPECIFICATION 5837 FOR TREES IN RELATION TO DESIGN, DEMOLITION AND CONSTRUCTION-RECOMMENDATIONS :2012

SS=SINGLE STEM TREE

MS= MULTI-STEM TREE

S=SHRUB OR SHRUBBERY

W=WOODLAND AREA OR WOODED PERIMIETER/SCREEN

H=HEDGELINE

G=GROUP

NB. WHEN ANY REFERENCE IS MADE IN THE REPORT ON WOUNDS OR A HEIGHT MEASUREMENT, THIS IS TAKEN AS BEING FROM GROUND LEVEL

U=UNSUITABLE FOR RETENTION

= ACCESS COULD NOT BE GAINED TO CARRY OUT FULL SURVEY