

BS 5837: 2012 Tree Condition Survey.

Plot adjacent 276 Burringham Rd, Scunthorpe,
DN17 2BH.

Planning ref PA/2018/620.

Definition. This is a Tree Survey as defined in British Standard 5837: Trees in relation to Design, Demolition and Construction 2012.

British Standard 5837 gives recommendations and guidance on the principles to be applied to achieve a satisfactory juxtaposition of trees, including shrubs, hedges and hedgerows, with structures.

Scope. This survey will identify the trees present on site, assess physiological and structural condition and provide guidance for the future management of the trees. Ultimately, and if required recommendations will be given for tree pruning, removal and replacement. This survey should be regarded as an initial appraisal and observations, assessments or recommendations relating to tree protection zones, remedial tree works and protective fencing are beyond the scope of this report.

General. The trees were inspected, from the ground, by Steve Burrows on Tuesday 29th May 2018. The weather conditions at the time of inspection were dry and calm. The trees were in full or partial leaf.

The following survey is based upon the findings of that visit and the conditions found on that day.

This survey provides quantitative data on tree species, height, stem diameter, crown clearance, crown spread, age class and a brief qualitative assessment of tree condition and future potential. A detailed inspection with respect to decay, defects and hazard is also included. Trees found to be in a structurally dangerous condition are identified.

Location.

The location of the trees is shown on the site plan.

Tree Protection.

Checks have been made with the Local Authority and it is understood that a Tree Preservation Order covers the site.

Terminology and Definitions.

Within this report tree condition is defined as follows:-

Good. Healthy, full crown, long life expectancy, no significant defects.

Fair. Generally healthy, some thinning of the crown, some defects of low significance, limited life expectancy.

Poor. Lacking vitality, short life expectancy, sparse leaf cover, significant defects.

Dangerous/Dead. Urgent removal required.

Standards for Tree Works. Where tree works are recommended it is anticipated that these will be completed to British Standard 3998 by qualified and experienced Arborists.

Recommendations for Tree Removal and Subsequent Re-Planting.

Where tree removal is recommended it is anticipated that replacement tree species, numbers and sizes will be agreed with the Planning Authority.

Tree stock and planting to be completed to British Standard 8545: Trees: from nursery to independence in the landscape.

Other Landscaping Proposals.

None required at this stage.

Steve Burrows.

Btec National Diploma in Forestry.

Tec/Arb.

LANTRA Professional Tree Inspectors Certificate.

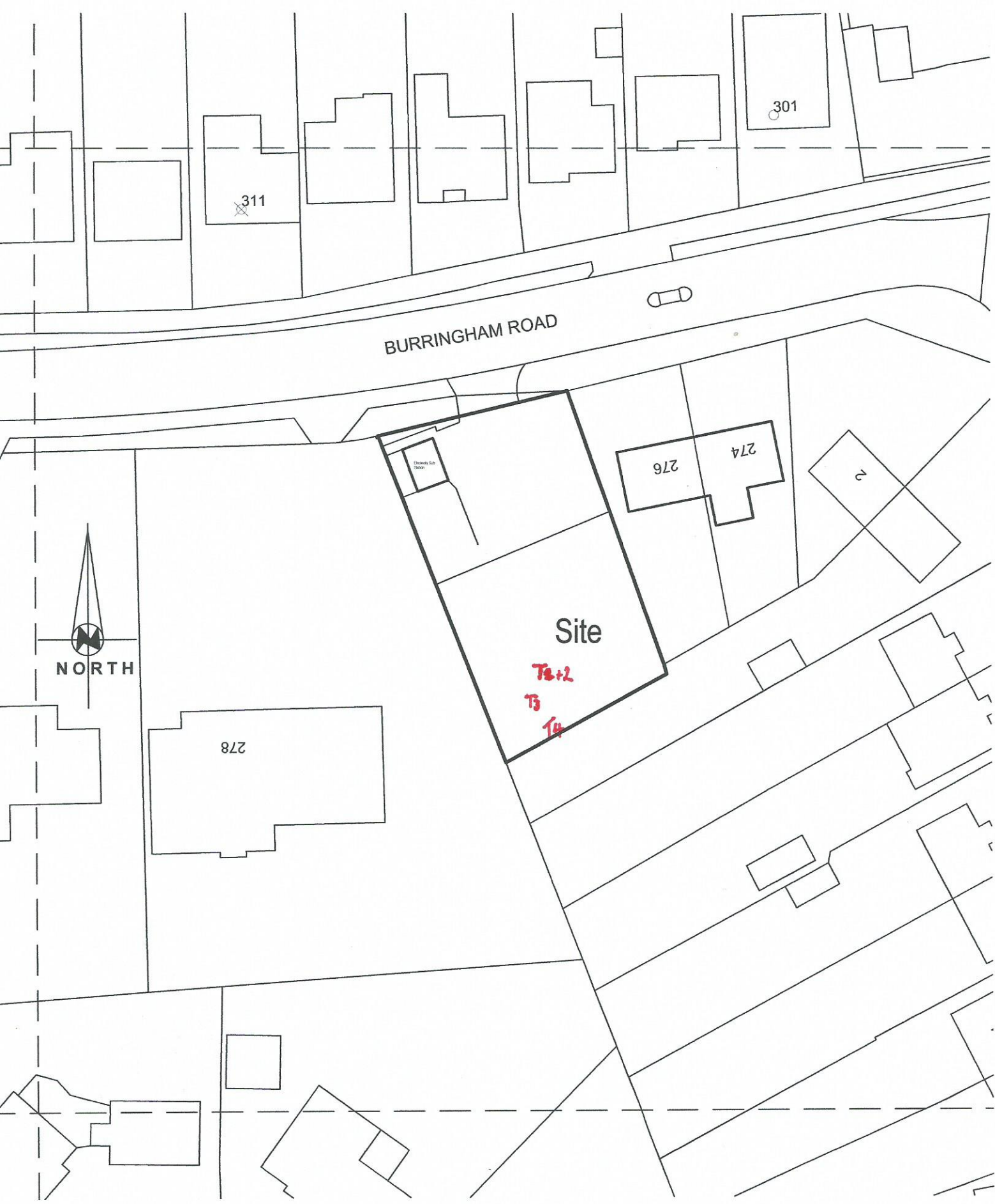

LOCATION PLAN 1-500

Tree Location Plan : Plot adjacent 276 Burringham Rd