

NOTES:

1. THIS DRAWING IS BASED ON BARTON WILLMORE ILLUSTRATIVE LAYOUT REVISION F RECEIVED 28/01/2019, D2R SURVEY TOPOGRAPHICAL SURVEY DRAWING B2R-WNT-01 AND 02 DATED 21/03/2018, ANGLIAN WATER SEWER RECORDS, ORDNANCE SURVEY MAPS AND INFORMATION TAKEN FROM HISTORIC MAPPING DATA.
2. THIS DRAWING SHOULD BE READ IN CONJUNCTION WITH THE FORTM FLOOD RISK ASSESSMENT REF: 1029-R001-V3.

KEY:

- PLANNING APPLICATION DEVELOPMENT BOUNDARY
- ● EXISTING PUBLIC SURFACE WATER SEWER (FROM ANGLIAN WATER RECORDS)
- ● EXISTING PUBLIC FOUL WATER SEWER (FROM ANGLIAN WATER RECORDS)
- EXISTING WATERCOURSE (FROM TOPOGRAPHIC SURVEY, OS RECORDS AND SITE WALKOVER)
- - - LINE OF HISTORIC OPEN WATERCOURSE (NOW INFILLED)
- RECORDED LOCATION OF NATURAL SPRING
- ● PROPOSED SURFACE WATER NETWORK
- ● PROPOSED FOUL WATER NETWORK
- ● PROPOSED FOUL WATER RISING MAIN, 2% OPTION ROUTES PROVIDED: OPTION A: 188m OPTION B: 376m
- ● PROPOSED SOUTHERN BOUNDARY LAND DRAIN SYSTEM
- PROPOSED EASEMENT (SEWER NETWORK LOCATED OUTSIDE ADOPTABLE HIGHWAY)

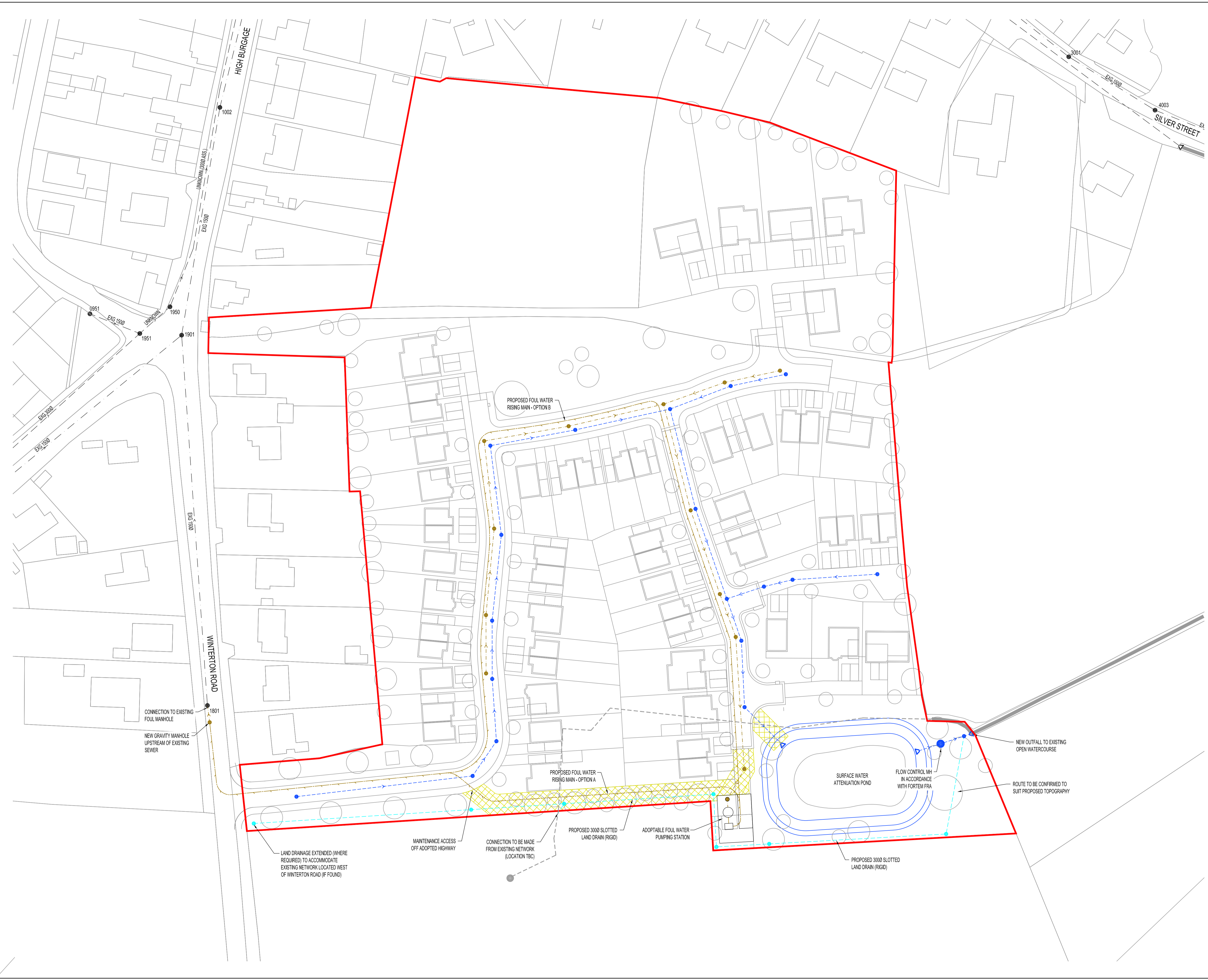

Rev	Date	Amendments	By
D	29.07.19	Line of historic watercourse added.	ML
C	07.04.19	Minor amendments to land drainage system.	ML
B	16.02.19	Revised in accordance with updated architects layout and additional survey information	ML
A	25.09.18	Minor amendments.	RD

Drawing Status:		PLANNING
-----------------	--	-----------------

FORTEM

FORTEM Civil Engineering Consultants Ltd
 T. 07377 556170 / 07748982468
 E. info@fortemconsultants.co.uk
 W. www.fortemconsultants.co.uk

Client
KCS DEVELOPMENTS

Project
HIGH BURGAGE, WINTERINGHAM

Drawing Title:
PROPOSED DRAINAGE STRATEGY

Drawn: RD	Scale: 1:500 @ A1
Checked: ADC	Date: JUNE 2018

Drawing No. 1029 - 002	Rev. D
----------------------------------	------------------

C:\Users\msh\OneDrive\FORTM\1029 - High Burgage, Winterringham\Drawings\1_FORTM\1029 - 002 Proposed Drainage Strategy.dwg 29 Jul 2019 - 13:30m