

notes:  
 This drawing is to be read in conjunction with all related drawings. Do not scale from this drawing. All dimensions must be checked and verified on site before commencing any work or producing IHP drawings. The originator should be notified immediately of any discrepancy. This drawing is copyright and remains the property of Philip Bingham Architects and Planning unless express agreement has been offered otherwise.  
 All foundation details are requirements are to be determined on site by the building inspector and/or structural engineer. Drainage routes are assumed and are to be confirmed by the builder during construction. Ramps and steps are shown notationally and will be determined by on site surveys and levels. All to current building regulations.

NOTE:

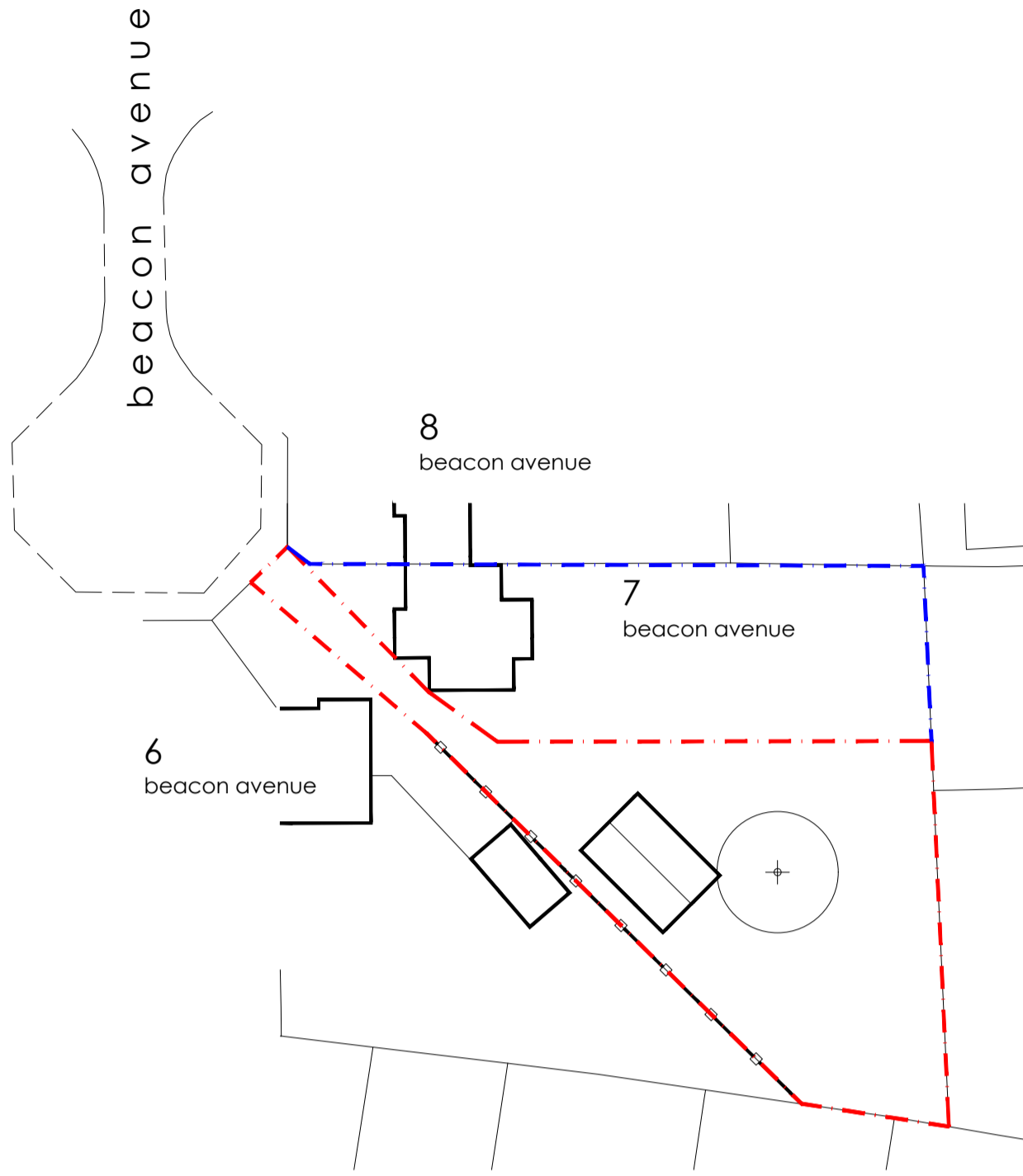

existing site plan  
1:500

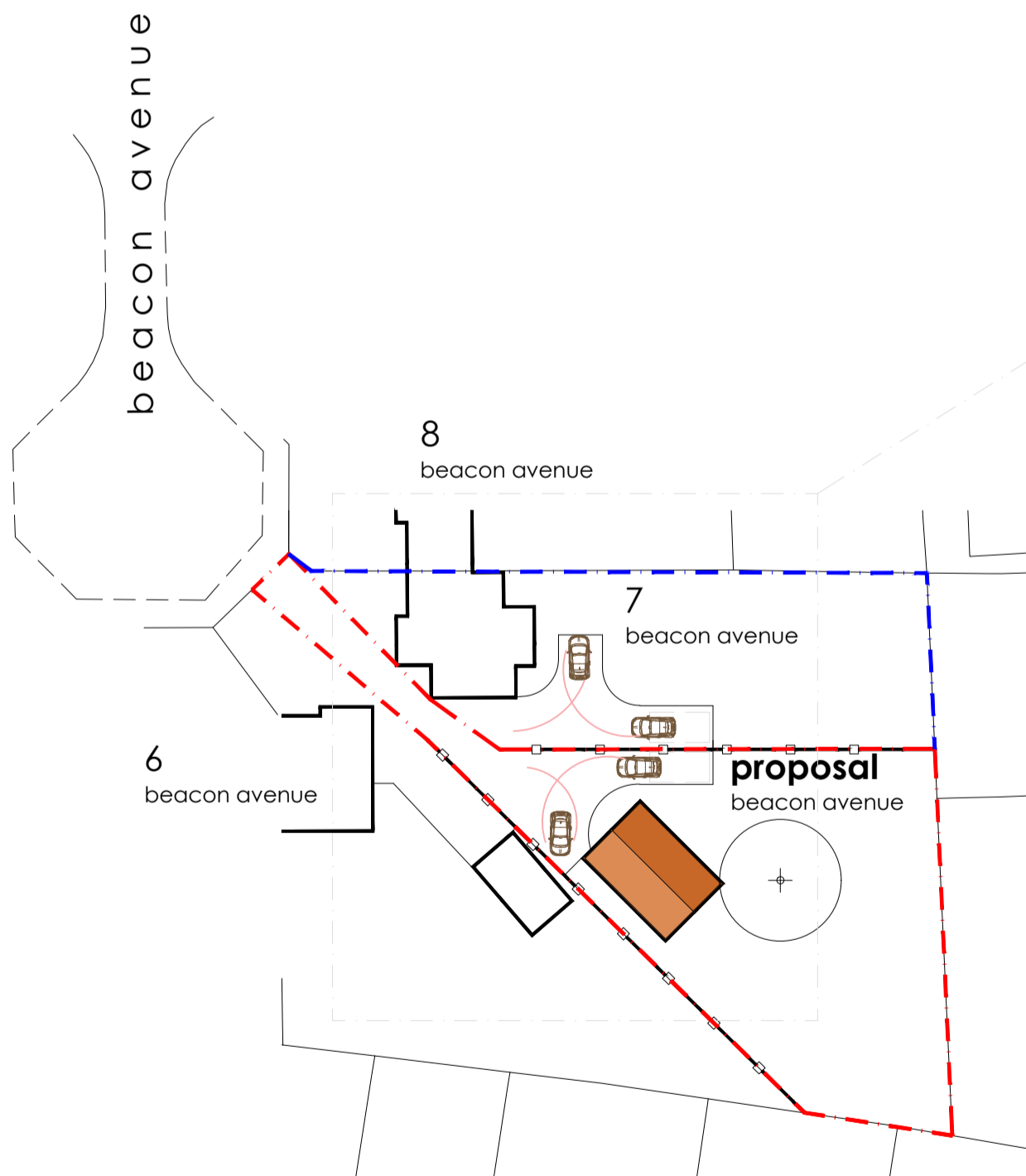
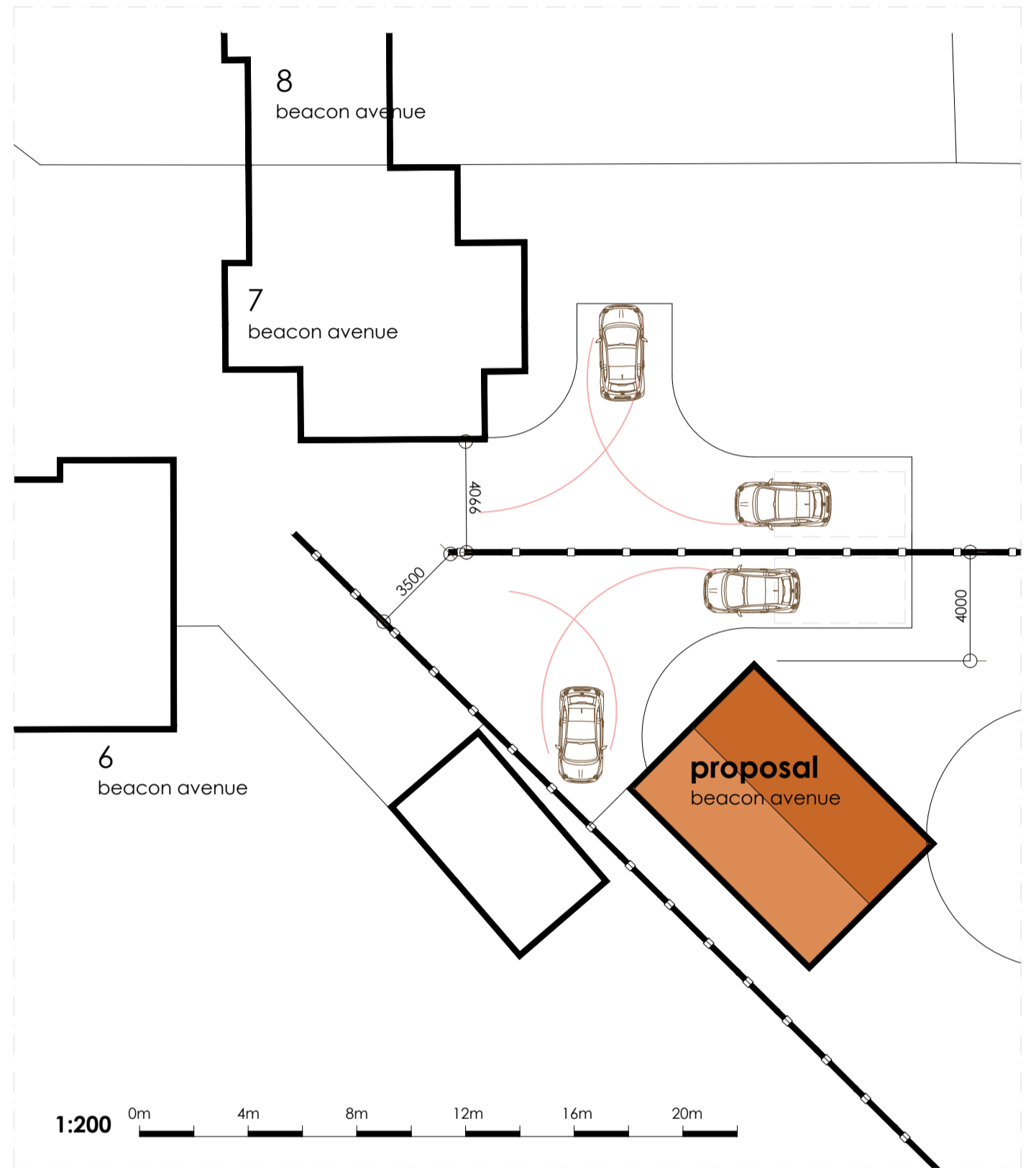

proposed site plan  
1:500

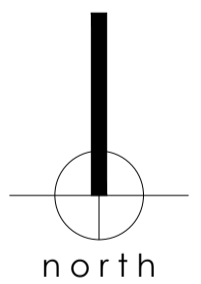

A	issued for 'PLANNING'	22 September 2020	PLB
rev		date	by

client:  
 Mr. H. Dickinson  
 7, Beacon Avenue, Barton upon Humber. DN18 5DP

scheme:  
 -

title:  
 Existing and Proposed Site Plans

drawn by: P. Bingham	date: 21 September 2020
checked by: H. Dickenson	sheet: A2
drawing number: 0222 / 102	scale: 1:500
revision: A	status: PLANNING

14a market place, homsea, east riding of yorkshire, HU18 1AW  
 01964 533777 :: info@pbap.uk