

ARBORICULTURAL METHOD STATEMENT

Arboricultural Method Statement and Protection Plan

(in accordance with BS 5837:2012 - *Trees in relation to design, demolition and construction – Recommendations*)

Site: **land off Silver St, Barrow Upon Humber, North Lincs**

Prepared for: **Charworth Homes**

Date: 5th July 2022

Reference: QU-792-22-EQUANS

Surveyor/Report Author: **Andrew Hudson** ND Btec Forestry/Arb / TechArborA
Senior Arboricultural Consultant

andrew.hudson@engie.com / 07979 303 536 / dina.mysko@engie.com / 07971 804 783

EQUANS - Arboricultural Consultancy, New Oxford House, 2 George Street, Grimsby, North East Lincolnshire, DN31 1HB

Registered in England and Wales. Registered No: 00598379. Registered Office: Q3 Quorum Business Park, Benton Lane, Newcastle Upon Tyne NE12 8EX



Client Details: **Charworth Homes**

James Pearson
82 Oswald Road,
Scunthorpe,
North Lincolnshire,
DN15 7PA

Email: James Pearson [REDACTED]

Agent Details: **Lincs Design Consultancy**

Ricky Newton
12 Vickers Lane
Louth
Lincolnshire
LN11 9PJ

T: [REDACTED]

M: [REDACTED]

Email: Ricky Newton [REDACTED]



CONTENTS

Page 4	1.0-1.3	INTRODUCTION
	1.4	<i>Scope of Recommendations and Techniques</i>
	1.5	<i>Description of Development</i>
	1.6-1.7	<i>Site Description</i>
Page 5	1.8-1.9	<i>Site Description (cont.)</i>
	2.0	STATUS OF THE SITE
Page 6	3.0	ARBORICULTURAL METHOD STATEMENT (AMS)
	3.1	<i>Pre-Development Tree Work</i>
	3.2	<i>Specification of Tree Works</i>
	3.3	<i>Limitations</i>
Page 7	3.4	<i>Schedule of Tree Works</i>
Page 8	3.5	<i>Arboricultural Supervision (Pre-Commencement of Development)</i>
	3.6-3.7	<i>Installation of Protection Measures</i>
Page 9	3.7-3.9	<i>Installation of Protection Measures</i>
	3.10	<i>Arboricultural Inspection (Protection Measures)</i>
Page 10	3.11	<i>Detail for Specification of Protective Barrier</i>
Page 11	3.12	<i>Construction Phase</i>
	3.13-3.15	<i>Installation of Services</i>
	3.16	<i>Main Site Construction Works</i>
	3.17	<i>Construction Phase Complete</i>
Page 12	3.18-3.20	<i>Snagging</i>
Page 13	4.0	KEY PERSONNEL
Page 14	5.0	SUMMARY AND PHASING OF WORK

APPENDICES

Appendix "A"	Tree Protection Plan
--------------	-----------------------------

Note: A copy of this method statement must be permanently available on site for the duration of development activity

1.0 INTRODUCTION

1.1 The purpose of this method statement is to evaluate the direct and indirect effects of the proposed design/layout and to ensure good practise in the protection of trees during the construction of this development.

1.2 EQUANS Arboricultural Consultancy has been instructed by agent Lincs Design Consultancy, to prepare this Arboricultural Method Statement and Protection Plan for this proposed development, based on the recommendations and guidance outlined within the BS 5837:2012 '*Trees in relation to design, demolition and construction – Recommendations*'.

1.3 This method statement should be included as part of the specification and schedule of works and issued to all relevant parties including the building contractor and sub-contractors.

1.4 ***Scope of Recommendations and Techniques***

An arboricultural consultant should be appointed by the developer for advice on the tree management for the site and to attend meetings, as set out within this method statement.

1.5 ***Description of Development***

A revised design/layout has been prepared and made available for the purpose of this AMS. It is proposed to develop this site with the introduction of six detached residential dwellings with associated access, driveways and amenity garden space. The principal access into the site is expected to be created just off Silver Street.

1.6 ***Site Description***

The application site is historically known as Briar Lodge on Silver Street, Barrow Upon Humber. The existing dwelling, known as Briar Lodge, is a single storey, red brick constructed property with a pantile type roof. The front elevation is painted white and fronts directly onto Silver Street. The whole site extends to around 2023.4sq m and mostly this is the rear garden space serving the host property. The property and grounds are unoccupied and have been for some time now. The dwelling looks in a state of disrepair and the gardens have become overgrown and untidy.

1.7 The site sits within the village of Barrow Upon Humber, around 140m from the southwest fringes of the village. Barrow Upon Humber is within the unitary authority of North Lincolnshire. The village is situated near the Humber Estuary, about 3 miles (5 km) east from Barton-upon-Humber. The small port of Barrow Haven, 1.5 miles (2.4km) north, on the railway line from Cleethorpes and Grimsby to Barton-upon-Humber.

1.8 The surrounding land use is residential, with a mixture of house type and size. South to the site Silver Street runs in an easterly/westerly direction, joining Fen Road on the western fringe of the village and Thornton Street or the A1077 to the east, the main artery road through the village. Beyond the village extends the land use is agricultural, active arable farmland.

1.9 Within the site, there is a mixture of trees & hedges, although these are positioned mainly towards the boundaries. Canopy coverage within the site is strictly limited and mainly the site is open grassland, rough grass that has become overgrown and untidy. The site boundary features are mixed. The north, east and west side boundaries are mainly 1.8m timber fencing, the southern boundary is primarily a conifer hedge line, although this has now become very overgrown and untidy, with hedge plants beginning to establish as individual trees.

2.0 *STATUS OF THE SITE*

The Local Planning Authority (LPA) is North Lincolnshire Council. Using the Councils on-line mapping search facility, it was confirmed on the 5th of July 2022 that no trees within or adjacent to the site are afforded the protection of a Tree Preservation Order. This also confirmed that the site and land adjacent is not within a Conservation Area.

3.0 ARBORICULTURAL METHOD STATEMENT (AMS)

3.1 Pre-Development Tree Work

Prior to any construction activity taking place the recommended tree works should be completed.

3.2 Specification of Tree Works

In accordance with the final design/layout tree works are required, as specified, to facilitate development (see '3.4 – 'Schedule of Tree Works' page 7 and Appendix "A" - 'Tree Retention and Removal Plan' of the Arboricultural Impact Assessment (AIA). Reference should also be made to the details within the original formal Arboricultural Report.

3.3 Limitations

Trees T2, T3 and T4 are located off-site. On this basis the extent of tree works is limited from site-side only unless permission from the tree owner is given to enter the land on which the tree stands. Under established 'common law' pruning the overhanging branches is permitted without the owner's consent. There is a legal duty, however, to take 'reasonable care' whilst undertaking any works, and there is possible liability if the tree is damaged, or it has become unstable. Generally, it would be sensible to inform the tree owner prior to works taking place. For the works that have been recommended on trees T2, T3 and T4 it should be recognised that for any parts cut off from the trees, these remain the property of the tree owner, and therefore should be offered back to the tree owner prior to disposal.



3.4 Schedule of Tree Works

KEY	
	Tree to be removed
	Tree identified for remedial work
	No work recommended

Individual Trees:	
T1	Lilac - Fell
T2	Sycamore (off-site) - Reduce northeast side canopy overhang into the site by 5m, cutting back to viable growth points where practically possible, to leave a finished canopy spread of approx. 2m, measured from the base of the tree. Crown lift northeast side canopy spread by up to approx. 5m, cutting back to the boundary line. Re-shape accordingly.
T3	Sycamore (off-site) - Reduce northeast side canopy overhang into the site by 5m, cutting back to viable growth points where practically possible, to leave a finished canopy spread of approx. 2m, measured from the base of the tree. Crown lift northeast side canopy spread by up to approx. 5m, cutting back to the boundary line. Re-shape accordingly.
T4	Silver Birch (off-site) - Reduce northeast side canopy overhang into the site by 1m, cutting back to viable growth points where practically possible, to leave a finished canopy spread of approx. 3m, measured from the base of the tree.
Groups of Trees:	
G1	Fell
G2	Fell
G3	Fell

Note: Competent contractors must be appointed. All works should be carried out in accordance with the BS 3998:2010 Tree Work – Recommendations

Note: All tree works must be completed to the satisfaction of the Local Authority Tree Officer before any other works begin



3.5 **Arboricultural Supervision (Pre-Commencement of Development)**

A pre-commencement meeting should be held on site before any site clearance, ground works and construction work begins. This would normally be attended by the site manager, the arboricultural consultant and a local authority (“LA”) representative, preferably the Local Authority Tree Officer. In the event that an LA representative declines to be present, the arboricultural consultant should inform the LA in writing of the details of the meeting. This meeting should include the following:

- Inspection of pre-development tree works to ensure works have been carried out in accordance with the approved specification of works and has been carried out to the correct standards, i.e., BS 3998:2010 ‘*Tree work – Recommendations*’.
- Any additional tree works expected outside of the approved specification of works will be agreed and recorded.
- All protection measures detailed in this method statement should be fully discussed so that all aspects of implementation and sequencing are understood by all the parties.
- Any specialist engineered methods should be fully discussed so that all aspects of implementation and sequencing are understood by all the parties.
- The details of the programme of protection and no-dig solution, if required, should be agreed and finalised.
- Any site supervision arrangements between the arboricultural consultant and developer should be agreed and finalised. Including any site visits deemed necessary, by a local authority (“LA”) representative.

3.6 **Installation of Protection Measures**

Trees will be protected by barriers and ground protection as described in appendix “A”. The positioning of protective measures is also shown in appendix “A”. The barriers will form an exclusion zone that will be regarded as sacrosanct. Vertical barriers will be installed as soon as the pre-development tree work is complete. Once erected the barriers should be regarded as sacrosanct and should not be removed or altered without approval from the LPA. The ground protection will protect the soil environment where construction workspace and temporary construction access is justified within the RPA, this should be facilitated by a set-back in the alignment of the tree protection barrier. This should be installed as soon as the pre-development tree work is complete.

3.7 The barriers should be fit for the purpose of excluding all construction activity. For this site the barrier should consist of 2m tall, welded mesh panels on rubber or concrete feet joined together using a minimum of two anti-tamper couplers, installed so they can only be removed from inside

the fence. The panels should be supported on the inner side by stabiliser struts, which would normally be attached to a base plate secured with ground pins (see Appendix "A"). All weather notices should be securely attached to the barrier with words such as "*Construction Exclusion Zone – KEEP OUT! Removing or moving these barriers may result in a breach of planning conditions*".

3.8 The ground protection should be fit for the purpose of pedestrian movements. For this site the ground protection should consist of a single thickness of scaffold boards placed either on top of a driven scaffold frame, so as to form a suspended walkway, or on top of a compression-resistant layer (e.g., 100mm depth of woodchip), laid on a geotextile membrane.

3.9 The primary concern for the protection of trees on this site is to protect, improve and maintain the micro-environment/root system and protect against physical damage.

3.10 ***Arboricultural Inspection*** (*Protection Measures*)

Once the protective barriers have been installed, prior to any other works taking place on site, all tree protective measures will be checked and approved in writing by the appointed arboricultural consultant and/or the Local Authority Tree Officer. Arrangements will be made at a convenient time for the arboricultural consultant and/or Local Authority Tree Officer to carry out an inspection of the site.



3.11 *Detail for Specification of Protective Barrier*

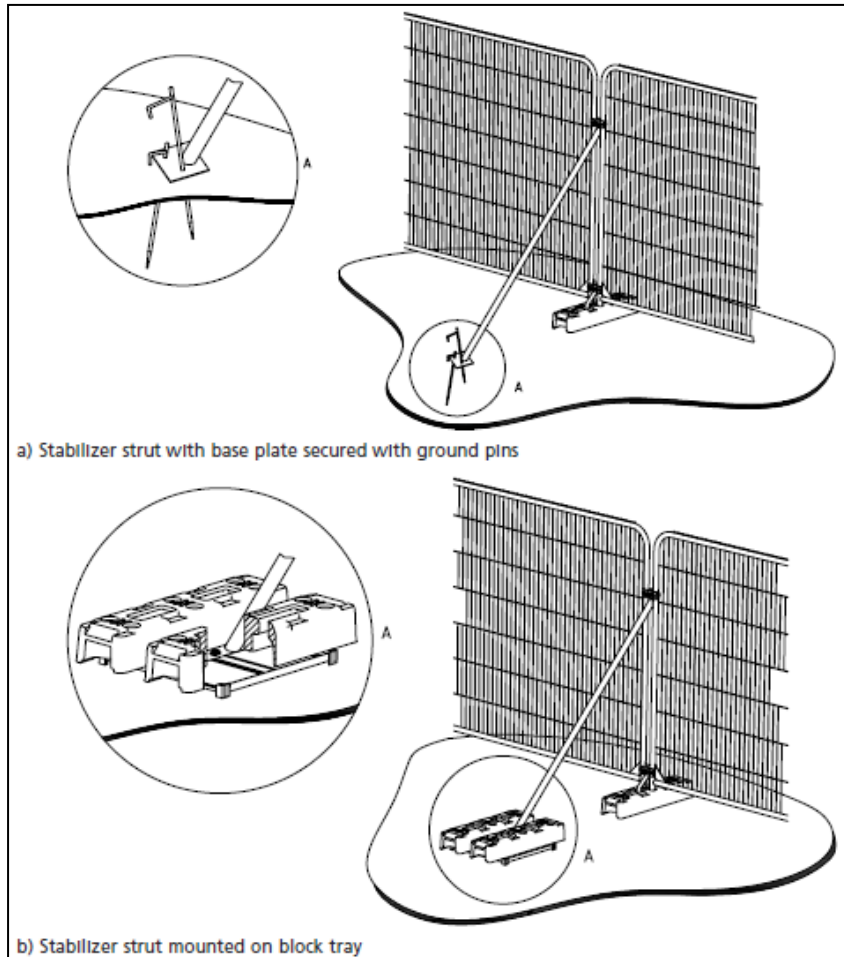

a) Stabilizer strut with base plate secured with ground pins

b) Stabilizer strut mounted on block tray

Image source: © The British Standards Institution - *BS 5837:2012 Trees in relation to design, demolition, and construction – Recommendations* – alternative specification for protective barrier

3.12 **Construction Phase**

Prior to works starting all site personnel including sub-contractors should be inducted in the requirements expected in order to ensure the future health of trees.

3.13 **Installation of Services**

When considering development for this site the installation of services must be kept as far as practically possible from the root protection area (RPA) of retained trees.

3.14 Trenching by conventional means, using a mechanical excavator, inevitably causes root loss, as the bucket easily rips through roots. For services such as foul, surface, electric, gas, BT etc., the most practical solution would be to run all services through one trench. Where encroachment into the RPA cannot be avoided trench-less techniques should be adopted. An alternative would be to hand dig a trench minimising the cutting of roots. Pipes and ducted cables can then be thread through enabling installation with very little damage, provided that the borehole is small and deeper than the main lateral roots.

3.15 In the UK, the usual guidelines for trenching by utility companies are provided by NJUG Volume 4 (previously NJUG10), which is available to download at <http://www.njug.org.uk/publications/>. By agreeing to the guidelines to be followed during trenching, all parties are assured that problems can be solved using a common set of criteria. Supervisors from the appointed contractor should direct operatives to follow the agreed practices and it is quite likely that the Local Authority Tree Officer will monitor for compliance.

3.16 **Main Site Construction Works**

Begin the main site works for the construction of six residential dwellings and associated infrastructure. The protective fencing and ground protection will preserve existing ground conditions, as detailed in the Protection Plan (see Appendix "A"). The protective fencing and ground protection should only be removed once all the construction works are complete.

3.17 **Construction Phase Complete**

Once all construction activity has finished on site the protective fencing and ground protection can be removed. Any post development landscape finishes should take into account existing trees and any deep cultivation within the RPA of the trees should be avoided.

3.18 Snagging

During construction activities, should there be a need for any variations to the scheme of tree protection and/or methods and techniques, whether planned or reactive, these variations shall be agreed in writing by the Local Authority Tree Officer.

3.19 During construction activities, in the event of incidents likely to result in the loss of trees that are to be retained then the site manager shall notify the appointed Arboricultural Consultant and LPA Tree Officer of the incident within 48 hours.

3.20 The protective measures will seal off the exclusion zone and preserve the existing ground conditions, as detailed in the Protection Plan (Appendix "A"). The protection measures should only be removed once all construction activities are complete.



4.0 KEY PERSONNEL

A list of the known contact details of the relevant parties is as follows:

Role	Name	Company
Client	James Pearson	Charworth Homes 82 Oswald Road, Scunthorpe, North Lincolnshire, DN15 7PA Email: James Pearson james.pearson@charworthhomes.co.uk
Agent	Lincs Design Consultancy Contact: Ricky Newton	Lincs Design Consultancy 12 Vickers Lane Louth Lincolnshire LN11 9PJ T: 01507 611155 M: 07920 265505 Email: ricky@lincsdesignconsultancy.co.uk
Arboricultural Consultant	Andrew Hudson	EQUANS Arboricultural Consultancy New Oxford House 2 George Street Grimsby North East Lincolnshire DN31 1HB Mob. +44 (0) 07919 304 536 Email. andrew.hudson@engie.com
Tree Officer – Local Authority North Lincolnshire Borough Council	Andrea Brocklebank	North Lincolnshire Council Environment Officer (Trees and Landscape) Transport, Highways and Environment Directorate of Operations North Lincolnshire Council. 01724 297000 Email: Andrea.Brocklebank@northlincs.gov.uk



5.0 SUMMARY AND PHASING OF WORK

Phased Project Management of Tree Issues Throughout Construction	
Action	Summary of Detail
<p>Pre-Development Tree Work – Prior to any construction activity taking place the recommended tree work should take place</p>	<p>As specified within this Arboricultural Method Statement - 'Schedule of Tree Work' pg. 6/7 (3.1-3.4) – Works to trees</p>
<p>Arboricultural Supervision – A pre-commencement meeting should be held on site before any of the site clearance, ground works and construction work begins</p>	<ul style="list-style-type: none"> • Inspection of pre-development tree works to ensure works have been carried out in accordance with the approved specification of works and has been carried out to the correct standards • Any additional tree works expected, outside of the approved specification of works will be agreed and recorded • All tree protection measures detailed in this method statement should be fully discussed so that all aspects of implementation and sequencing are understood by all the parties • The details of the programme of tree protection should be agreed and finalised • Any site supervision arrangements between the arboricultural consultant and developer should be agreed and finalised. Including any site visits deemed necessary, by a local planning authority ("LPA") representative
<p>Installation of Tree Protection Measures - Trees will be protected by barriers and ground protection as described in Appendix "A". The location of the barriers and ground protection is also shown in Appendix "A"</p>	<p>The barriers should be fit for the purpose of excluding all demolition/construction activity. Vertical barriers will be installed as soon as the pre-development tree work is complete. Ground protection should be fit for the purpose of pedestrian/vehicle movements and installed as soon as the pre-development tree work is complete. Once protection measures are installed, they should be regarded as sacrosanct and should not be removed or altered without approval from the LPA</p>
<p>Arboricultural Inspection – Tree Protection Measures</p>	<p>All tree protective measures will be checked and approved in writing by the appointed arboricultural consultant and/or the Local Authority Tree Officer.</p>
<p>Construction Phase – Once tree protective measures have been formally approved main site construction may begin</p>	<ul style="list-style-type: none"> • Any variation to tree protective measures needs to be formally agreed. • Any variation to methods/techniques, design/construction needs to be formally agreed. • Any incidents of tree loss during development needs to be reported within 48hrs. • Tree protective measures should be regarded as sacrosanct and should not be removed or altered without approval from the LPA.
<p>Construction Phase Complete</p>	<p>The tree protective measures can be removed. Post development landscape finishes should still consider the trees below ground constraints</p>

Appendix "A"

Tree Protection Plan

Tree Barriers:
Barriers should be fit for the purpose of excluding construction activity from the root protection (RPA) area of retained trees. The barriers should remain rigid and complete throughout the demolition/construction phase.

BS 5837: 2012 - Trees in Relation to Design, Demolition and Construction recommends the barrier type specification is commensurate to site circumstances and associated risk of damage within the RPA of retained trees.

Pre-development site inspection should be carried out by an arboriculturalist or Local Authority Tree Officer to ensure protective measures are to the correct specification and fit for purpose. The Local Planning Authority should be made aware of any amendments.

Tree protective barriers protect the RPA of retained trees. Any contamination into these areas such as chemical, petrol, diesel and oil spillage should be avoided. The mixing of cement and use of toxic materials should have a designated area well away from tree barriers

Temporary Ground Protection:

Ground protective measures should be capable of supporting any traffic/pedestrian entering or using the site without being distorted or causing compaction to the underlying soil. The objective should be to avoid compaction of the soil so that tree root functions remain unimpaired.

For pedestrian movements only, a single thickness of scaffold boards placed either on top of a driven scaffold frame, so as to form a suspended walkway, or on top of a compression-resistant layer (e.g. 100mm depth of woodchip), laid onto a geotextile membrane.

For pedestrian-operated plant up to a gross weight of 2t, proprietary, inter-linked ground protection boards placed on top of a compression-resistant layer (e.g. 150mm depth of woodchip), laid onto a geotextile membrane.

Barrier Specification

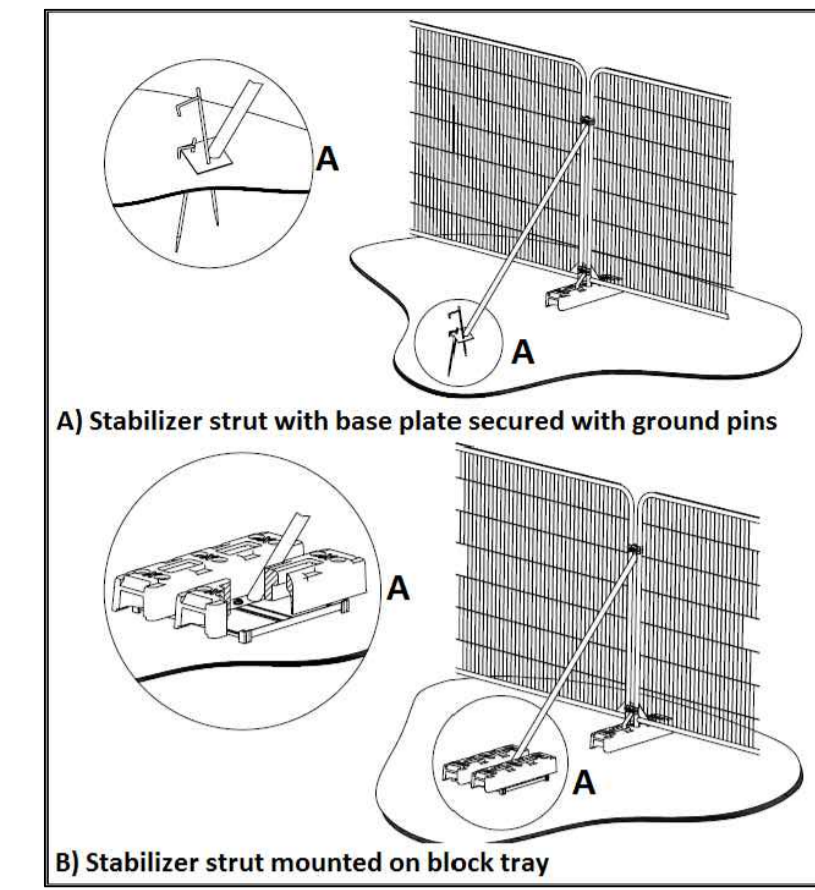

Ground Protection Specification

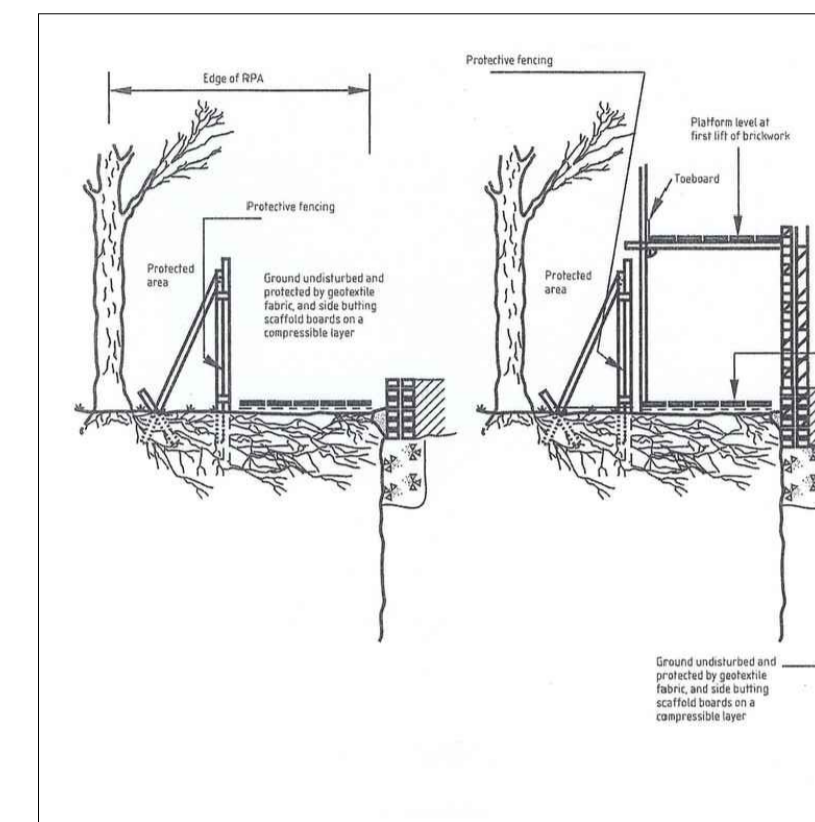

Barrier Position

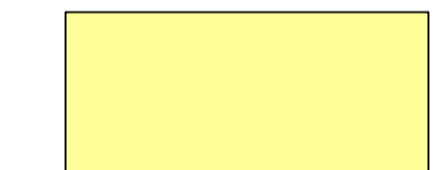

Ground Protection

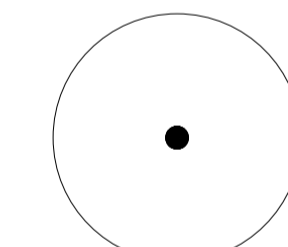

Root Protection Area

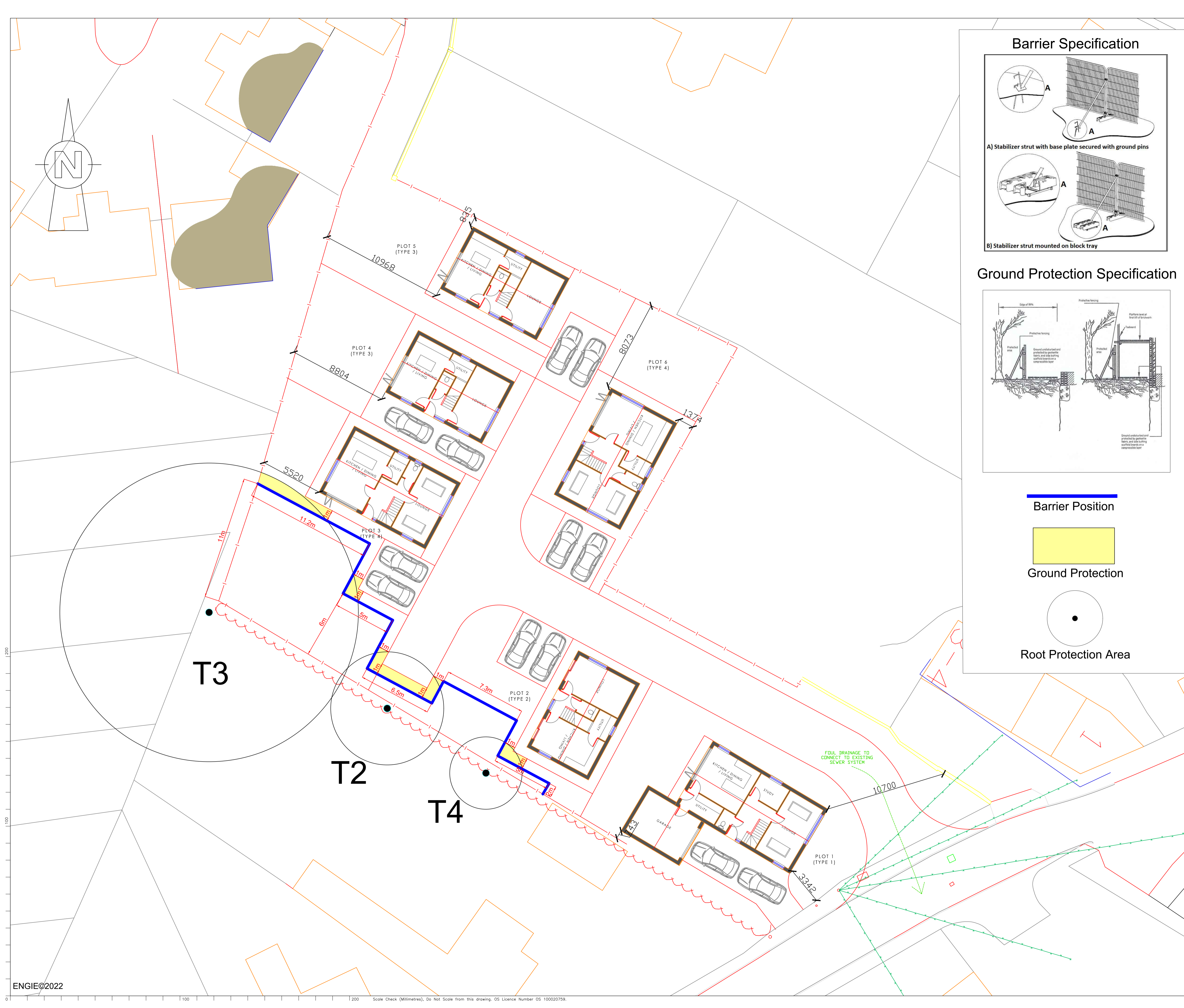

ARBORICULTURAL CONSULTANCY		
New Oxford House 2, George Street Grimsby North East Lincolnshire DN31 1HB Tel: 01472 324271		
CLIENT	Charworth Homes	
PROJECT	Residential Development land off Silver St, Barrow Upon Humber	
TITLE	Tree Protection Plan	
DRAWN	AH	CHECKED - APPROVED -
DATE	21st June 2022	ORIGINAL SIZE A1 (594 x 841) SCALE 1:150
FILE REF	AH-ENGIE	DRAWING No: TPP_03_210622 REVISION NO: RevNo.3