

AMENDED

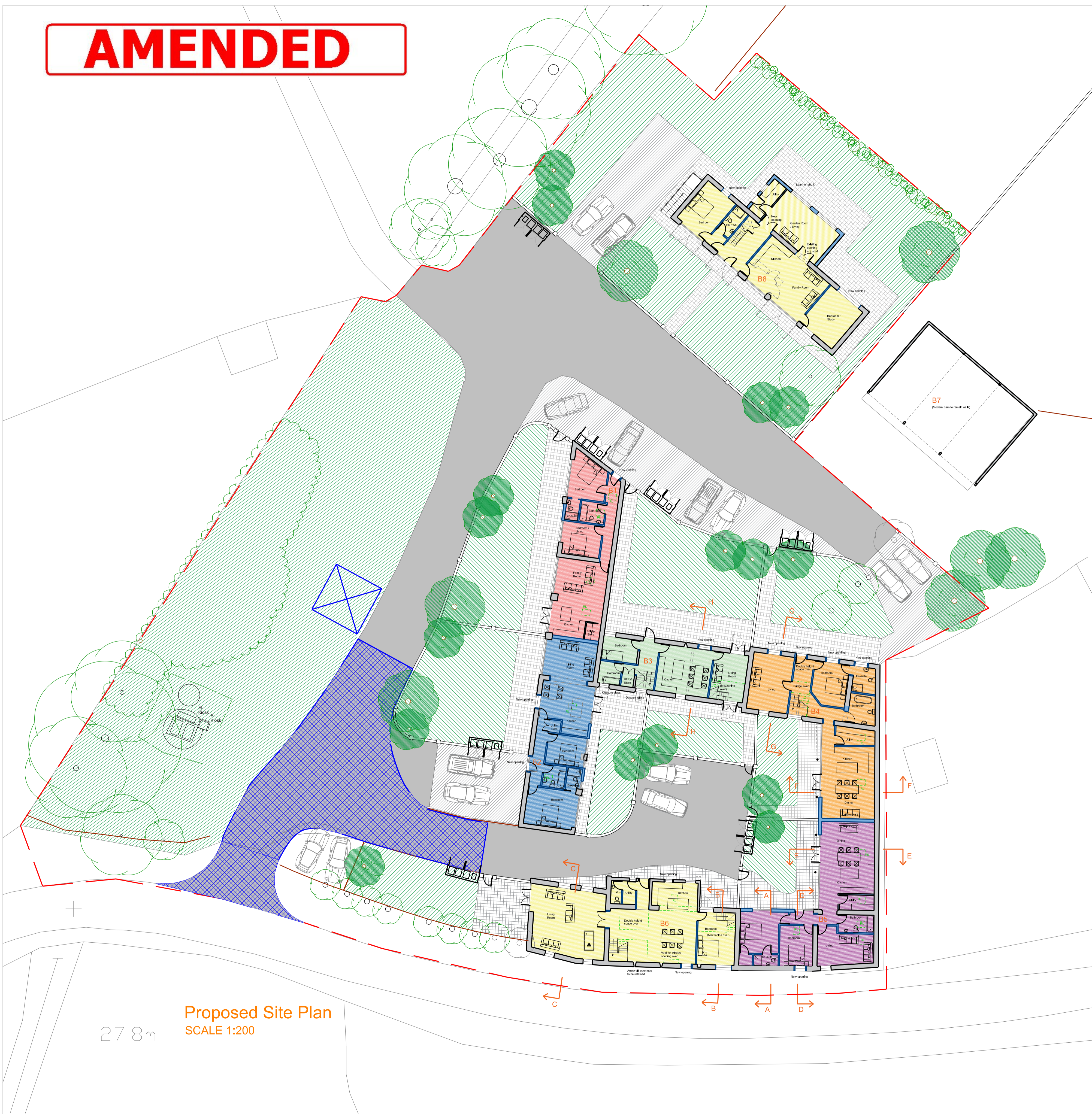

LEGEND

- = PROPOSED TREES. MIX OF: -
 1. Betula Fastigiata
 2. Prunus Amanogawa
 3. Malus Profusion
 4. Malus Red Sentinel
 5. Ulmus Golden Hornet
 6. Ulmus Fastigiata
 7. Catoneaster
- = EXISTING TREES
- = EXISTING TO REMOVE
- = NEW HEDGEROW
- = HARD PAVING
- = GRASS
- = GRAVEL - SHARED ACCESS
- = HIGHWAY - BLOCK PAVING TO ADOPTABLE STANDARDS
- = GRAVEL - PRIVATE DRIVE
- = NEW FACEBRICK WALL - 900mm HIGH
- = EXISTING TIMBER FENCE TO MAKE GOOD
- = PROPOSED TIMBER POST & RAIL FENCE
- BIN STORE (TO EACH PROPERTY).
To include space for : -
2-3 No. 38 litre boxes (stacked)
3 No. Food Waste bin: 240 litre (1070x580x730mm)
1800mm high. Timber frame & horizontal Cedar/Acoya cladding for stain finish.

Proposed Site Plan
SCALE 1:200

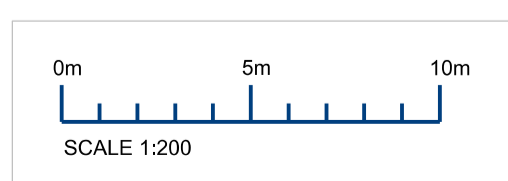

General Notes

NOTES: -

This drawing must NOT be scaled.

Work shall not commence until building regulation approvals have been obtained in full. Planning permission is not required

All dimensions and levels to be checked on site by contractor and any discrepancies to be reported to the architect and client prior to commencement of work on site.

This drawing is for building control purposes only. Detail design and specification shall be the sole responsibility of the contractor.

All drains & services to be located by contractor.

The Contractor is to allow for those items of work which are not specifically identified in the Contract Documents but which it is reasonable to expect an experienced contractor to identify from them as being necessary (such as but without prejudice to the foregoing - screws, noggins and support etc).

Amendments

Rev	Amendment	Date
B	Adopted road & bin detail added	14.11.22
A	Hedge added to northern boundary	26.09.22

ETTRIDGE ARCHITECTURE LTD

52-54 PRESTONGATE
HESSLE
EAST RIDING OF YORKSHIRE
HU13 0RE

Project:
Roxby Grange
North Street
Roxby

Client:
DDM

Drawing Title:
Proposed Site Plan

Compass: Phase: **PLANNING**

Drawn by: CN Checked by: DE

Drawing No: **22 41 1230 B** Scale: 1:200 @ A1 Date: August 2022