

Key:-

- 2.4mx70m visibility splay from priority junctions required by North Lincolnshire's Residential Road design guide for 30mph
- 2.4mx33m visibility splay from residential access roads required by North Lincolnshire's Residential Road design guide for 20mph
- 2.4mx43m visibility splay from priority junctions required by Manual For Streets for 30mph
- 2.4mx##m achievable visibility splay (distance as annotated)
- 2.4mx43m visibility splay from private drives
- - - Tangent visibility check to outside of bend

Disclaimers:-

- i. This drawing is copyright and must not be copied in part or in whole unless agreed in writing by Local Transport Projects Ltd.
- ii. Reference should be made to the project's drawing register to ensure the latest drawing is being referred to.
- iii. All dimensions are to be checked by the contractor prior to commencement of work. Any discrepancy shall be reported immediately to Local Transport Projects Ltd.
- iv. All work shall be carried out in accordance with local authority, statutory authority and health & safety requirements & regulations.
- v. This drawing is produced to be printed and read in colour. Reproduction in black and white may prevent correct interpretation of some aspects.
- vi. Based on Planning Layout Rev D provided by Client, received 27 07 23.

Rev.	Date	By	Chk	Description
D	16 08 23	JC	MR	Updated to new site layout XXXX-PL.PlanningLayout Barrow Road -REV I
C	08 08 23	JC	MR	Updated to new site layout XXXX-PL.PlanningLayout Barrow Road -REV H
B	10 02 23	OA	MR	Amended to match updated site layout provided by client 10 02 23.
A	09 02 23	OA	MR	Amended to match updated site layout provided by client 08 02 23.

Client
Strata

Project
Proposed Residential Development, Land to the South of A1077, Barton

Title
Junction Visibility Splays



Armstrong House,
The Flemingate Centre,
Beverley,
East Riding of Yorkshire.
HU17 0NW.

01482 679 911
info@ltp.co.uk
www.local-transport-projects.co.uk
Registered No. 5295328

Drawn	OA	Date	19 01 23
Scale	1 : 1000	Checked	AC
Status		Approved	SW

SITE TESTING

Drawing number				
Project	Job	Drawing	Sheet	Revision
LTP/5136/P1	/	01	01	D

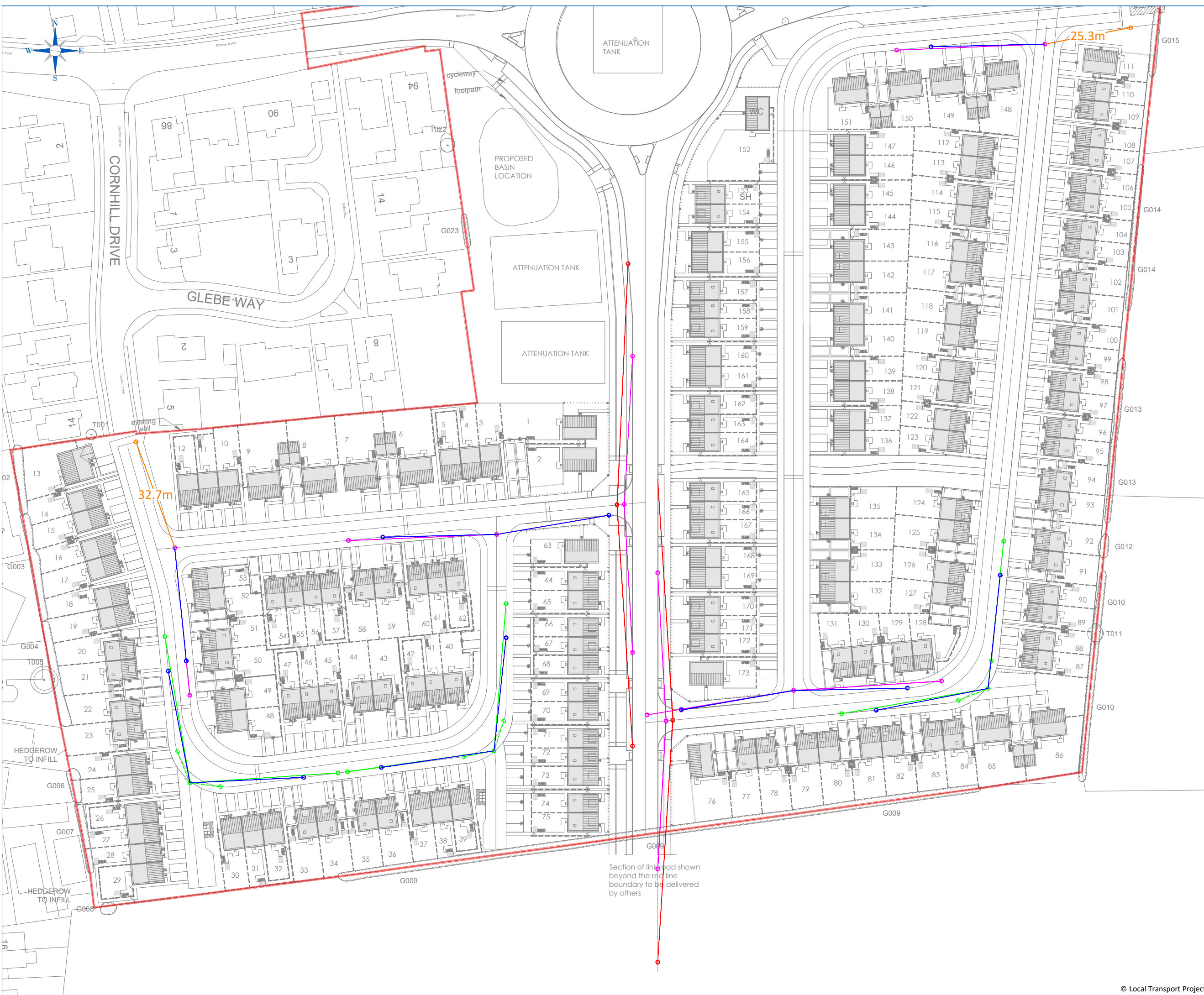

Section of link road shown beyond the red line boundary to be delivered by others