

**Mark S Feather** BSc M Arb (RFS) Tech Arbor A MICFor

Arboricultural, Woodland and Landscape Consultant

10 Grosvenor Place, Beverley, East Yorkshire HU17 8LY (01482 871064)

---

## **Arboricultural Report**

Ings Lane  
Hinaldstow  
North Lincolnshire

May 2024

### **Client**

Ongo Homes Ltd  
26-30 High Street  
Scunthorpe  
North Lincolnshire  
DN15 6AT

**Contents**

---

<b>1.0</b>	<b>Introduction</b>	<b>3</b>
<b>2.0</b>	<b>Site Plans – (Plan 1A &amp; 2A)</b>	<b>4</b>
<b>3.0</b>	<b>Survey Methodology and Schedule</b>	<b>6</b>
<b>4.0</b>	<b>Arboricultural Implications Assessment (Plan 2A)</b>	<b>8</b>
<b>5.0</b>	<b>Tree Protection Measures (Plan 3A)</b>	<b>11</b>
<b>6.0</b>	<b>Arboricultural Method Statement</b>	<b>12</b>
<b>7.0</b>	<b>Appendix A - Tree Protection Details</b>	<b>13</b>

## 1.0 INTRODUCTION

- 1.1 This report provides information in accordance with British Standard 5837:2012 'Trees in Relation to Design, Demolition and Construction' for a proposed development on land at Ings Lane, Hibaldstow, North Lincolnshire. The development proposals are for the construction of residential properties.
- 1.2 The arboricultural survey was commissioned by BSB Architecture and is linked to the design work undertaken by them as architect for the site. The aims of the survey were to undertake an assessment of all the existing trees within proximity of the proposed development, including trees on adjacent land.
- 1.3 The following information has been recorded in accordance with BS 5837:2012:-
- Designated tree number.
  - Tree Species – the common name has been given followed by the Latin or scientific name.
  - Height.
  - Stem or base (multi stemmed trees) diameter and root protection area.
  - Crown clearance (height of the periphery of the crown spread above ground level).
  - Branch spread (to N, S, E, and W).
  - Age class. This is given as young (Y), mature (M), and over mature (OM).
  - Physiological condition - general comments given only, poor, fair, good.
  - Tree structural condition - general comments given only, poor, fair, good.
  - Useful life expectancy.
  - Preliminary management recommendations.
  - Tree category (A, B, C or U).

## 2.0 SITE PLANS

### 2.1 Location Plan (Plan 1A)



## 2.2 Tree Survey - Plan 1B

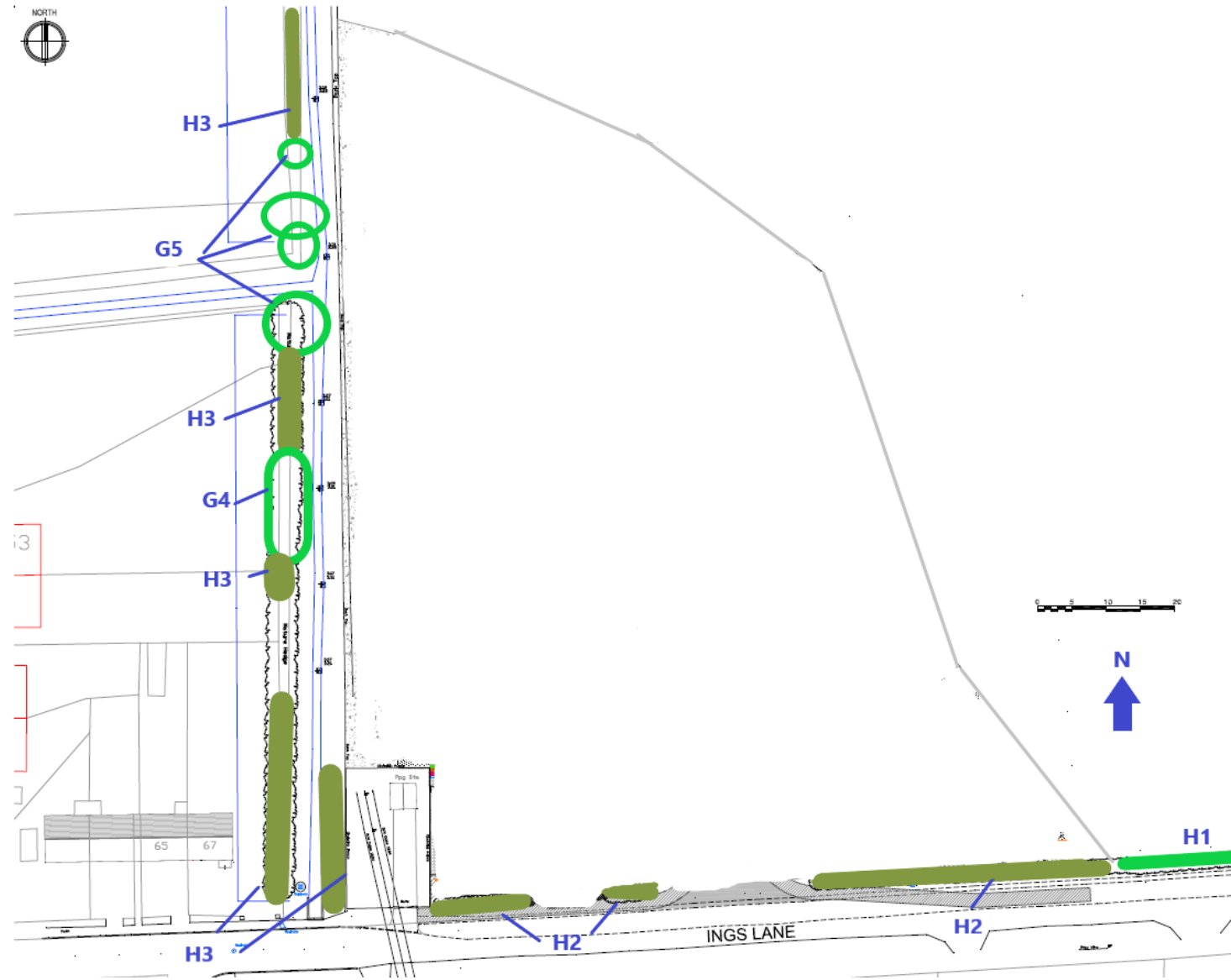

### 3.0 SURVEY METHODOLOGY AND SCHEDULE

- 3.1 The survey was carried out to British Standard 5837:2012, using the categories explained below:
- 3.2 The trees were assessed visually from ground level. Where potential problems were identified, further inspection by tree climbing is recommended. No digging or drilling methods were employed during this survey.
- 3.3 The trees were not given number tags.
- 3.4 The approximate height of each tree is measured from ground level to top of canopy using a clinometer.
- 3.5 The approximate diameter of each tree is measured at 1.5m above ground level. The root protection distance which has been expressed as a radius from the trunk of the tree has been given below the diameter measurement.
- 3.6 The age of each tree is based upon experience (Y= young. MA = middle aged. M= mature. OM=over mature).
- 3.7 The physiological condition of the trees is based upon experience (Good, Fair, Poor, Dead).
- 3.8 The structural condition and description is also based on experience (Good, Fair, Poor).
- 3.9 Both the approximate expected lifespan remaining and category/rating of each tree is based on the surveyor's experience.
- 3.10 The retention category of each tree or group of trees is based upon the information detailed above using the following categories:
  - A Trees of high quality and value
  - B Trees of moderate quality and value
  - C Trees of low quality and value
  - U Trees to be removed for arboricultural reasons
- 3.11 The following subcategories have been used in rating tree value
  - 1 Mainly arboricultural qualities
  - 2 Mainly landscape qualities
  - 3 Mainly cultural values, including conservation

### 3.12 Tree Schedule

Note - The root protection areas (RPA) are listed as a radius in metres, below the stem diameter in the schedule below.

Tree no	Species	Height	Stem Dia RPA	Branch Spread	Crown Height	Age Glass	Physiological Condition	Structural Condition	Preliminary Management Recommendations	Useful life Expectancy	Category Grading
H1	Hawthorn	2m	200e 2.4m	1m	-	M	Good	Good	No action  Hedge on adjacent land	40+	C2
H2	Hawthorn Hedge	6m	200e 2.4m	2m	-	M	Good	Good	No. Action  Mainly hawthorn with odd rose, elderberry and ash.	40+	C2
H3	Hawthorn Hedge	8m	300e 3.6m	2m	-	M	Good	Good	Mo action  Mainly hawthorn hedge adjacent to the Dyke – On adjacent land	40+	C2
G4	Leyland cypresses	16m	300e 3.6m	3m	1m	M	Good	Good	No action  Trees on adjacent land	40+	C2
G5	Mature Ash	20m	300 to 800e 9.6m	-	-	M	Good	Good	No action  Trees on adjacent land Mixed ash trees adjacent to dyke	-	C2

## 4.0 ARBORICULTURAL IMPLICATIONS ASSESSMENT

### 4.1 Proposed Layout Plan – 2A

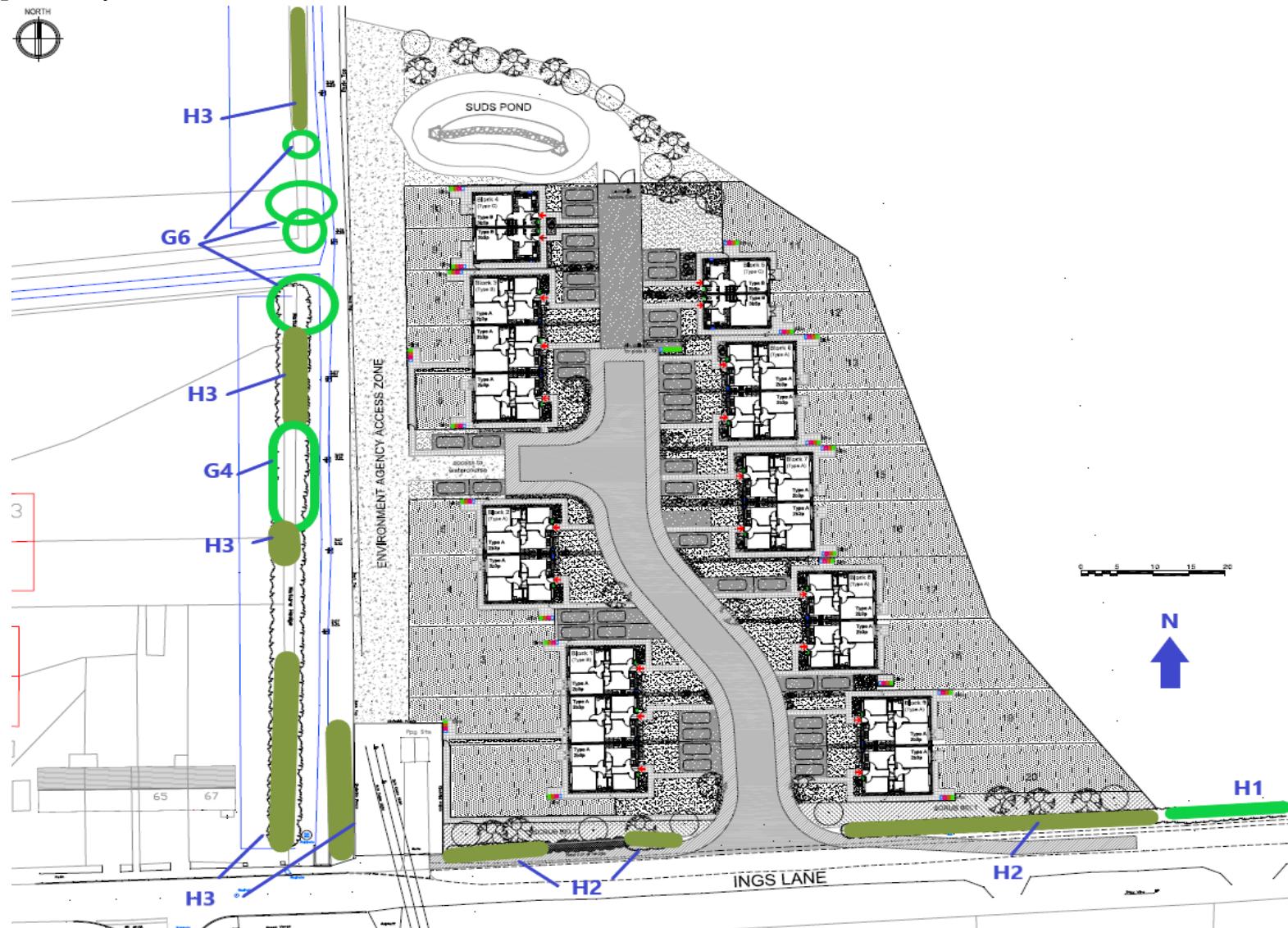

## 4.2 General Comments

The proposed development seeks to retain the existing hedge (H2) on the frontage of the site as illustrated in the photograph below.

Mature hawthorn hedging and trees exist adjacent to the dyke on the western boundary of the site. However, these trees are separated from the development by an earth mound alongside the dyke and the dyke itself. The trees and hedging would be therefore unaffected by the development. They will however provide a backcloth of trees to the development.



**Photograph 1 - Boundary Hedge H2**

### **4.3 Hedge Protection Measures**

Tree protection fencing is recommended to protect the hedging during the development. Details are provided on the Tree Protection Plan (3A) and in appendix A.

### **4.4 Future Relationship with Trees**

The properties are located a comfortable distance from the hedges and trees to be retained and they would have no significant adverse impact on the proposed properties.

### **4.5 Construction and Storage Space**

Adequate space exists for construction work and for the supply and storage of materials utilising the drive and lawn areas.

## 5.0 TREE PROTECTION MEASURES (Plan 3A)



## **6.0 ARBORICULTURAL METHOD STATEMENT (AMS)**

### **6.1 General Site Management Constraints**

- No specific site constraints.

### **6.2 Local Planning Authority Meeting**

- The Local Planning Authority to be notified not less than 72 hours prior to commencement of works on site.

### **6.3 Tree and Hedge Removal**

- No trees or hedging to be removed.

### **6.4 Hedge Protection**

Tree Protection Fencing to be provided as indicated on the Tree Protection Plan (plan 3A) with details of the fencing illustrated in appendix A.

### **6.5 Construction Work**

- Once the hedge protection fencing has been erected construction work can commence.
- Services for the properties to be located outside the root protection areas for the hedge to be retained. See architects drawings for further details.

## Appendix A – Tree Protection Details

Extract from BS5837

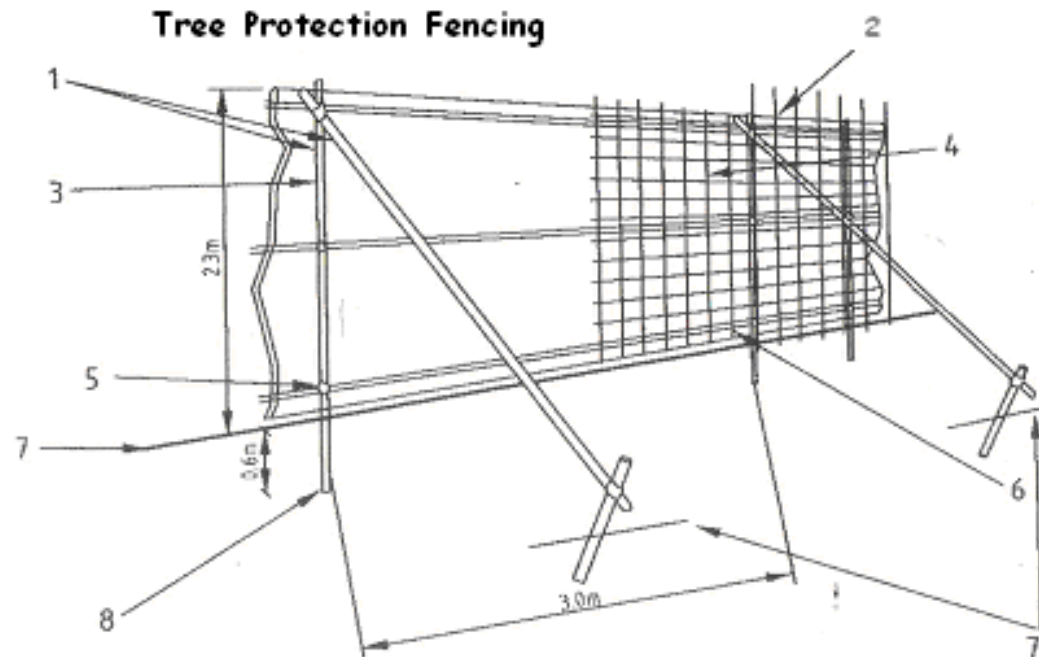

- 1) Standard Scaffold Poles
- 2) Uprights to be driven into the ground
- 3) Panels secured to uprights with wire ties
- 4) Weldmesh
- 5) Standard clamps
- 6) Wire twisted and secured on inside of fence
- 7) Ground level
- 8) Approx 0.6m into the ground

