

Existing Site Plan @ 1:200

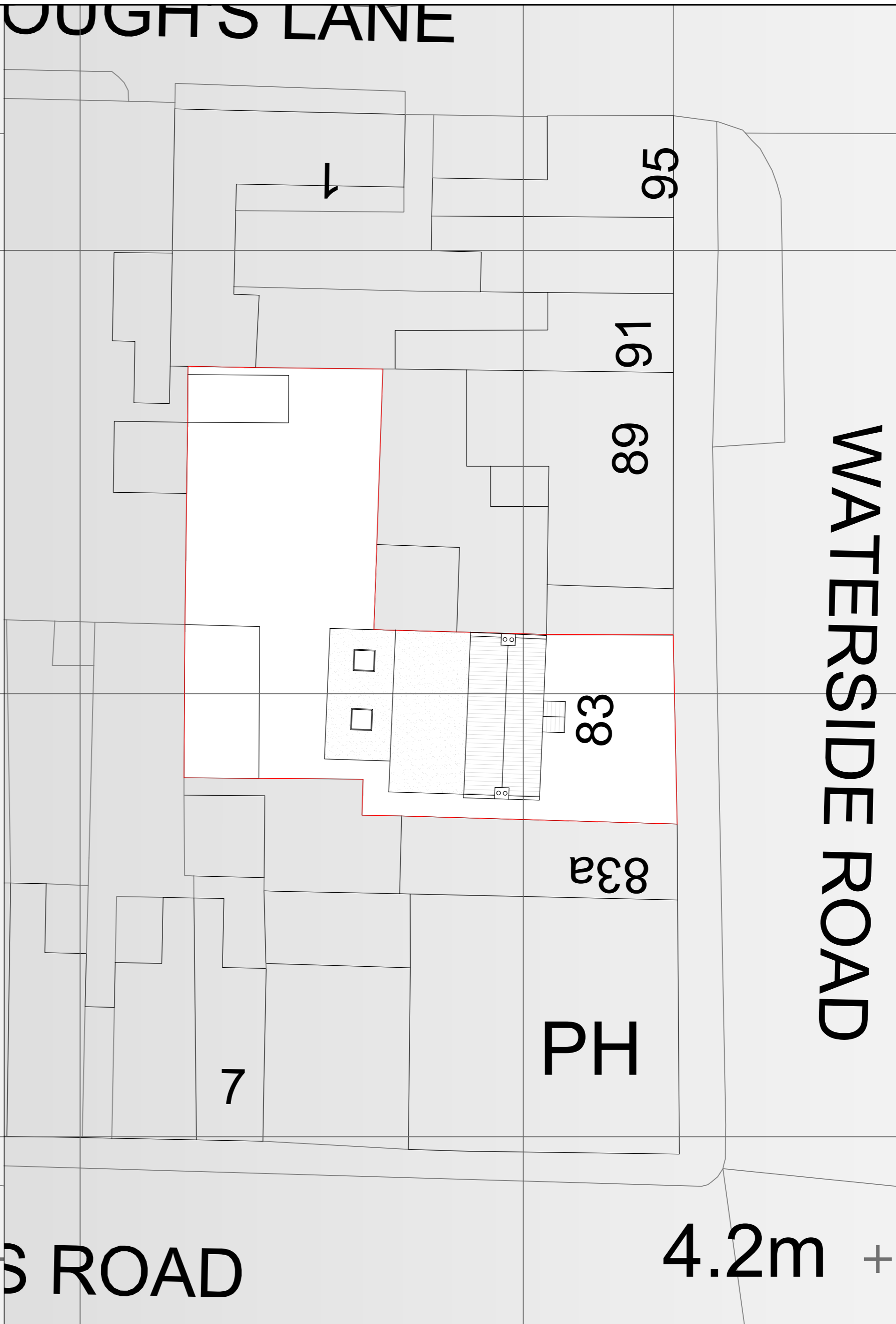

Proposed Site Plan @ 1:200

NOTES

Do NOT scale from this drawing. Use dimensions illustrated only. All dimensions and levels are in millimeters. All dimensions and levels shall be verified onsite before proceeding with works.

PLANNING  
DRAWINGS

Rev	Date	Description	Chk'd



22 Low Road, Worlaby, North Lincs, DN20 0LX  
 Mobile : 07841013033  
 Email : peter@y6architectural.co.uk

Drawing Status:  
 PLANNING

Project Title:  
 Ginny Lowe, 83, Waterside Road, Barton  
 DN18 5BA

Drawing Title:  
 Existing and Proposed Site Plan

Drawn: PRM Date: 03/10/2024

Scale: 1:200 Plot A1: A2

Project No: 083-001	Drawing No: 002	Rev: 00
------------------------	--------------------	------------