

- Notes:
1. This drawing is to be read in conjunction with all other relevant engineering, architectural and structural drawings.
 2. Drawings not to be scaled. All dimensions to be checked on site by the builder. Any discrepancies to be notified to the building designer and further instruction obtained before work is commenced.
 3. The structure is designed to be self-supporting and stable after the construction phase is complete. It is the responsibility of the builder to determine the construction procedure and sequence and ensure that the building and its components are safe during construction. This includes and temporary works or bracing which may be necessary.
 4. This drawing represents a detailed dimensional measurement survey of the physical dimensions or the existing property. This drawing does not and is not intended to express any opinion on the physical, superficial, or structural condition of the premises depicted.
 5. This drawing is to be read in conjunction with all other drawings and building regulation specifications.

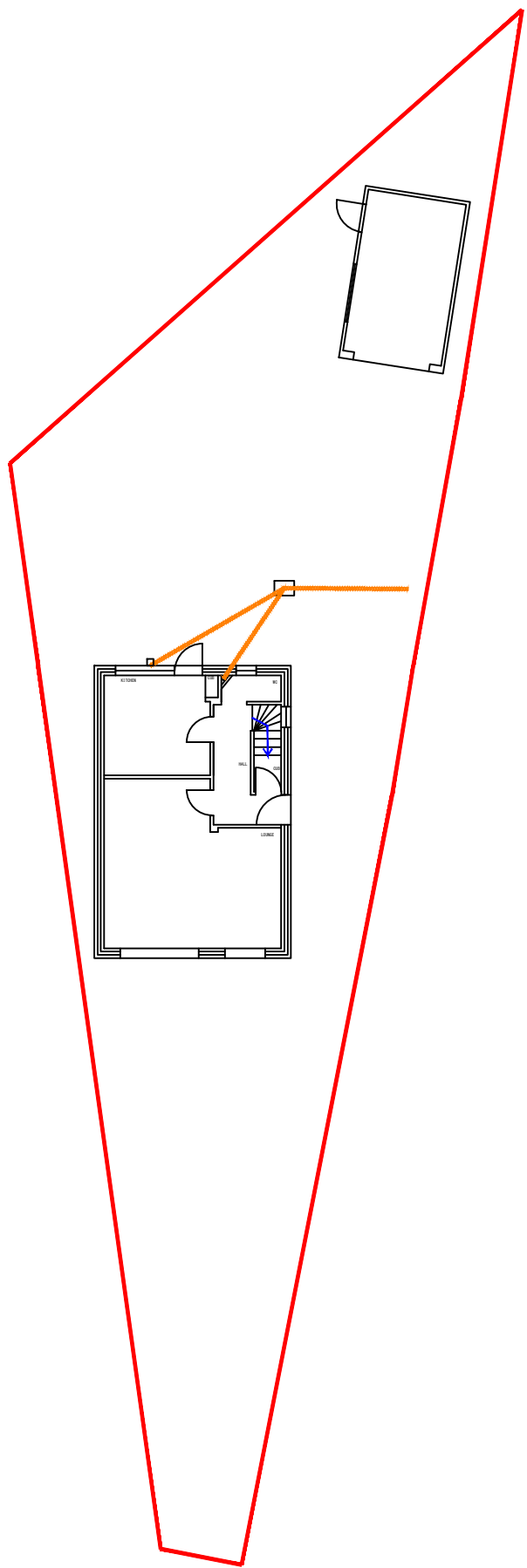
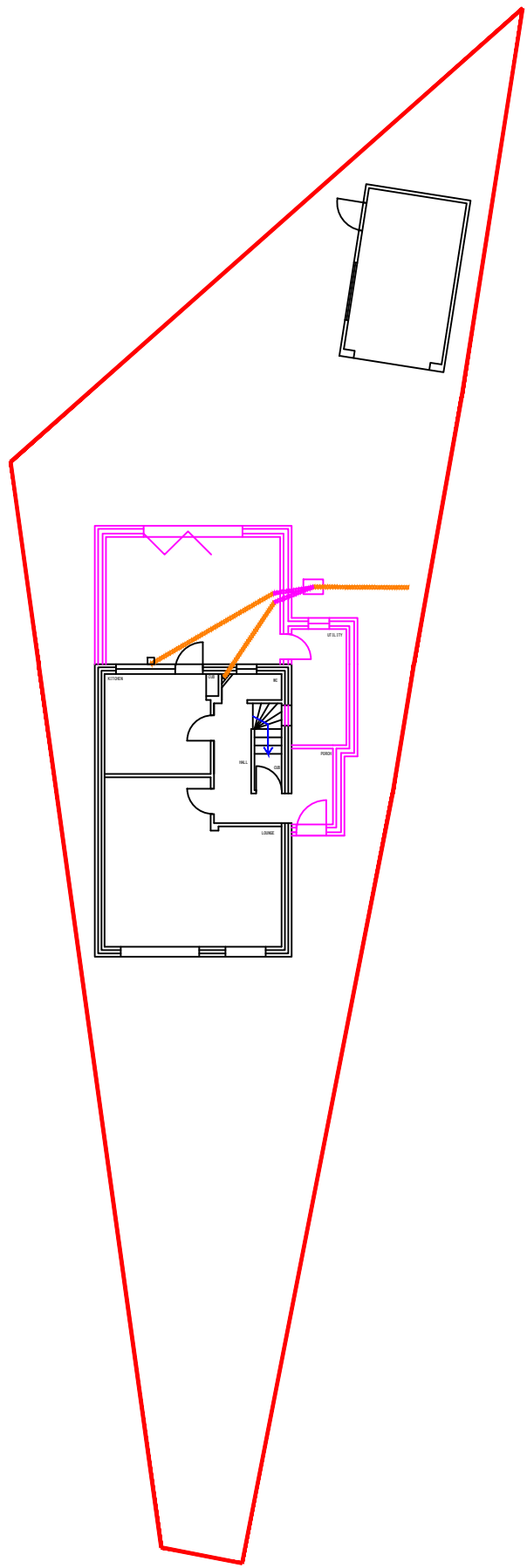

No.	Description	Date
1	First Issue	16/03/24

JET CIVILS
 07555 174405
 SIMON@JETCIVILS.CO.UK

Client:
TBC

Project:
12a Stuart Close
Scunthorpe
DN17 2RL

Title:
Site Plan

Drawn By: S Quibell	Date: 16/03/24
Job No: 5Q/008	Scale: 1:200
Drawing No: 007	Rev: P1
	Sheet Size: A3