

PLASTIC CHAMBERS AND RINGS SHALL COMPLY WITH BS EN 13598-1 AND BS EN 13598-2 OR HAVE EQUIVALENT INDEPENDENT APPROVAL

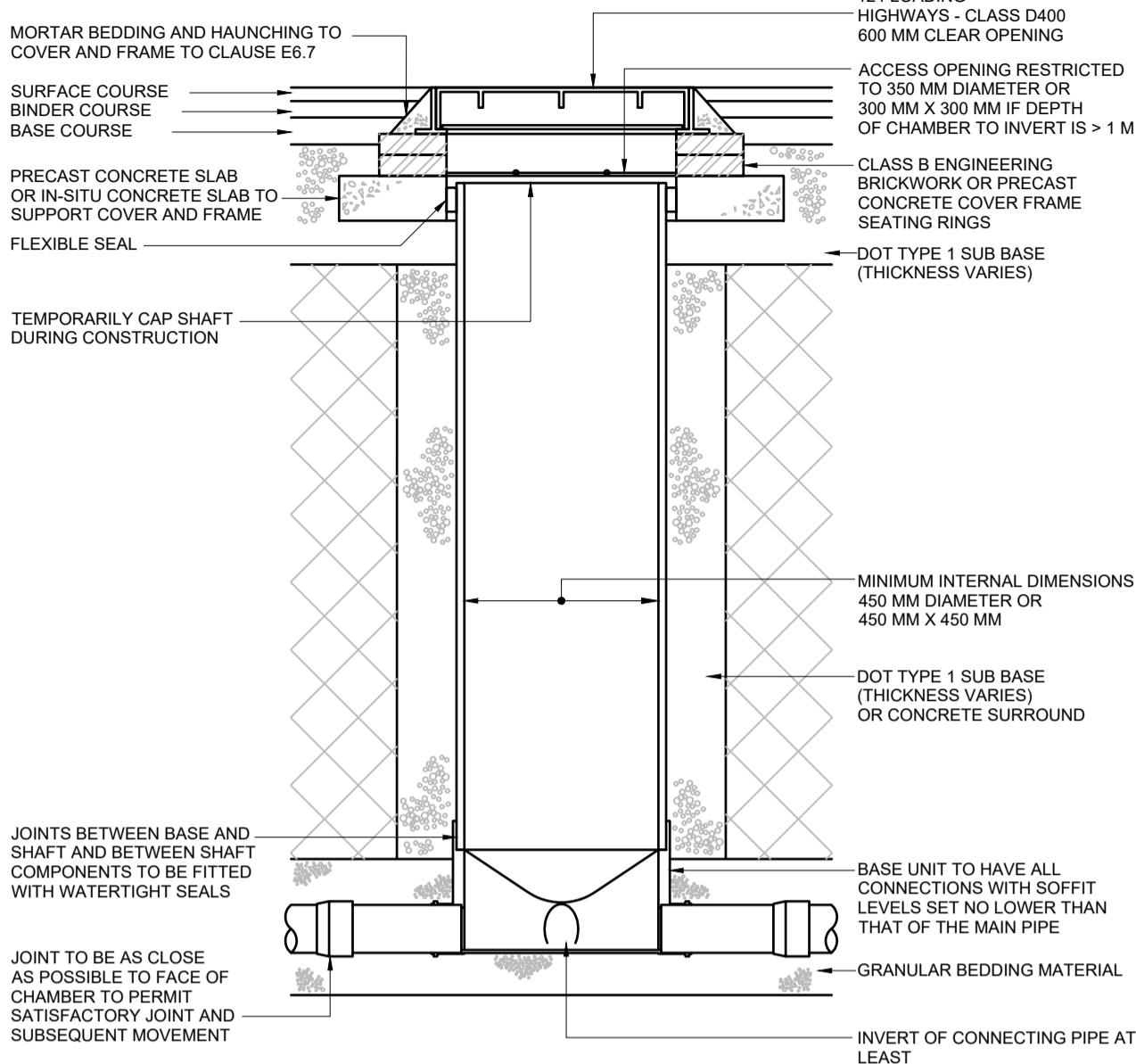

FIGURE B.16
TYPICAL INSPECTION CHAMBER DETAIL - TYPE 3
(FLEXIBLE MATERIAL DETAIL)
MAXIMUM DEPTH FROM COVER LEVEL TO SOFFIT OF PIPE IN AREAS SUBJECT TO VEHICLE LOADING 3 M, NON-ENTRY NTS

PLASTIC CHAMBERS AND RINGS SHALL COMPLY WITH BS EN 13598-1 AND BS EN 13598-2 OR HAVE EQUIVALENT INDEPENDENT APPROVAL

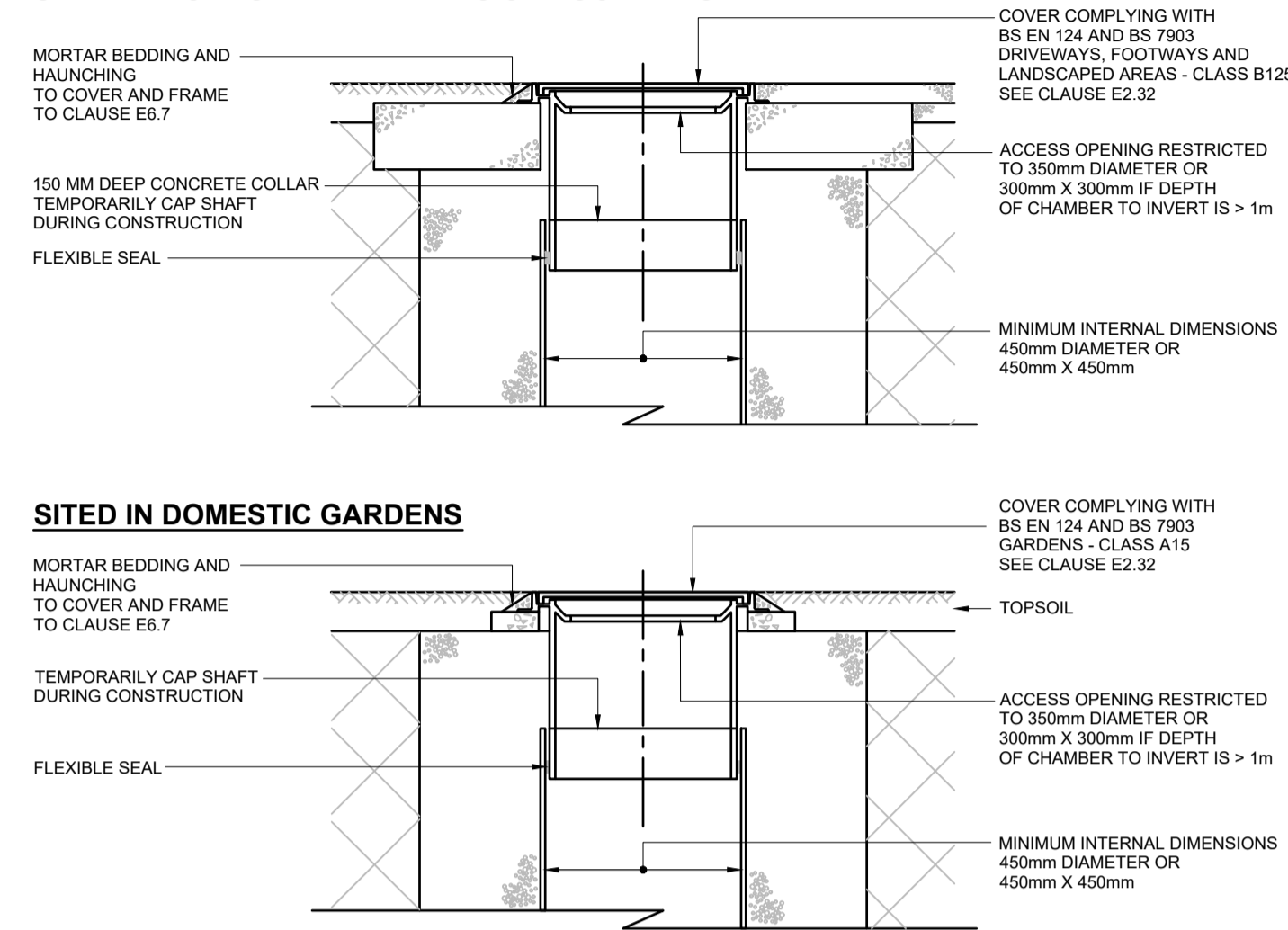
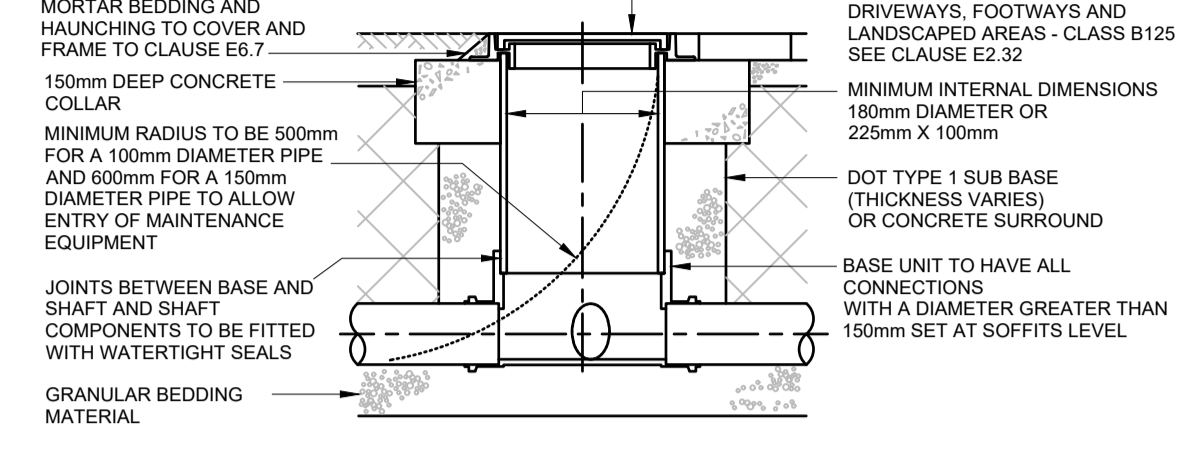
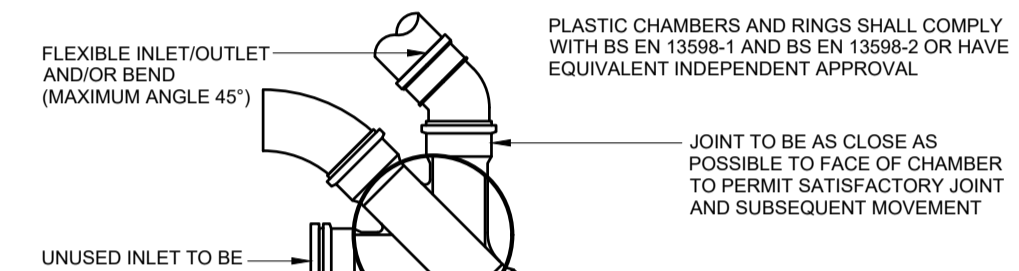
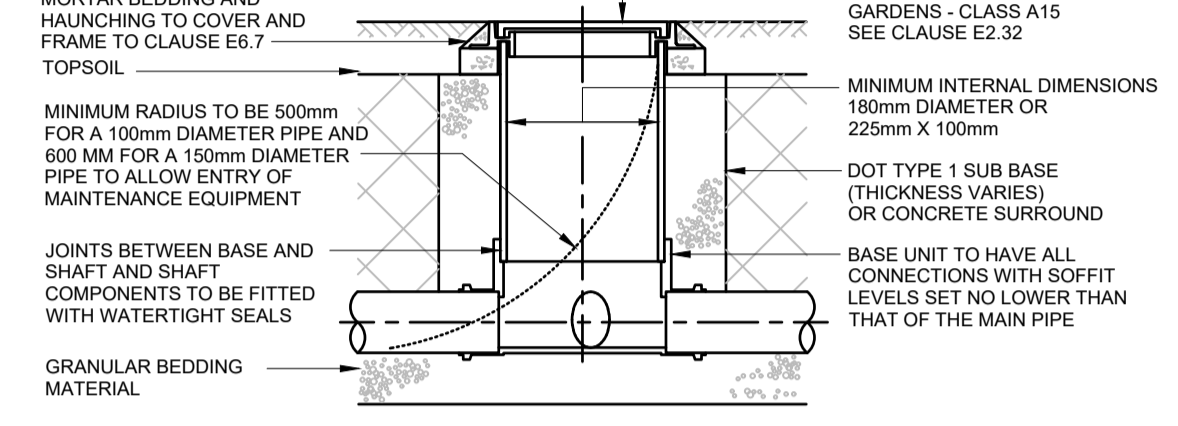

FIGURE B.17
ALTERNATIVE TOP DETAILS FOR LIGHT VEHICLE LOADING AND LANDSCAPED AREAS - TYPE 3
NTS

SITED IN DRIVEWAYS/PAVED AREAS



SITED IN DOMESTIC GARDENS



NOTE: WHERE THE ACCESS CHAMBER IS IN THE HIGHWAY THE HIGHWAY AUTHORITY CAN HAVE SPECIFIC REQUIREMENTS

FIGURE B.21
TYPICAL INSPECTION CHAMBER DETAIL TYPE 4 (FLEXIBLE MATERIAL DETAIL)
MAXIMUM DEPTH FROM COVER LEVEL TO SOFFIT OF PIPE 2, NON-ENTRY NTS

NOTES
CONTRACTORS MUST VERIFY ALL DIMENSIONS ON SITE BEFORE COMMENCING ANY WORK ON SHOP DRAWINGS
DO NOT SCALE FROM THIS DRAWING
RCD CONSULTANTS LTD COPYRIGHT

- NOTES**
- 1) ALL BUILDING DRAINAGE TO BE INSTALLED AND TESTED IN COMPLIANCE WITH THE BUILDING REGULATIONS 2000 DRAINAGE AND WASTE DISPOSAL APPROVED DOCUMENT H 2002 EDITION.
 - 2) ALL COMPONENTS AND MATERIALS ARE TO BE MANUFACTURED AND SUPPLIED IN ACCORDANCE WITH THE RELEVANT BRITISH STANDARDS, AND LAID AND BACKFILLED IN ACCORDANCE WITH MANUFACTURERS INSTRUCTIONS AND THE RELEVANT BRITISH STANDARDS.
 - 3) THE CONTRACTOR SHALL, BEFORE COMMENCING THE WORKS, VERIFY ALL SITE AND SETTING OUT DIMENSIONS. THE CONTRACTOR SHALL BE RESPONSIBLE FOR THE TRUE AND PROPER SETTING OUT OF THE WORKS AND FOR THE CORRECTNESS OF THE POSITION, LEVELS, DIMENSIONS, AND ALIGNMENT OF ALL PARTS OF THE WORKS.
 - 4) SMALL LIGHTWEIGHT ACCESS COVERS SHOULD BE SECURED (FOR EXAMPLE WITH SCREWS) TO DETER UNAUTHORISED ACCESS.
 - 5) INSPECTION CHAMBERS AND MANHOLES IN BUILDINGS TO HAVE MECHANICALLY FIXED AIRTIGHT COVERS UNLESS THE DRAIN ITSELF HAS WATER TIGHT ACCESS COVERS.
 - 6) MANHOLES DEEPER THAN 1m TO HAVE GALVANISED STEEL STEP IRONS OR FIXED LADDERS.
 - 7) ALL ABOVE GROUND DRAINAGE TO INCORPORATE RODDING ACCESS FACILITIES.
 - 8) IN SITU CONCRETE FOR USE IN GENERAL DRAINAGE WORKS, GRADE TO BS: 5328. USE AS FOLLOWS:

CLASS 1 SULFATE CONDITIONS:	
ADAPTABLE STANDARD WORKS AND AREAS SUBJECT TO HEAVY LOADING	GEN 3 or ST4
AREAS SUBJECT TO LIGHT LOADING eg. HOUSING AND PRIVATE DRIVES, SMALL CAR PARKS.	GEN1 or ST2
FOR BURIED CONCRETE EXPOSED TO OTHER SULFATE CONDITIONS:	
CLASS 2	FND 2
CLASS 3	FND 3
CLASS 4A	FND 4A
CLASS 4B	FND 4B

TYPE OF ACCESS	DEPTH TO INVERT FROM COVER LEVEL (m)	MINIMUM INTERNAL DIMENSIONS (1)		MINIMUM CLEAR OPENING SIZE (2)	
		LENGTH x WIDTH (mm x mm)	CIRCULAR (mm)	LENGTH x WIDTH (mm x mm)	CIRCULAR (mm)
RODDING EYE	-	AS DRAIN BUT MINIMUM 100mm	-	-	SAME SIZE AS PIPEWORK
ACCESS FITTING SMALL 150mm DIA. SMALL 150x100mm LARGE 225x100mm	0.6m OR LESS EXCEPT WHERE SITUATED IN A CHAMBER	150 x 100 225 x 100	150 225	150 x 100 (1) 225 x 100 (1)	SAME SIZE AS ACCESS FITTING
INSPECTION CHAMBER					
SHALLOW	0.6m OR LESS	225 x 100	190 (2)		190 (1)
MEDIUM	1.2m OR LESS	450 x 450	450	MIN 430 x 430	430
DEEP	GREATER THAN 1.2m	450 x 450	450	MAX 300 x 300 (3)	ACCESS RESTRICTED TO MAX 350 (3)

NOTES:
(1) THE CLEAR OPENING MAY BE REDUCED BY 20mm IN ORDER TO PROVIDE PROPER SUPPORT FOR THE COVER AND FRAME.
(2) DRAINS UP TO 150mm DIAMETER.
(3) A LARGER CLEAR OPENING COVER MAY BE USED IN CONJUNCTION WITH A RESTRICTED ACCESS. THE SIZE IS RESTRICTED FOR HEALTH AND SAFETY REASONS TO DETER ENTRY.

TYPE OF ACCESS	SIZE OF LARGEST PIPE (DN)	MINIMUM INTERNAL DIMENSIONS (1)		MINIMUM CLEAR OPENING SIZE (2)	
		RECTANGULAR LENGTH x WIDTH (mm x mm)	CIRCULAR DIAMETER (mm)	RECTANGULAR LENGTH x WIDTH (mm x mm)	CIRCULAR DIAMETER (mm)
MANHOLE LESS THAN 1.5m DEEP TO SOFFIT	LESS THAN OR EQUAL TO 150	750 x 675 (7)	1000 (7)	750 x 675 (2)	N/A (3)
	225	1200 x 675	1200	1200 x 675 (2)	
	300	1200 x 750	1200		
MANHOLE GREATER THAN 1.5m DEEP TO SOFFIT	GREATER THAN 300	1800 x (DN+450)	THE LARGER OF 1800 or (DN+450)		
	LESS THAN OR EQUAL TO 225	1200 x 1000	1200	675 x 675	675
	300	1200 x 1075	1200		
MANHOLE SHAFT (4) GREATER THAN 3.0m DEEP TO SOFFIT OF PIPE	375-450	1350 x 1225	1200		
	GREATER THAN 450	1800 x (DN+775)	THE LARGER OF 1800 or (DN+775)		
	STEPS (5)	1050 x 800	1050	675 x 675	675
	LADDER (5)	1200 x 800	1200		
	WINCH (6)	900 x 800	900		

NOTES:
(1) LARGER SIZES MAY BE REQUIRED FOR MANHOLES ON BENDS OR WHERE THERE ARE JUNCTIONS.
(2) MAY BE REDUCED TO 600x600mm WHERE REQUIRED BY HIGHWAY LOADING CONSIDERATIONS. SUBJECT TO A SAFE SYSTEM OF WORK BEING SPECIFIED.
(3) NOT APPLICABLE DUE TO WORKING SPACE NEEDED.
(4) MINIMUM HEIGHT OF CHAMBER IN SHAFTED MANHOLE 2m FROM BENCHING TO UNDERSIDE OF REDUCING SLAB.
(5) MINIMUM CLEAR SPACE BETWEEN LADDER OR STEPS AND THE OPPOSITE FACE OF THE SHAFT SHOULD BE APPROXIMATELY 900mm.
(6) WINCH ONLY - NO STEPS OR LADDERS, PERMANENT OR REMOVABLE.
(7) THE MINIMUM SIZE OF ANY MANHOLE SERVING A SEWER (i.e. ANY DRAIN SERVING MORE THAN ONE PROPERTY) SHOULD BE 1200x1500mm RECTANGULAR OR 1200mm DIAMETER.

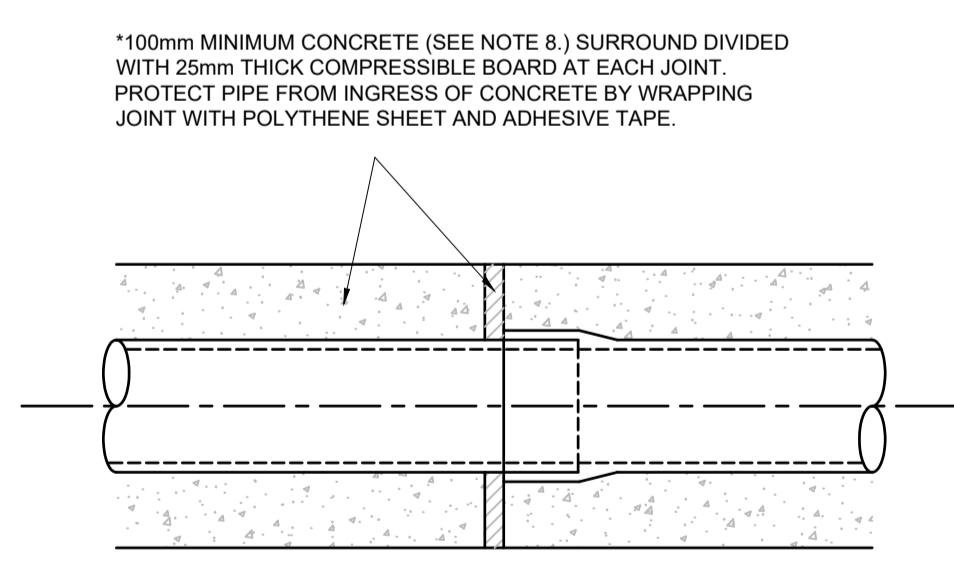

SIDE ELEVATION
CROSS SECTION
TYPE Z BEDDING (CONCRETE ENCASED PIPES) FOR PIPES WITH LESS THAN 1.2m COVER
NOT TO SCALE

* FOR HEAVY DUTY/INDUSTRIAL APPLICATIONS INCLUDING MAIN ROADS OR ADAPTABLE ROADS INCREASE CONCRETE TO 150mm

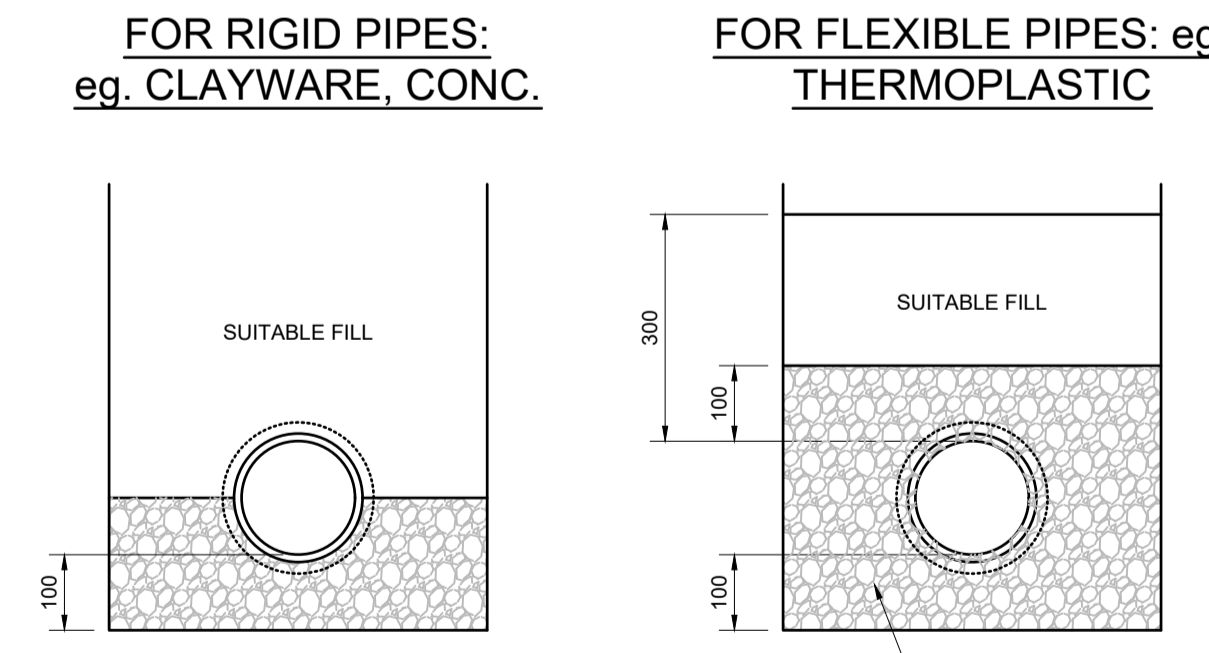
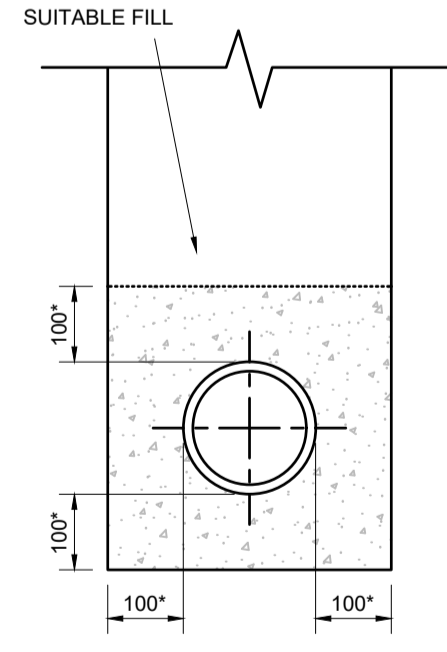

CLASS B PIPE BEDDING
TYPE S PIPE BEDDING
TYPICAL PIPE BEDDING DETAILS

SUITABLE FILL - THE SUITABLE FILL SHALL BE SUITABLE FOR THE LOCATION AND SHALL BE CAREFULLY COMPACTED TO PROVIDE A STABLE FILL WITHOUT DAMAGING THE PIPE. FILL UNDER CAR PARKING AREAS, SHARED DRIVES AND PRIVATE ROADS SHALL BE WELL COMPACTED GRADED GRANULAR MATERIAL. FILL UNDER ADAPTABLE ROADS MAY NEED TO BE TYPE 1 GRANULAR SUB-BASE MATERIAL - CHECK WITH HIGHWAY AUTHORITY IF APPROPRIATE.

GRANULAR MATERIAL - FOR RIGID PIPES THE GRANULAR MATERIAL SHOULD CONFORM TO BS EN: 1610 Annex B Table B.15 AND SHOULD BE SINGLE SIZE MATERIAL OR GRADED MATERIAL FROM 5mm UP TO A MAXIMUM SIZE OF 10mm FOR 100mm DIAMETER PIPES, 14mm FOR 150mm DIAMETER PIPES, 20mm FOR PIPES FROM 150mm TO 600mm DIAMETER AND 40mm FOR PIPES MORE THAN 600mm DIAMETER.

COVER GRADE TO BS EN: 124	LOCATION
D400	FOR USE IN INDUSTRIAL ROADS AND PARKING AREAS ACCESSIBLE TO ALL TYPES OF ROAD VEHICLES INCLUDING HGV'S.
C250*	FOR USE IN PRIVATE ROADS OR PARKING AREAS eg. CAR PARKS AND MINOR PRIVATE ROADS ACCESSIBLE TO REFUSE VEHICLES, FIRE APPLIANCES ETC WITH POSSIBLE OCCASIONAL HGV USE.
B125	FOR USE IN FOOTWAYS, PEDESTRIAN AREAS, DRIVEWAYS AND CAR PARKS ACCESSIBLE BY LIGHT VEHICLES ONLY.
A15	FOR USE IN AREAS WHICH CAN ONLY BE USED BY PEDESTRIANS AND PEDAL CYCLISTS

* D400 MAY BE USED IN LIEU OF C250 IF PREFERRED.

P1	PRELIMINARY ISSUE	23.03.22	RAC
REV	AMENDMENT	DATE	CHKD

DRAWING STATUS: **PRELIMINARY**

RCD

RCD CONSULTANTS LTD
9 BIRCH TREE WAY, MAIDSTONE, KENT, ME15 7RP
MOBILE: 07702 052 137
EMAIL: ray@rcd-consultants.com

CLIENT: RD4998

PROJECT: PROPOSED RESIDENTIAL DEVELOPMENT
FERRY ROAD
NEW HOLLAND

DRAWING TITLE: DRAINAGE CONSTRUCTION DETAILS
SHEET 1 OF 2

CIVILS			
SCALE: AS SHOWN @ A1	DRAWN BY: SC	CHECKED: RAC	DATE: MAR 2022
DRAWING NUMBER: 1115-2204-CIV-50	REVISION: P1		