

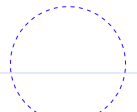



KEY:

-  tree protection barrier e.g. Heras fencing on stabilisers - to be erected prior to commencement of development and maintained until completion of development
-  root protection areas of all relevant trees within possible influencing distance of proposed new dwelling (measured in accordance with BS 5837:2012) shown dotted
-  ground protection - for pedestrian movements only - a single thickness of scaffold boards securely pinned in place on top of a 100m depth of woodchip, laid onto a geotextile membrane
-  site storage and facilities area

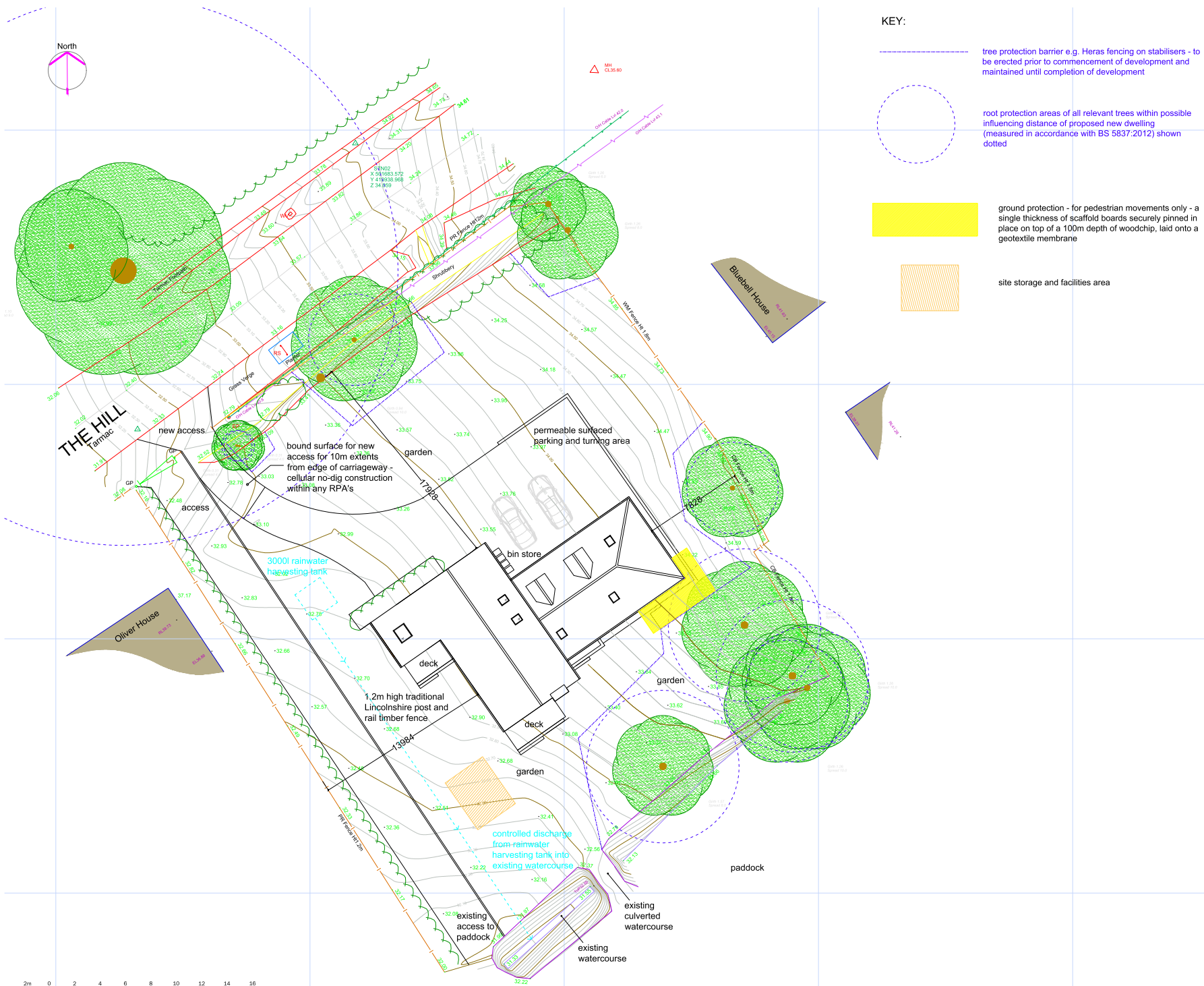

Issue Status			
This drawing is copyright. Only figured dimensions to be worked to.			
Revision	Drawn	Check	Date
A	HM	KK	30.06.2025
B	HM	KK	14.07.2025
C	HM	KK	18.07.2025
D	KK	HM	21.07.2025
E	KK	HM	22.07.2025
F	KK	HM	23.07.2025
G	KK	HM	30.07.2025
H	KK	HM	18.08.2025
J	KK	HM	22.09.2025

client <b>Mr Fillingham</b>			
project <b>Land Off The Hill, Worlaby New Dwelling</b>			
drawn <b>Site Plan</b>	date <b>775.04</b>	revision <b>J</b>	
date <b>30.06.25</b>	scale <b>1:200@A2</b>	drawn <b>KK</b>	check <b>HM</b>

**Kelly & MacPherson ARCHITECTS**

Kelly & MacPherson ARCHITECTS  
 tel: 01472 851732 mob: 07801081799 or 07443577522  
 email: kate@kellymac.co.uk or hugh@kellymac.co.uk  
 Unit 3, Caistor MUC, 19 South Street, Caistor LN7 6UB