

All dimensions & details given on this drawing are to be checked and verified on site prior to works being undertaken. Any discrepancies and/or variations to the specifications within these drawings or associated documents are to be notified to keystonearchitecture.

Do not scale from these drawings - if in doubt - ask.

All materials shall be fixed, applied or mixed in accordance with the manufacturers written instructions, recommendations and specifications. Variations to specified materials shall be agreed in writing with keystone architecture.

The Contractor shall take into account everything necessary for the proper execution of the works and to the satisfaction of the Local Authority, whether or not indicated on the drawings or in the specification.

This drawing is the copyright of keystone architecture and must not be reproduced without written consent. © keystone architecture 2025

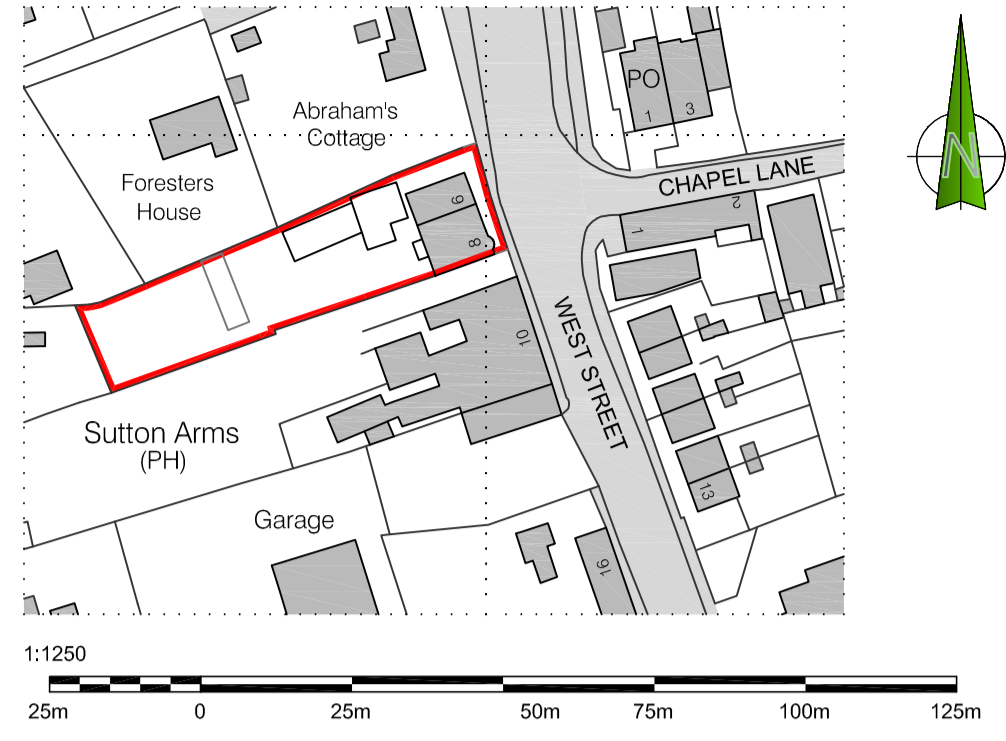

1:1250
Ordnance Survey, (c) Crown Copyright 2025. All rights reserved. Licence number 100022432
Location Plan
scale 1:1250

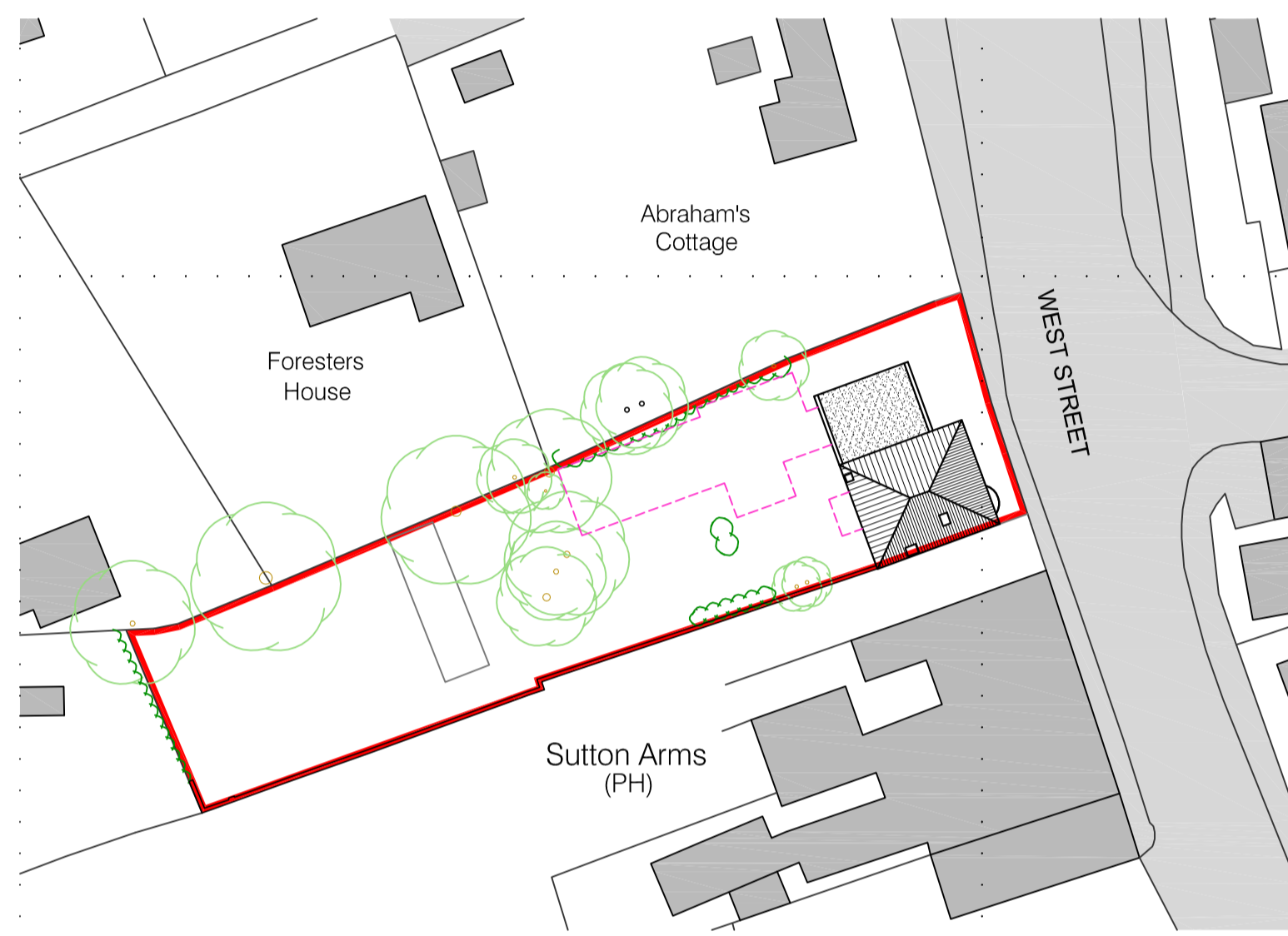

Existing Block Plan
scale 1:500

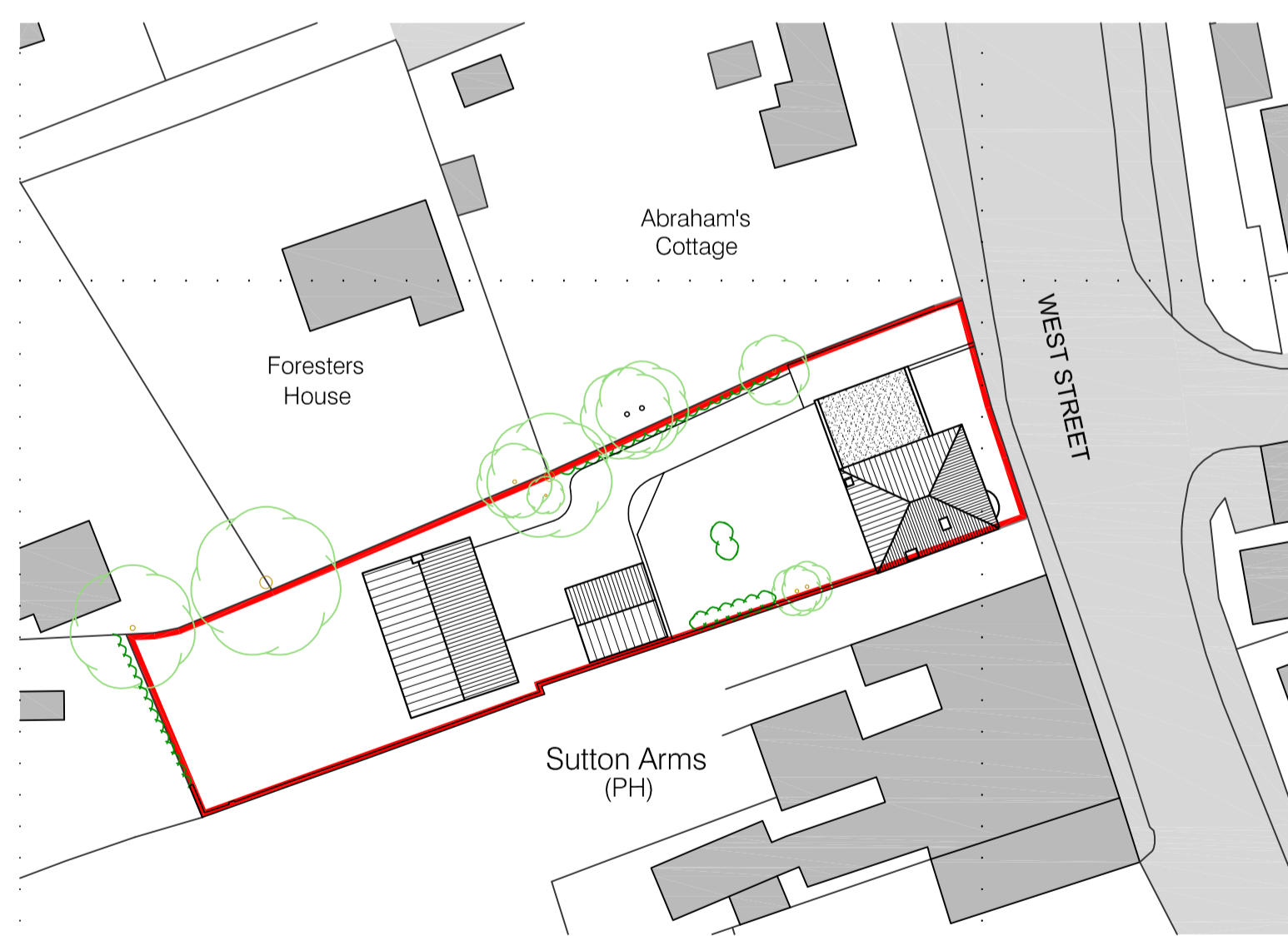

Proposed Block Plan
scale 1:500

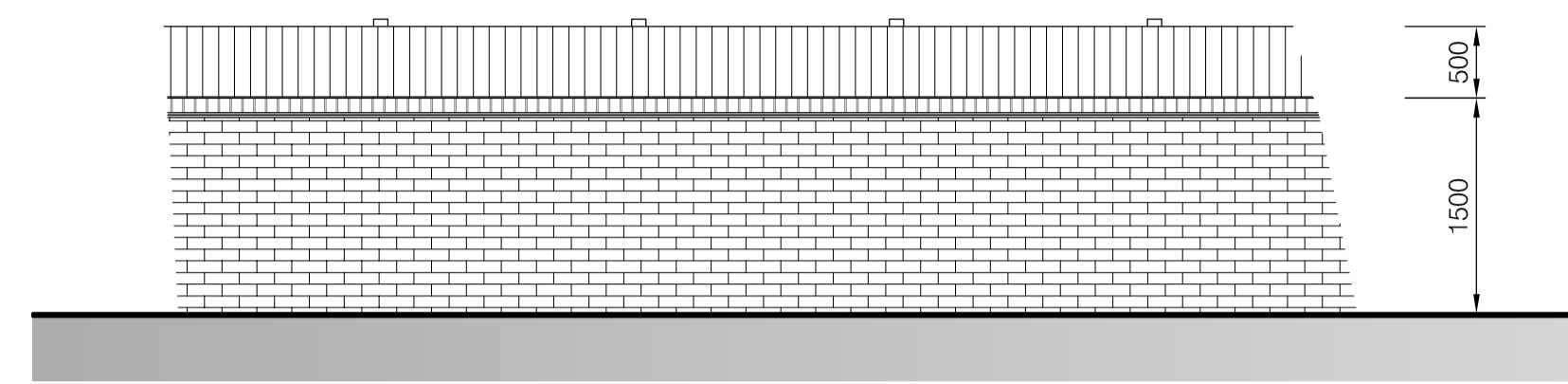

Close Board Fence to Ex. Wall Detail

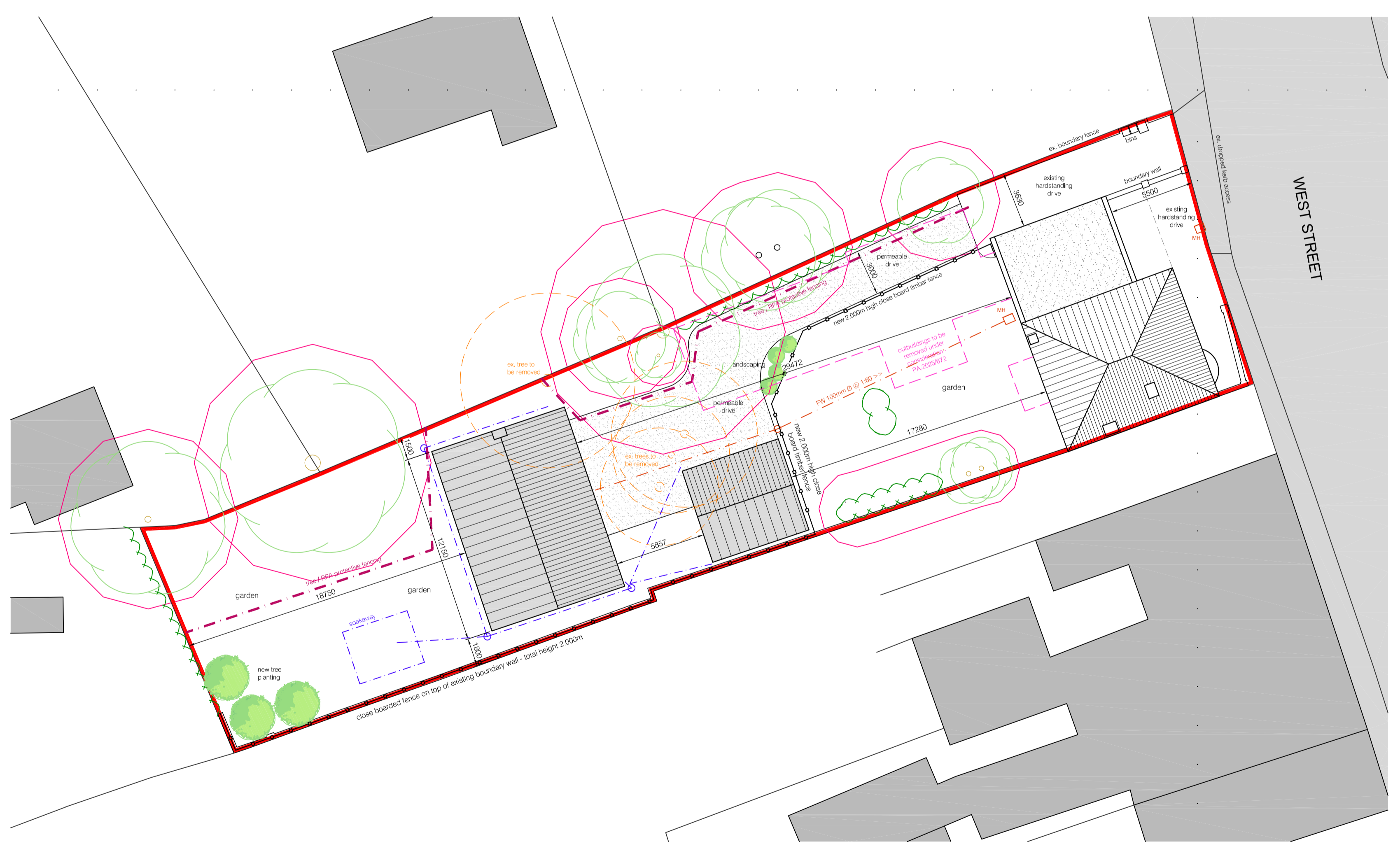

Proposed Site Plan
scale 1:200

PLANNING DRAWING ONLY

A	House Layout Amended			26/08/25
rev	amendment			date
Proposed New Dwelling	title	Site Plans	dwg. no.	2103.01 rev A
6-8 West Street	stage	Planning	drawn	May 25
Scawby	scale	as noted	drawn by	JCB
North Lincolnshire				