

All dimensions & details given on this drawing are to be checked and verified on site prior to works being undertaken. Any discrepancies and/or variations to the specifications within these drawings or associated documents are to be notified to keysonarchitecture.

All materials shall be fixed, applied or used in accordance with the manufacturers' written instructions, recommendations and specifications. Variations to specified materials shall be agreed in writing with keysonarchitecture.

The Contractor shall take full account of any requirements for the proper execution of the works shown on this drawing and shall be responsible for any and all notices on the drawings or in the specification.

This drawing is the copyright of keysonarchitecture and must not be reproduced without written consent. © keysonarchitecture 2025

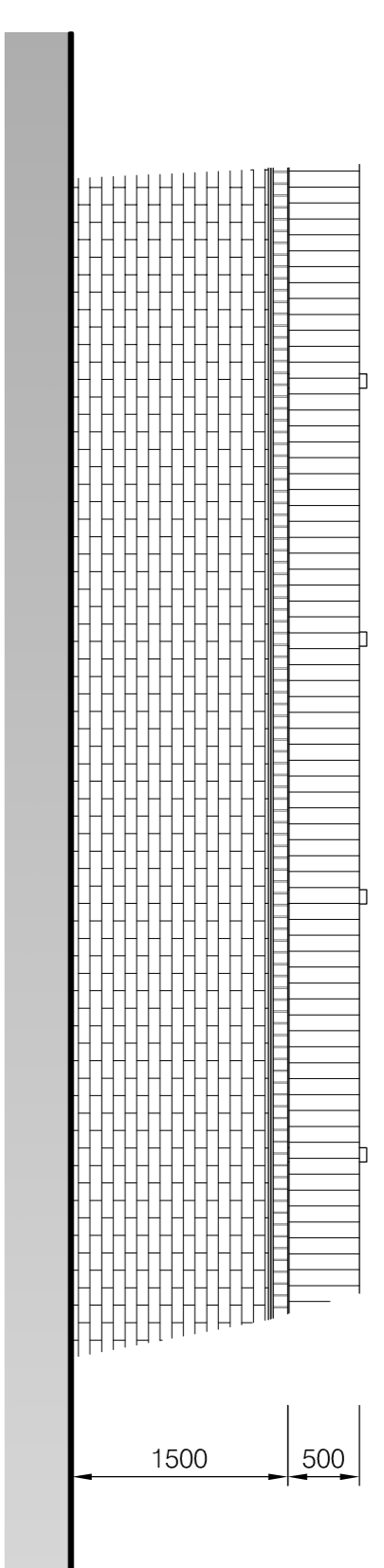

Close Board Fence to Ex. Wall Detail

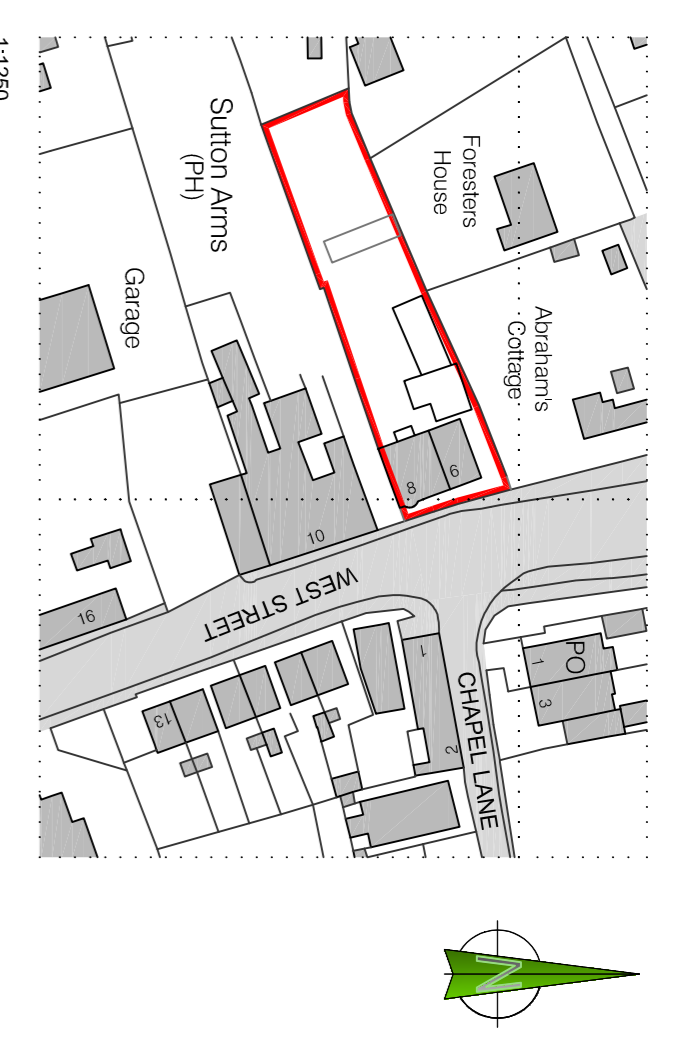

Location Plan  
scale 1:1250  
Ordnance Survey, (c) Crown Copyright 2025. All rights reserved. Licence number 100022432

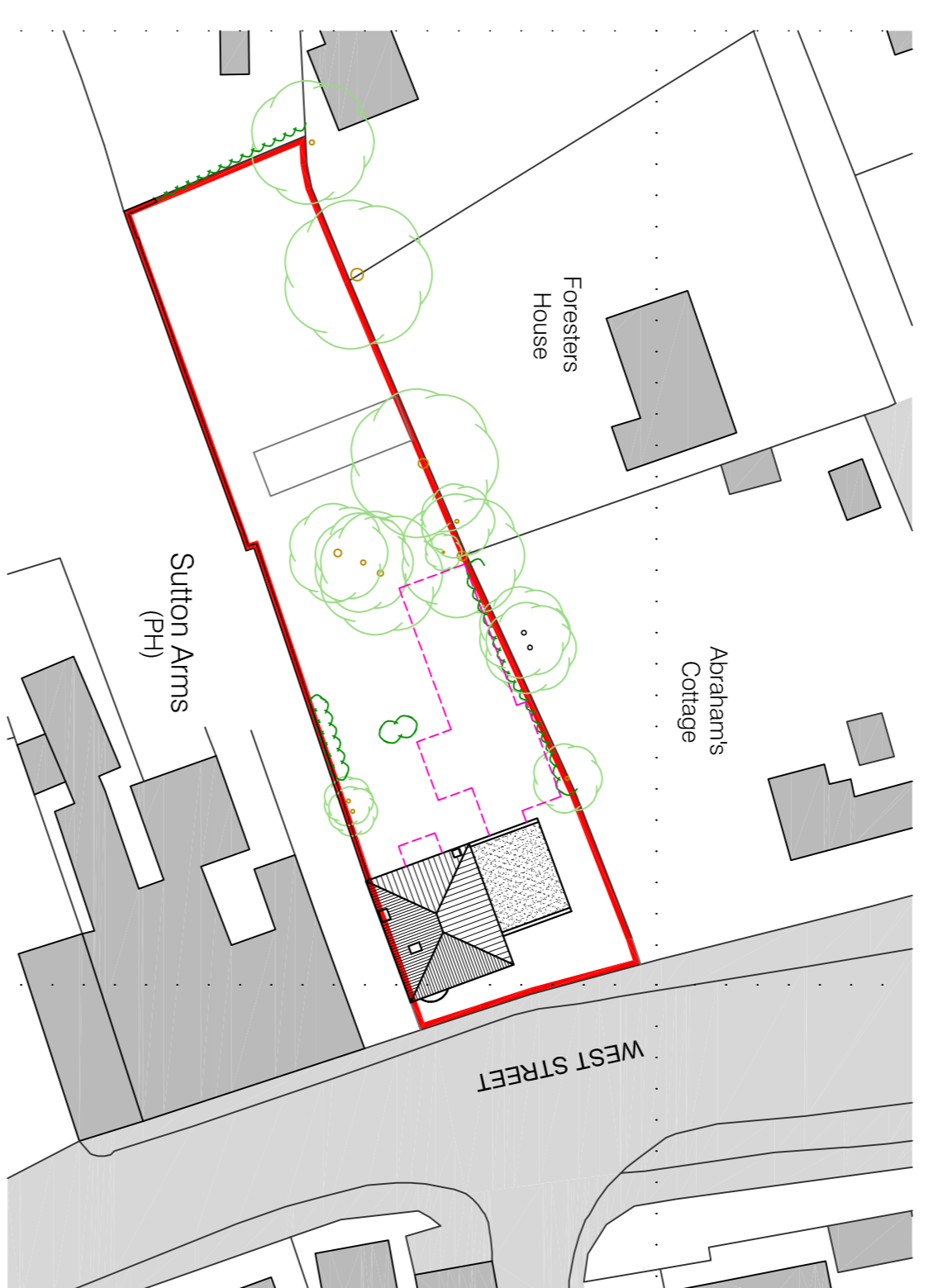

Existing Block Plan  
scale 1:500

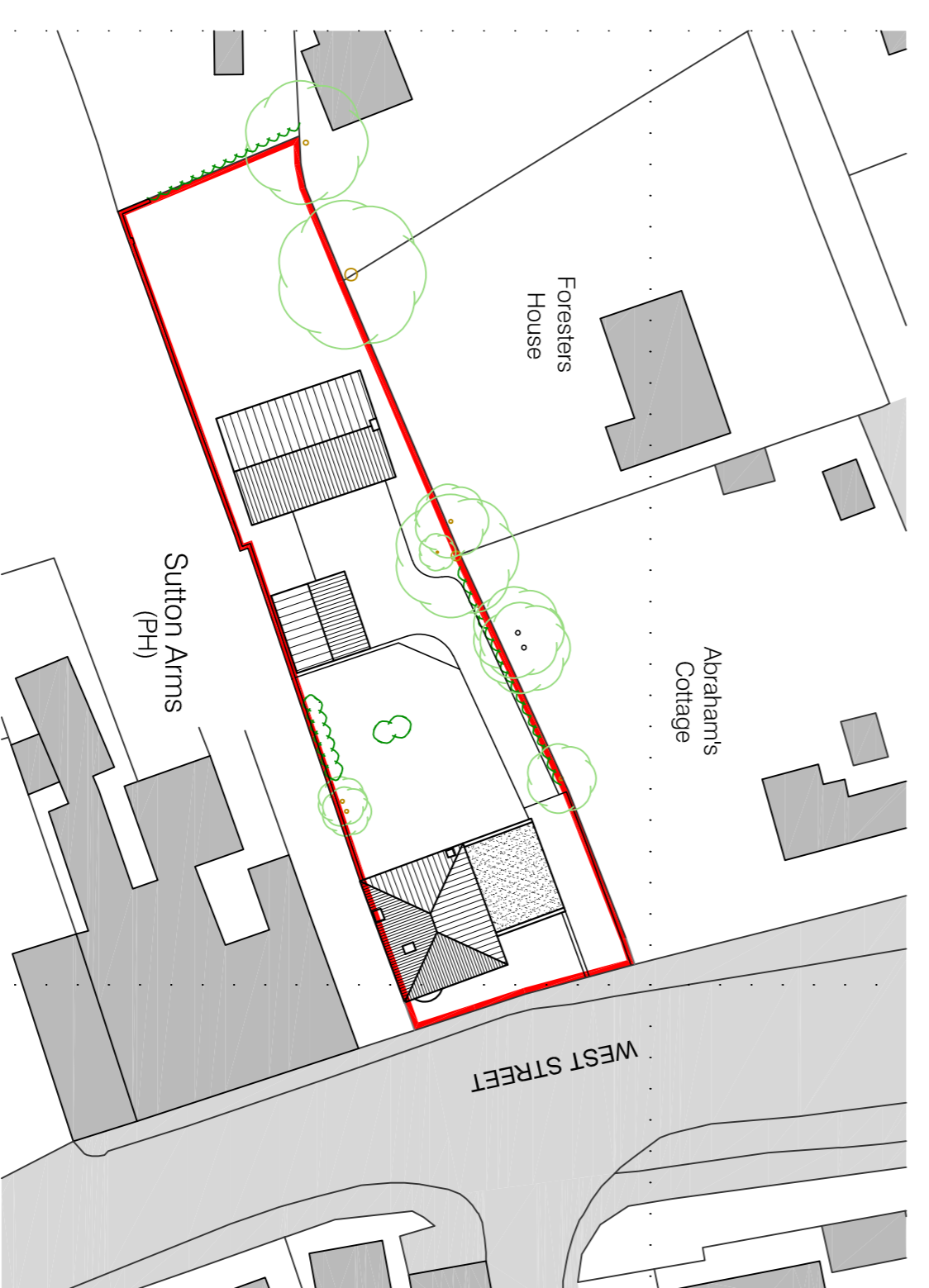

Proposed Block Plan  
scale 1:500

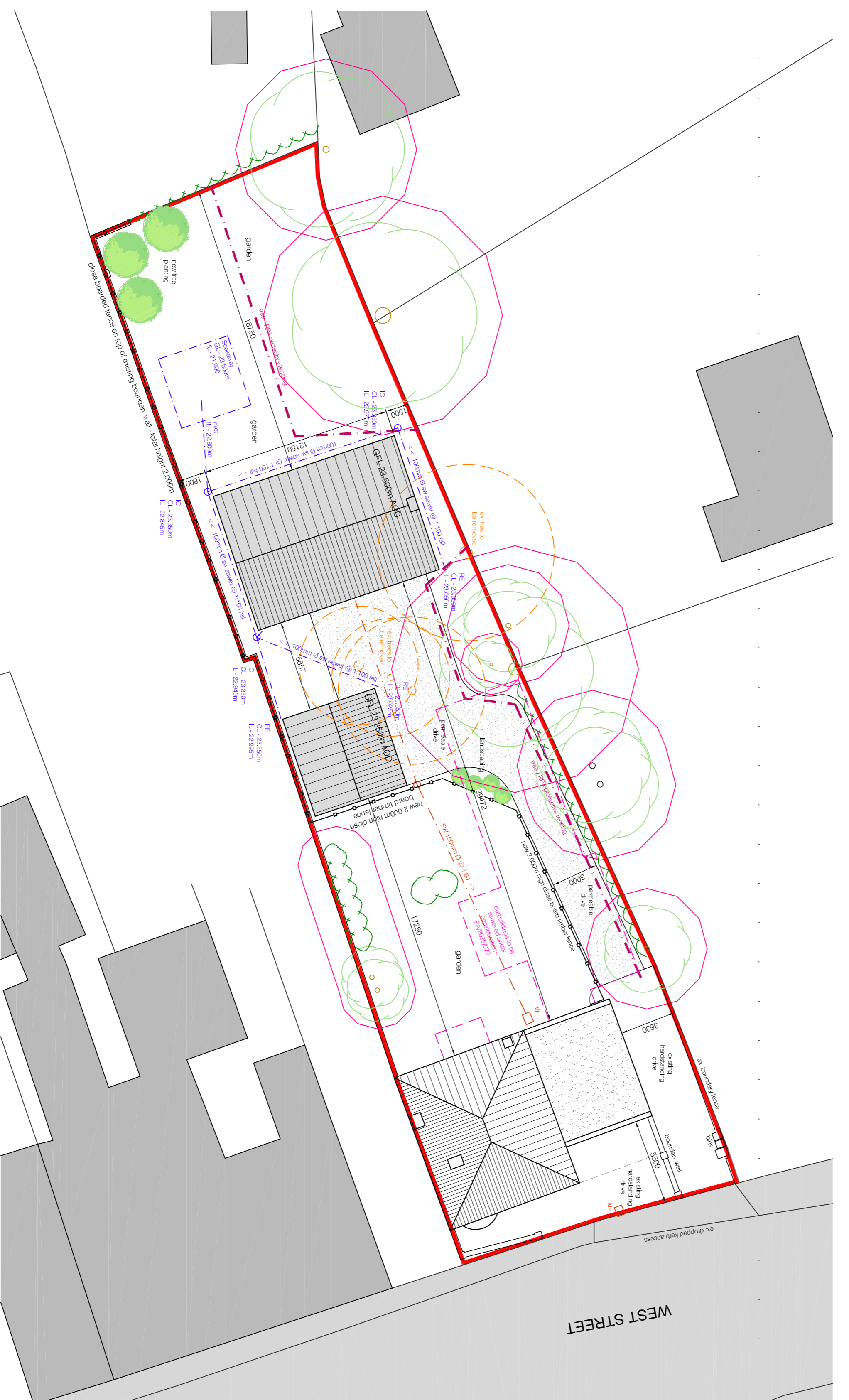

Proposed Site Plan  
scale 1:200

**PLANNING DRAWING ONLY**

B	Site/Design Layout, Saver/DAL, Levels etc. Added	23/09/25
A	Keyson Architecture	26/08/25
REV	DESCRIPTION	DATE
Proposed New Dwelling	Site Plans	23/09/25 (rev B)
58 West Street	Planning	May 25
North Lincolnshire	scale as noted	drawn by JCS