

*Allen Archaeology Limited*

**SPECIFICATION FOR A PROGRAMME OF ARCHAEOLOGICAL MONITORING AND RECORDING:  
LAND AT CHURCH FARM, WROOT, NORTH LINCOLNSHIRE**

<b>Client:</b>	<b>Richard Alderson Consulting, on behalf of Mr AT Hopkins</b>
<b>Planning Reference:</b>	<b>PA/2024/1422</b>
<b>National Grid Reference:</b>	<b>SE 71682 02625</b>
<b>AAL Site Code:</b>	<b>WRCF 25</b>
<b>Date:</b>	<b>14<sup>th</sup> January 2025</b>
<b>Museum Accession Number:</b>	<b>Applied for, pending</b>

### **1.0 Summary**

This document is the written scheme of investigation (WSI) for an archaeological scheme of works, which has been prepared for Richard Alderson Consulting, on behalf of Mr AT Hopkins, as a condition of planning consent for the erection of a dwelling on land at Church Farm, Wroot, North Lincolnshire. The fieldwork, recording and reporting will be carried out in a manner consistent with current national guidelines, as set out in the Chartered Institute for Archaeologists ‘*Standard for archaeological monitoring and recording*’ (CIfA 2023a), ‘*Universal guidance for archaeological monitoring and recording*’ (CIfA 2023b), and the English Heritage document ‘*Management of Research Projects in the Historic Environment*’ (English Heritage 2006).

### **2.0 Site Location and Description**

Wroot is situated within the administrative district of North Lincolnshire approximately 11.5km east of Doncaster and 19km west-south-west of Scunthorpe. The site comprises a sub-rectangular shaped block of land approximately 0.5km to the south of the centre of the village. The site is currently pasture, and centres on NGR SE 71682 02625 (Figure 1).

The local geology of the area comprises bedrock deposits of Chester Formation Sandstone, pebbly (gravelly). The overlying superficial deposits are Glaciofluvial Deposits – Devensian sand and gravel (<http://mapapps.bgs.ac.uk/geologyofbritain/home.html>).

### **3.0 Planning Background**

A planning application has been submitted to North Lincolnshire Council ‘*to erect a dwelling to replace a temporary dwelling granted under PA/2019/2037 in connection with a farming business and vineyard, Church Farm, Field Lane, Wroot*’ (PA/2024/1422).

The Historic Environment Officer who advises North Lincolnshire Council on archaeological planning matters has requested that pre-commencement planning conditions will be required, unless an appropriate Written Scheme of Investigation (WSI) is in place prior to determination of the application. The client has therefore requested that the WSI is submitted to the Historic Environment Officer prior to determination of the application.

The approach adopted is consistent with the recommendations of the National Planning Policy Framework (NPPF), with the chapter of relevance being ‘*Section 16. Conserving and enhancing the historic environment*’ (Department for Levelling Up, Housing and Communities online 2023).

#### **4.0 Archaeological and Historical Background**

There is evidence of prehistoric activity in the surrounding landscape, including a Neolithic Jadeite axe that was from the Swiss or Italian Alps that was bought from a dealer or sale at the rectory by the local archaeologist Mrs. E Rudkin around 1930 (North Lincolnshire Historic Environment Record number (NLHER) 2445), and a Bronze Age perforated stone axe hammer that was found in sand to the southeast of Wroot Grange (NLHER 2442). A few worked flint scatters have been recorded in the surrounding area too, including Early Neolithic to Early Bronze Age core, flakes and a scraper (NLHER 19570), as well as flint flakes and debitage from surrounding fields (NLHER 19528 and 19530).

Approximately 500m to the north of the site, ploughing exposed a Late Bronze Age bronze spear in 1976, although the object has disappeared, and no photographs exist of it (NLHER 17349).

Metal detecting c.120m to the north of the site uncovered two coins, one an Iron Age stater (NLHER 17439) and an Anglo-Saxon 'porcupine' sceatta, c. 690-750 AD (NLHER 17440). Further Iron Age activity is suggested by the recovery of a possible Celtic finger ring to the west of the site in the field west of Field Lane (NLHER 17515).

A few artefacts have been found on the site during fieldwalking and metal detecting which suggest Romano-British occupation on or near to the site (NLHER 17317). Finds include a bracelet, steelyard weight, brooch, coin of Claudius II and pottery.

The Anglican Church of St Pancras immediately to the north of the site was constructed in 1878 and is of brick with lancet windows and a south porch tower (NLHER 7476). It is known that an earlier church existed in the village as a document from 1566 lists church furniture and other items that were deliberately destroyed during the reformation. A Methodist chapel which has been converted into a private residence is noted c.400m to the north of the site (NLHER 21930).

#### **5.0 Aims and Objectives**

The purpose of the watching brief will be for monitoring and recording associated with any groundworks associated with the dwelling and access road.

Evidence shall be gathered to establish the presence/absence, nature, date, depth, quality of survival and importance of any archaeological deposits to enable an assessment of the potential and significance of the archaeological remains, and to assess the impact of the development upon the archaeology.

#### **6.0 Methodology**

One experienced field archaeologist will be present during all groundworks for the scheme. They will act strictly in accordance with the contents of this document and will adhere to national and local guidelines regarding agreed best practice for archaeological monitoring and recording projects.

The scheme of archaeological works will involve monitoring of all ground disturbances associated with the development, with the ability to stop and fully record archaeological features. If archaeological remains are revealed, then hand excavation will be required where such deposits can be accessed safely.

All groundworks should be carried out using a mechanical excavator fitted with a toothless bucket, except for where removal of concrete or tarmac surfaces or obstructions necessitates the use of a hydraulic breaker or toothed bucket, at the discretion of the supervising archaeologist.

A full written record of the archaeological deposits will be made on standard Allen Archaeology Limited context recording sheets. Sections to be excavated will be marked with string and nails and allocated an individual drawing number. A comprehensive record of all drawings will be maintained, and the location of every section drawing plotted onto the site master plan and correctly referenced. All excavated sections will then be drawn at an appropriate scale (1:10, 1:20 or 1:50), with Ordnance Datum heights being displayed on each drawing.

Digital photography will form an integral part of the recording strategy, using a DSLR camera with 24mp sensors. Photographs will incorporate scales, an identification board and directional arrow where appropriate. All photographs will be archived in TIFF format.

If human burials or cremations are exposed during the groundworks, in the first instance the Historic Environment Officer at Heritage Lincolnshire will be contacted to discuss an appropriate strategy for the management of the human remains. It is anticipated however that wherever possible the human remains will be left in situ unless at direct threat from the proposed development. If the remains are at threat from the development, AAL will obtain a Ministry of Justice licence authorising the removal of the remains. These will be cleaned, photographed and recorded on standard AAL human skeletal remains recording sheets, prior to removal for cleaning at the offices of AAL and subsequent analysis by the named specialist.

Any artefacts found during the investigation that are deemed to be 'treasure' (as defined by the Treasure Act 2023) will be removed from site to a secure store and reported to the appropriate coroner's office.

All finds of all classes will be collected, other than obviously modern finds from topsoil and subsoil contexts. The spoil from the excavated areas will be examined for further artefact recovery. Finds collected during the fieldwork will be bagged and labelled with the appropriate deposit context number, while registered finds will be 3D located and bagged individually with the deposit context number and small find number. If necessary, the relevant specialist will visit the site during fieldwork to advise on the artefact collection and retention strategies. All finds will be processed (cleaned, marked and labelled as appropriate) at the offices of Allen Archaeology Limited. These will then be submitted for specialist reporting to the following organisations/persons (depending on their availability):

Sarah Percival	Early prehistoric pottery
Dr Joshua Hogue	Worked lithic materials
Alice Beasley	Later prehistoric and Roman ceramics
Paul Blinkhorn	Post-Roman ceramics
Zoe Tomlinson	Ceramic building material
Bryn Leadbetter	Animal bone
Tania Kausmally	Human bone
Adam Daubney	Other finds
Val Fryer	Environmental analysis
York Archaeological Trust	Conservation

## **7.0 Environmental Works**

Samples will be taken from deposits that have the potential to provide information on the preservation conditions and potential of analysis of all biological remains. If appropriate during the investigation, specialist advice will be sought from the environmental archaeologist, including a site visit to develop the sampling strategy. Processing and assessment of environmental remains will take place at Allen Archaeology's Lincoln office.

Bulk samples will be taken from a selection of stratified contexts that have produced secure good dating evidence, and sufficient in number to establish the range and quality of the environmental evidence. Where feasible, bulk samples will be taken as scatter samples, whereby tubs will be filled from different locations within the designated fill to avoid spatial preservation bias or missing biological remains invisible to the naked eye which can form discrete 'clusters' within the fill (English Heritage, 2011, 10).

Animal bone will be hand collected from all excavated features. These will be identified and assessed by the named specialist (Bryn Leadbetter), with any recommendations for future archaeological work on the site.

## **8.0 Post-Excavation and Reporting**

On completion of each phase of fieldwork, the records produced during the fieldwork will be checked and ordered and a stratigraphic matrix of all archaeological features and deposits prepared. A short interim report will then be prepared for each phase of work, including an overall site plan, a summary of the results and a list of finds.

Upon completion of all site works, a fully illustrated report text will then be prepared that will contain the following information:

- A non-technical summary of the results
- A description of the archaeological setting of the site
- Description of the topography and geology of the investigation area
- Description of the methodologies used during the works and discussion of their effectiveness in the light of the results
- A text describing the results of the fieldwork
- Overall plan of the site showing excavated areas, accurately located to the national grid
- Plans of the excavated areas showing the archaeological features exposed
- Sections of the archaeological features
- Interpretation of the archaeological features exposed and their context within the surrounding landscape
- Specialist assessment reports on the finds from the site
- Appropriate photographs of the site, and specific archaeological features or groups of features
- A consideration of the significance of the remains found, in local, regional, national and international terms, using recognised evaluation criteria

## **9.0 Archive**

The documentation and records generated by the investigation will be assembled in accordance with the national guidelines in *'Archaeological Archives: A guide to best practice in creation, compilation,*

*transfer and curation*' (AAF 2011). The archive will be deposited with Scunthorpe Museum; a museum accession code has been applied for.

#### **10.0 Report Dissemination**

The final report will be completed within six months of the conclusion of the fieldwork, and digital copies will be sent to the client, to the Local Planning Authority, the North Lincolnshire Historic Environment Record and the Historic Environment Officer at North Lincolnshire Council. A summary account on the results of the investigation in the form of an OASIS form will be forwarded to the ADS in York following the completion of the works, and the final report will be uploaded to OASIS.

#### **11.0 Curatorial Monitoring**

Curatorial responsibility for the investigation on the site rests with the Historic Environment Officer at the Historic Environment Officer at North Lincolnshire Council. 2 weeks' notice (or 10 working days) will be given prior to the commencement of the project to enable them to make appropriate monitoring arrangements.

#### **12.0 Variations to the Proposed Scheme of Works**

Variations to the proposed scheme will only be made following written confirmation from the Historic Environment Officer at North Lincolnshire Council.

Should any further investigation be required beyond the scope of the brief for works, or this specification, then the cost and duration of those supplementary examinations will be negotiated between the client and the contractor.

#### **13.0 Health and Safety**

All work will be carried out in a way that complies with the Health and Safety at Work Act 1974 and its related regulations and codes of practice. Employees of Allen Archaeology Limited will perform their duties in accordance with company safety policy, with senior staff responsible for monitoring compliance with health and safety requirements and legislation.

The archaeological site supervisor will be responsible for ensuring that all on-site archaeological work is carried out in a safety-conscious, sensible and responsible manner with due regard for the relevant health and safety requirements and legislation. All staff involved in the scheme will be provided with a Risk Assessment document prior to commencement of site operations.

#### **14.0 Insurance**

Allen Archaeology Limited maintains Employers Liability Insurance to £10,000,000.00, Public Liability Insurance to £5,000,000.00 and Professional Indemnity Insurance to £2,000,000.00. Copies of insurance documentation can be supplied upon request.

#### **15.0 Copyright**

Allen Archaeology shall retain full copyright of any commissioned reports under the *Copyright, Designs and Patents Act 1988* with all rights reserved; excepting that an exclusive license is hereby provided to the client for the use of such documents by the client in all matters directly relating to the project described in this document.

License is also given to the archaeological curator to use the documentary archive for educational, public and research purposes. This license does not cover commercial use of the material by the NLHER, North Lincolnshire Council or a third party.

In the case of non-satisfactory settlement of account then copyright will remain fully and exclusively with Allen Archaeology. In these circumstances it will be an infringement under the *Copyright, Designs and Patents Act 1988* for the client to pass any report, partial report, or copy of same, to any third party. Reports submitted in good faith by Allen Archaeology to any Planning Authority or archaeological curator will be removed from said Planning Authority and/or archaeological curator. The Planning Authority and/or archaeological curator will be notified by Allen Archaeology that the use of any such information previously supplied constitutes an infringement under the *Copyright, Designs and Patents Act 1988* and may result in legal action.

The author of any specialist contribution to a report shall retain intellectual copyright of their work and may make use of their work for educational or research purposes for further publication.

## **16.0 References**

AAF, 2011, *Archaeological Archives: A guide to best practice in creation, compilation, transfer and curation*, Archaeological Archives Forum

CIfA, 2023a, *Standard for archaeological monitoring and recording*, Chartered Institute for Archaeologists, Reading

CIfA, 2023b, *Universal guidance for archaeological monitoring and recording*, Chartered Institute for Archaeologists, Reading

Department for Levelling Up, Housing and Communities, 2023, *National Planning Policy Framework*. London, Department for Communities and Local Government

English Heritage, 2004, *Human Bones from Archaeological Sites: Guidance for Producing Assessment Documents and Analytical Reports*, Historic England

English Heritage, 2011, *Environmental Archaeology: a guide to the theory and practice of methods, from sampling and recovery to post-excavation (second edition)*, English Heritage

Historic England, 2015, *Management of Research Projects in the Historic Environment: The MoRPHE Project Managers' Guide*. Historic England

WSI prepared by Mark Allen  
Allen Archaeology Limited  
14<sup>th</sup> January 2025

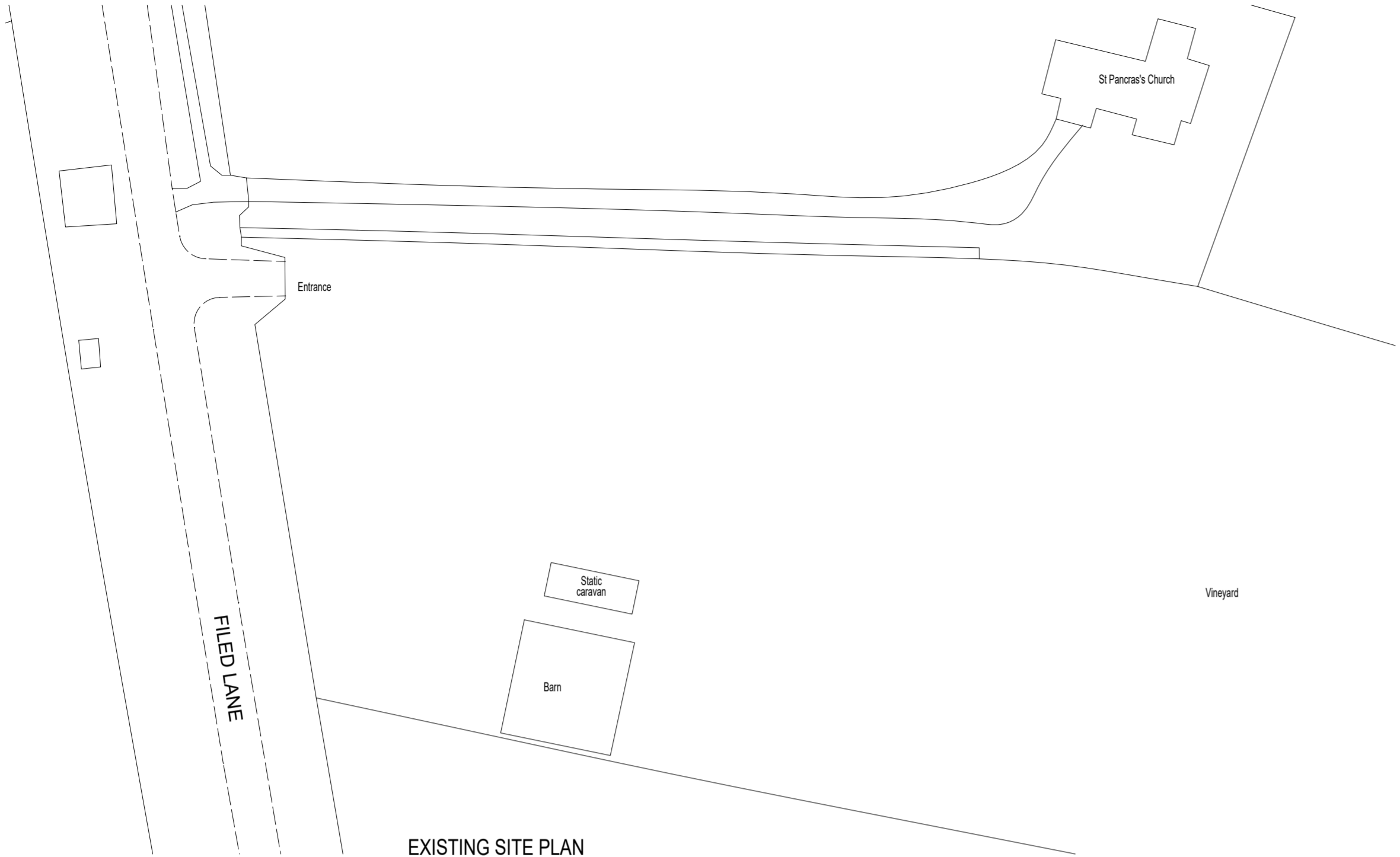

EXISTING SITE PLAN  
1:500

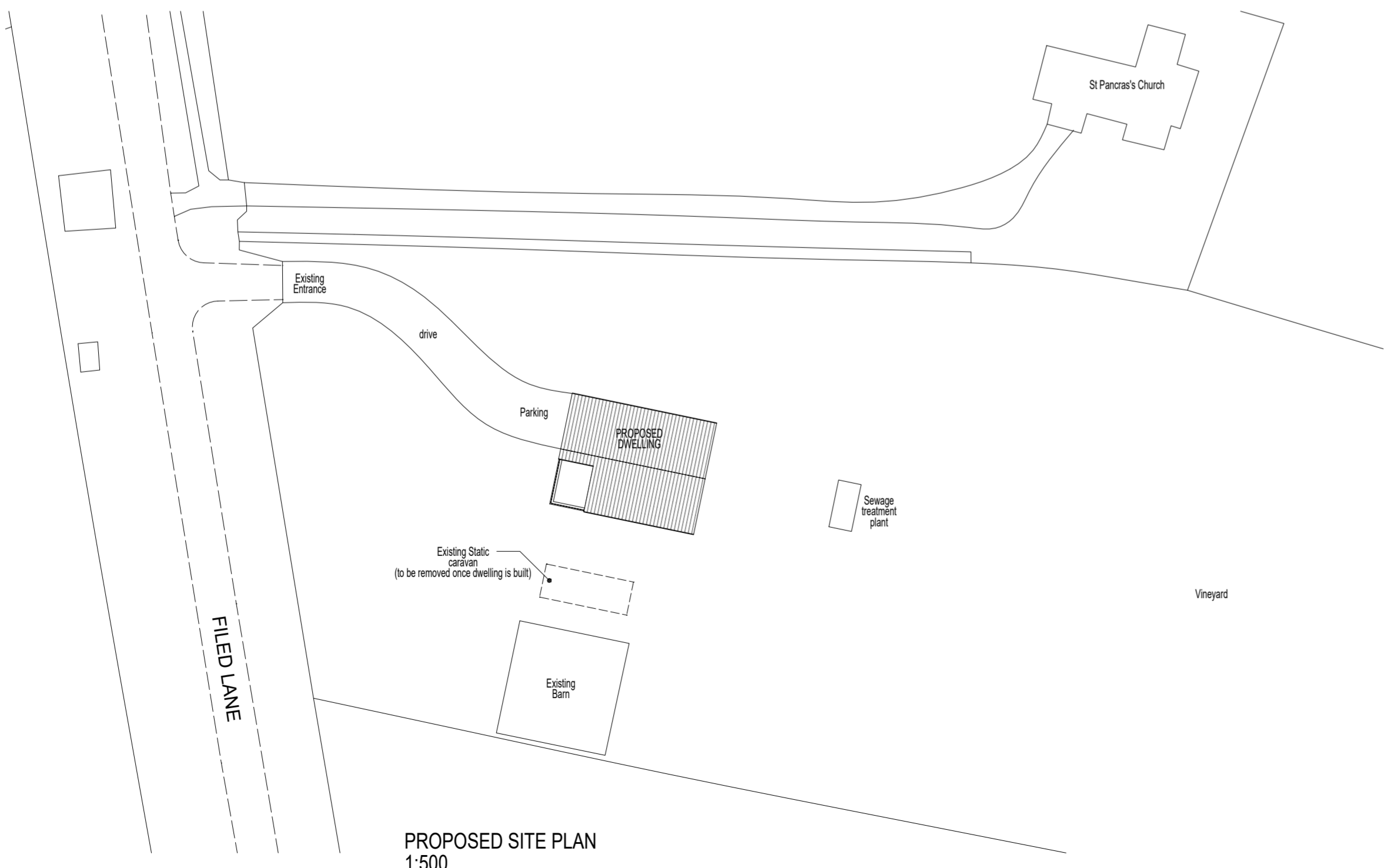

PROPOSED SITE PLAN  
1:500

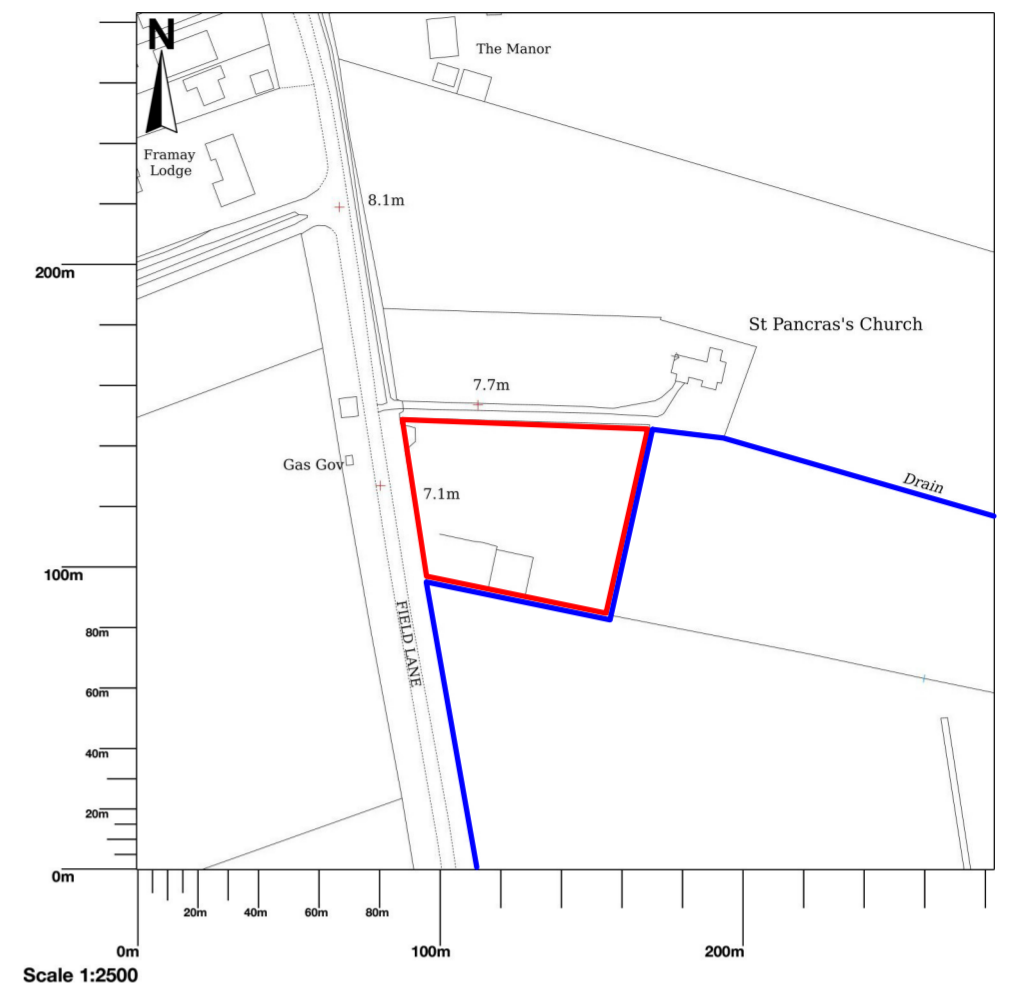

© Crown copyright and database rights 2024 OS 100054135. Map area bounded by: 471551,402502 471833,402784. Produced on 20 September 2024 from the OS National Geographic Database. Supplied by UKPlanningMaps.com. Unique plan reference: p8f/uk/1151778/1548774

LOCATION PLAN  
1:2500



**Cadworx Ltd**  
Architectural design and 3d Visualisations  
Linden House, Bracken Hill Road  
East Lound, Nr Doncaster DN9 2LR  
tel 01427 753232  
danny@3dcadworx.com

- Project
- PROPOSED DWELLING
- WROOT
- MR A HOPKINS
- Title:
- LOCATION PLAN
- SITE PLANS

Scale 1:500 / 2500 @ A2	Date 09-2024	Drawn DS
Drawing No. CWX1124 - 101		
A   B   C   D   E   F   G   H   J		



Allen Archaeology Limited  
[www.allenarchaeology.co.uk](http://www.allenarchaeology.co.uk)

Company Registered in England and Wales No: 6935529

**Lincoln**  
**Whisby Lodge**  
**Hillcroft Business Park**  
**Whisby Road**  
**Lincoln**  
**Lincolnshire**  
**LN6 3QL**

**T: +44 (0) 1522 685356**  
**E: [info@allenarchaeology.co.uk](mailto:info@allenarchaeology.co.uk)**

**West**  
Arion Business Centre  
Harriet House  
118 High Street  
Birmingham  
B23 6BG  
T: +44 (0) 800 610 2545  
E: [birmingham@allenarchaeology.co.uk](mailto:birmingham@allenarchaeology.co.uk)

**South**  
International House  
Southampton International Business  
Park  
George Curl Way  
Southampton  
SO18 2RZ

T: +44 (0) 800 610 2555  
E: [southampton@allenarchaeology.co.uk](mailto:southampton@allenarchaeology.co.uk)

**East**  
Wellington House  
East Road  
Cambridge  
Cambridgeshire  
CB1 1BH  
T: +44 (0) 800 610 2550  
E: [cambridge@allenarchaeology.co.uk](mailto:cambridge@allenarchaeology.co.uk)

**Northwest**  
Office 4  
Barbury House,  
8 Hardy Close,  
Nelson Court Business Centre,  
Preston,  
PR2 2XP

T: +44 (0) 1772 963039  
M: +44 (0) 7710 099052  
E: [northwest@allenarchaeology.co.uk](mailto:northwest@allenarchaeology.co.uk)