

NOTE:
 - PROPOSED UNIT ROOF PLAN AS PER DRAWINGS RECEIVED FROM HARRIS PARTNERSHIP ARCHITECTS DATED 04.2024

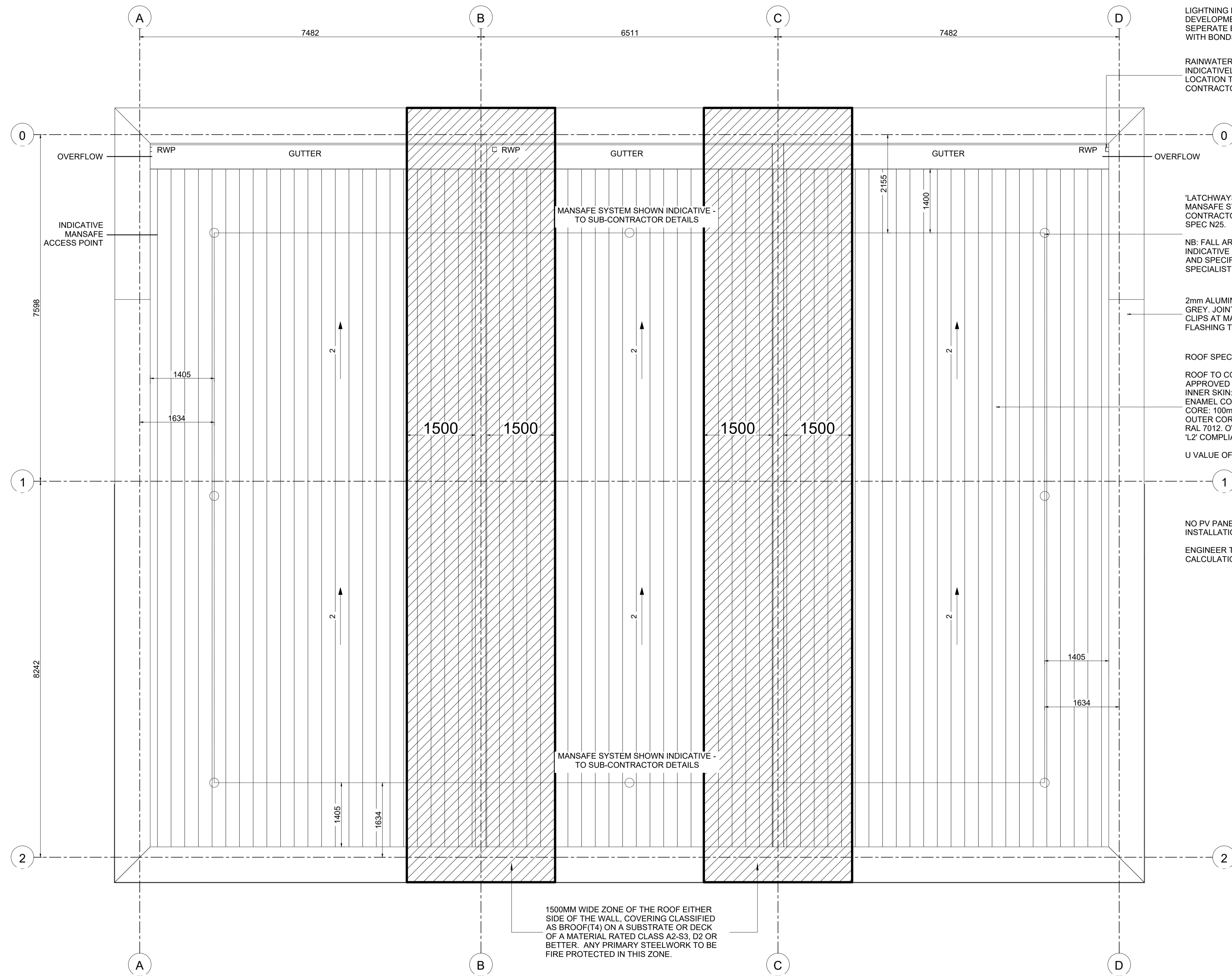

LIGHTNING PROTECTION SYSTEM TO BE INSTALLED TO THE DEVELOPMENT, COMPLIANT WITH BS 5561. THIS SHALL USE SEPARATE EARTH RODS, CONTAINED TAMPER PROOF PITS WITH BONDS TO THE STRUCTURAL STEELWORK.

RAINWATER OULET NUMBER AND POSITION SHOWN INDICATIVELY. EXACT NUMBER, SPECIFICATION AND LOCATION TO BE CONFIRMED BY SPECIALIST CONTRACTOR.

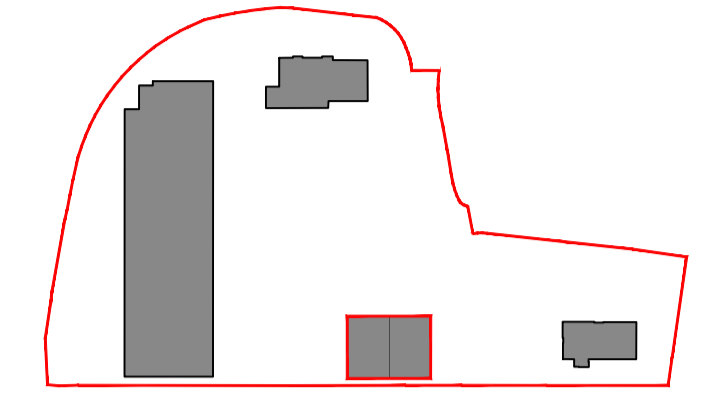

SITE KEY PLAN

OVERFLOWS TO BE INCLUDED TO GUTTER ENDS- EXACT NUMBER TO BE CONFIRMED BY THE ROOFING CONTRACTOR AND COORDINATED BY THE ARCHITECT.

'LATCHWAYS' OR EQUAL APPROVED GUIDED TYPE FALL ARREST & MANSAFE SYSTEM FOR COMPOSITE ROOF PANELS BY SPECIALIST CONTRACTOR WITHIN ROOFING CONTRACTOR'S PACKAGE - TO NBS SPEC N25.

NB: FALL ARREST INFORMATION SHOWN HERE IS INTENDED AS INDICATIVE LAYOUT ONLY. PROJECT SPECIFIC DESIGNS, DRAWINGS AND SPECIFICATIONS ARE TO BE PREPARED BY THE SPECIFIED SPECIALIST CONTRACTOR FOR EACH AND EVERY PROJECT.

2mm ALUMINIUM PARAPET FLASHING. COLOUR RAL 7012 SLATE GREY. JOINTS TO MATCH GRIDLINES FIXED WITH CONCEALED CLIPS AT MAX 1000mm CENTRES TO SUPPORTING FRAME. FLASHING TO BE SUITABLY STIFFENED TO AVOID RIPPLING.

ROOF SPECIFICATION:

ROOF TO COMPRISE OF: KINGSPAN QUADCORE 'TOPDEK' FM APPROVED COMPOSITE MEMBRANE COVERED ROOF PANELS. INNER SKIN: 0.7mm THICK GALVANISED STEEL SHEETS, LINER ENAMEL COATED, COLOUR: 'BRIGHT WHITE' INTERNAL FINISH. CORE: 100mm THICK ECOSAFE, LPC GRADE 'B', PIR INSULATION. OUTER CORE: 1.5mm THICK MEMBRANE, COLOUR: BASALT GREY RAL 7012. OVERALL 138mm THICK. ALL AS KINGSPAN LTD. PART 'L2' COMPLIANT RECOMMENDATIONS.

U VALUE OF ROOF TO ACHIEVE MINIMUM OF 0.18 W/M SQ K.

NO PV PANELS SHOWN AT THIS STAGE. LOCATION, DESIGN AND INSTALLATION TO SUB-CONTRACTOR DESIGN AND DETAILS.

ENGINEER TO CONSIDER FUTURE INSTALL IN ROOF LOADING CALCULATIONS.

1500MM WIDE ZONE OF THE ROOF EITHER SIDE OF THE WALL, COVERING CLASSIFIED AS BROOF(T4) ON A SUBSTRATE OR DECK OF A MATERIAL RATED CLASS A2-S3, D2 OR BETTER. ANY PRIMARY STEELWORK TO BE FIRE PROTECTED IN THIS ZONE.

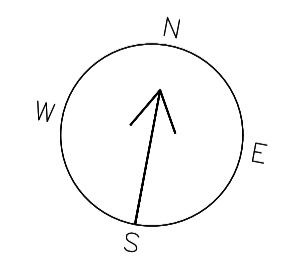

brown

15 HALFORD STREET
 LEICESTER
 LE1 1JA
 www.brownstudio.co.uk

PROJECT:
 GALLAGHER RETAIL PARK
 UNIT 06, 07 & 08
 PLANNING DRAWINGS

CLIENT:
 ADIL GROUP

ADDRESS:
 GALLAGHER RETAIL PARK,
 SCUNTHORPE,
 DN15 8TE

DRAWING TITLE:
 PROPOSED UNIT ROOF PLAN

DRAWING NO: C101

JOB NO: 2133 | **STATUS:** P|REV | **DATE:** 03.12.25

SCALE: 1:50 @A1 | **DRAWN:** JKB | **CHECKED:** CB

ALL DRAWINGS HAVE BEEN PREPARED FROM A DIGITAL SURVEY OR EXISTING DRAWINGS PROVIDED BY OTHERS. ACCURACY CANNOT BE ASSUMED AS ALL DRAWINGS REFLECT DESIGN INTENT ONLY. ALL FIXTURES, CROSS SECTIONS, AND JOINTS BETWEEN STRUCTURES ARE TO BE CONFIRMED BY THE MAIN CONTRACTOR. IT IS ALSO THE MAIN CONTRACTOR'S RESPONSIBILITY TO CONFIRM SITE DIMENSION CHECKS AND PRODUCE ROD DRAWINGS PRIOR TO ANY WORKS UNDERTAKEN. DETAILS WILL BE SUBJECT TO APPROVAL OF ROD DRAWINGS AND SITE STRIP OUT.

ALL MECHANICAL, KITCHEN, ELECTRICAL, DRAINAGE, STRUCTURAL ENGINEER, PV LAYOUTS AND COMMUNICATION SERVICES TO BE CONFIRMED BY SPECIALIST CONTRACTORS PRIOR TO ANY WORKS UNDERTAKEN.

MAIN CONTRACTOR TO ENSURE ALL FIXTURES & FITTINGS ARE IN COMPLIANCE WITH REQUIRED UK BUILDING CONTROL STANDARDS

ALL MATERIALS TO COMPLY WITH BUILDING CONTROL REQUIREMENTS WITH APPROPRIATE CLASS RATINGS FOR SPREAD OF FLAME

© copyright reserved by Brown Studio

