

DISCLAIMER: This drawing and the building works depicted are the copyright of Pinnegar Hayward Design and may not be reproduced or amended except by written permission. No liability will be accepted for amendments made by other persons.

All dimensions are to be checked on site and the Architect is to be notified of any discrepancies prior to commencement.

Do not scale. If an accurate dimension is required, please contact the Architect

Notes

No.	XXX	Description:	XXX
1.		Drawing based on topographical survey information provided	by others.

KEY: — Application Boundary (0.54 ac)

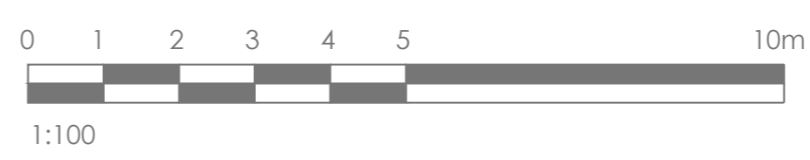
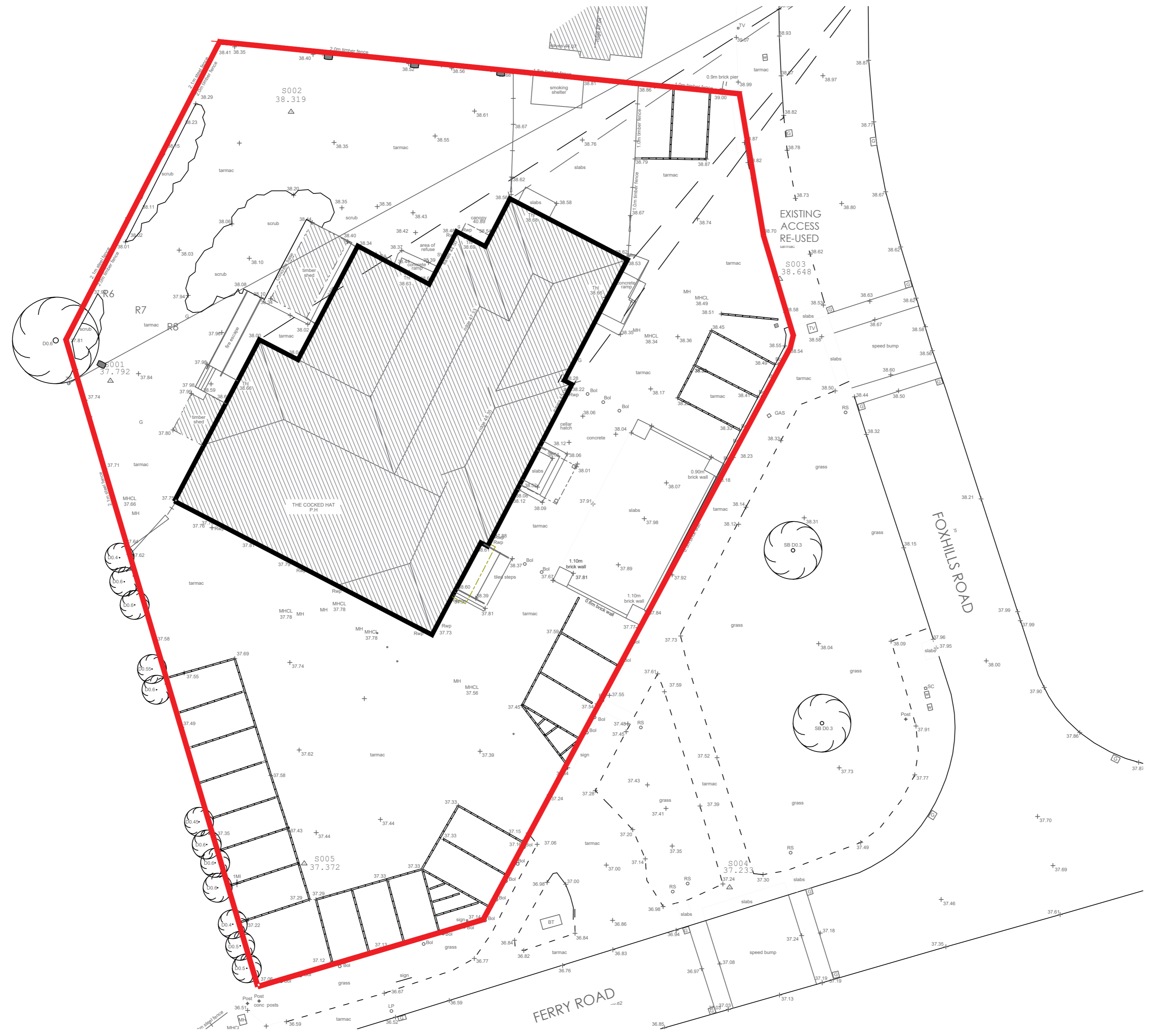

Revision	Date	Description
D1	22.10.25	Initial Issue

**Pinnegar Hayward Design**  
 87 Carver Street  
 Birmingham  
 B1 3AL  
 Tel: 0121 236 7009  
 Email: design@p-h-d.co.uk  
 Web: www.p-h-d.co.uk

**Client**  
SHIRELAND INN LTD

**Project**  
RESIDENTIAL/COMMERCIAL DEVELOPMENT

**Location**  
THE COCKED HAT, SCUNTHORPE, DN15 8LQ

**Drawing Title**  
EXISTING SITE PLAN

<b>Project Number</b>	3610	<b>Drawing No.</b>	(10)002	<b>Revision</b>	D1
<b>Stage</b>	DESIGN				
<b>Scale</b>	1:100				
<b>Date</b>	OCT 25				
<b>Drawn</b>	KP				
<b>Checked</b>	SR				
<b>Sheet Number</b>	3610-PHD-X-XX-DR-A-(10)002				