

NOTES:

All dimensions & details given on this drawing are to be checked and verified on site prior to works being undertaken. Any discrepancies and/or variations to the specifications within these drawings or associated documents are to be notified to keystonearchitecture.

Do not scale from these drawings - if in doubt - ask.

All materials shall be fixed, applied or mixed in accordance with the manufacturers written instructions, recommendations and specifications. Variations to specified materials shall be agreed in writing with keystone architecture.

The Contractor shall take into account everything necessary for the proper execution of the works and to the satisfaction of the Local Authority, whether or not indicated on the drawings or in the specification.

This drawing is the copyright of keystone architecture and must not be reproduced without written consent. © keystone architecture 2020.

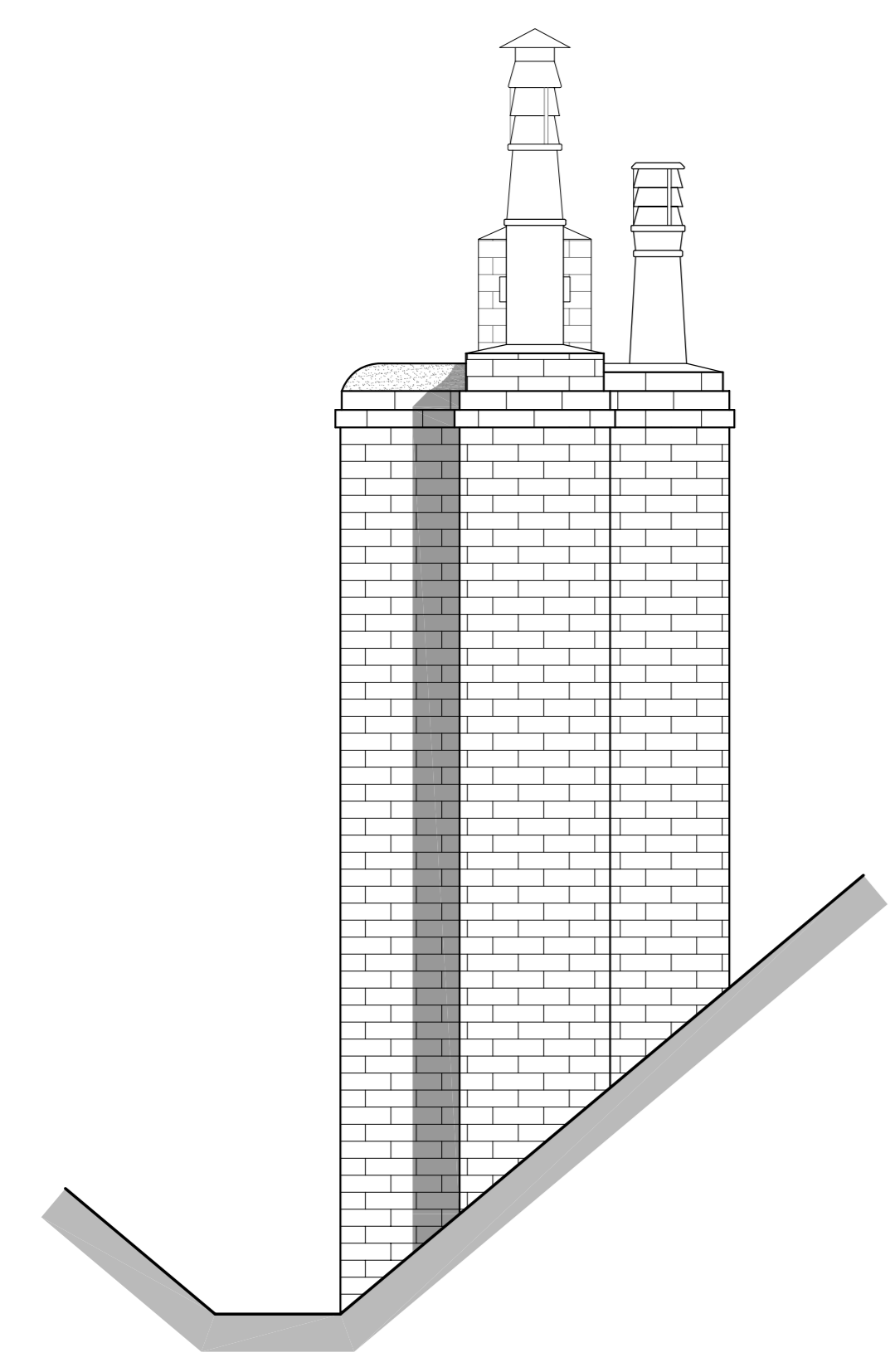

Existing Chimney 'A'
South Elevation

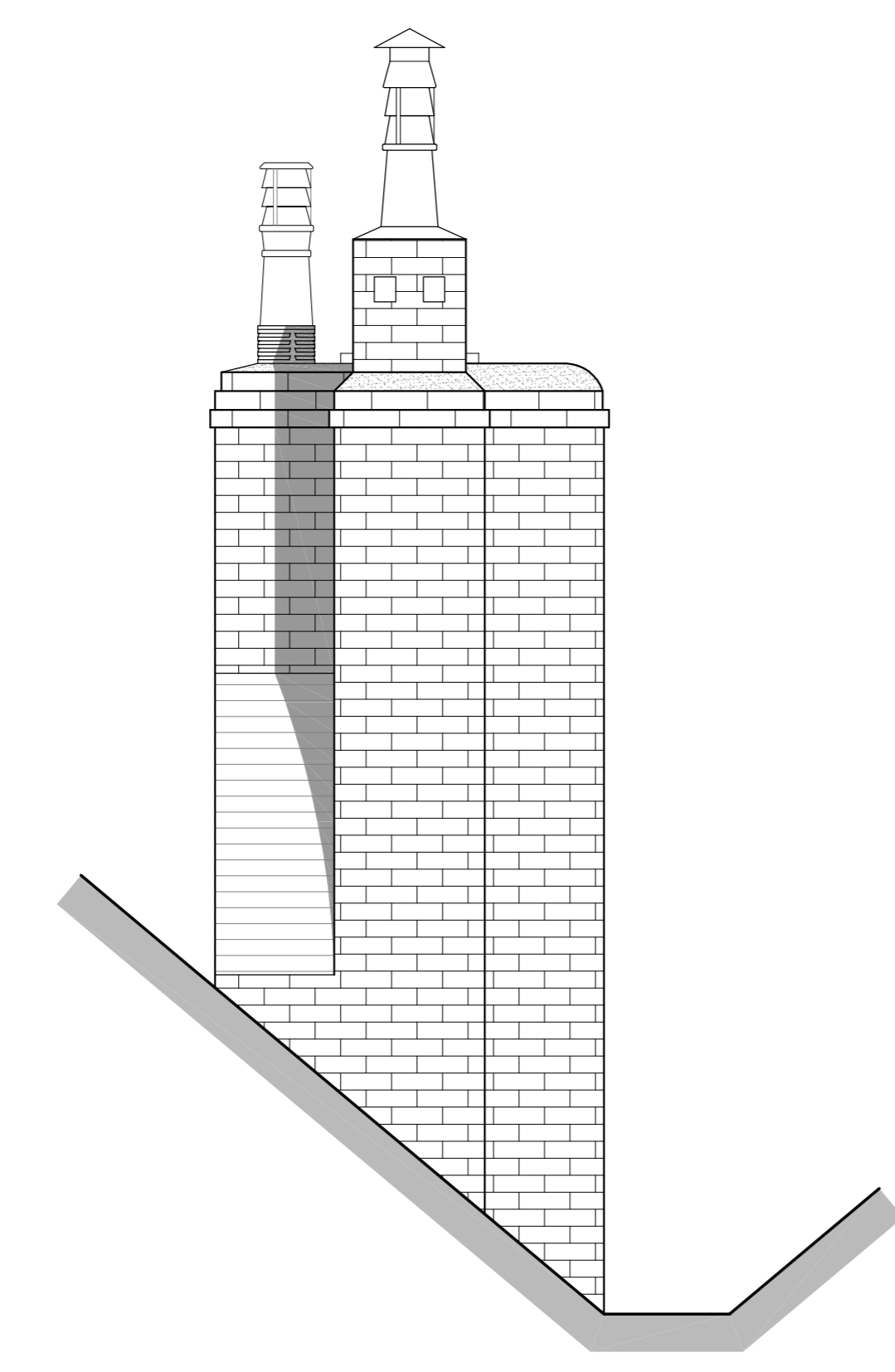

Existing Chimney 'A'
North Elevation

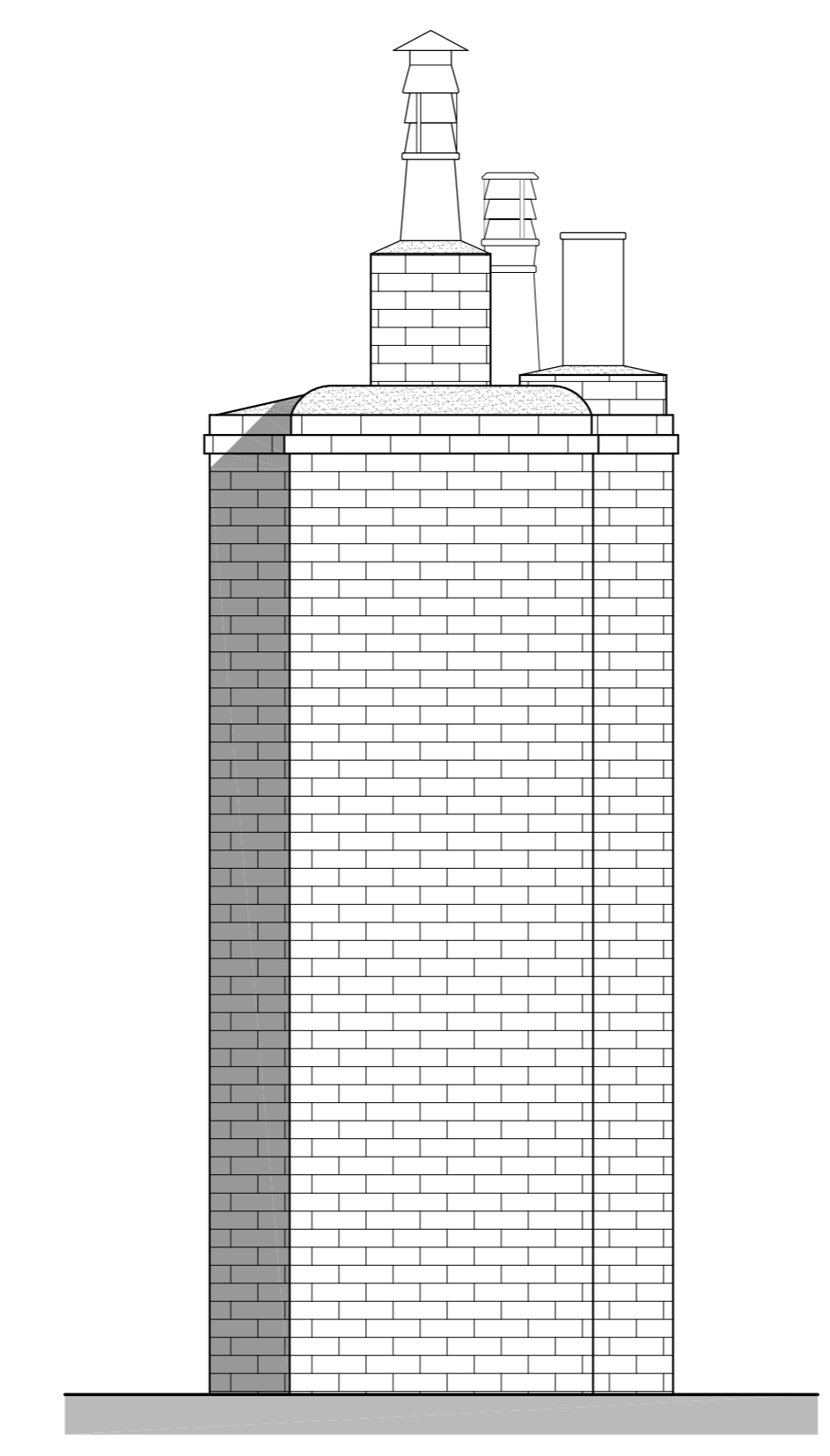

Existing Chimney 'A'
West Elevation

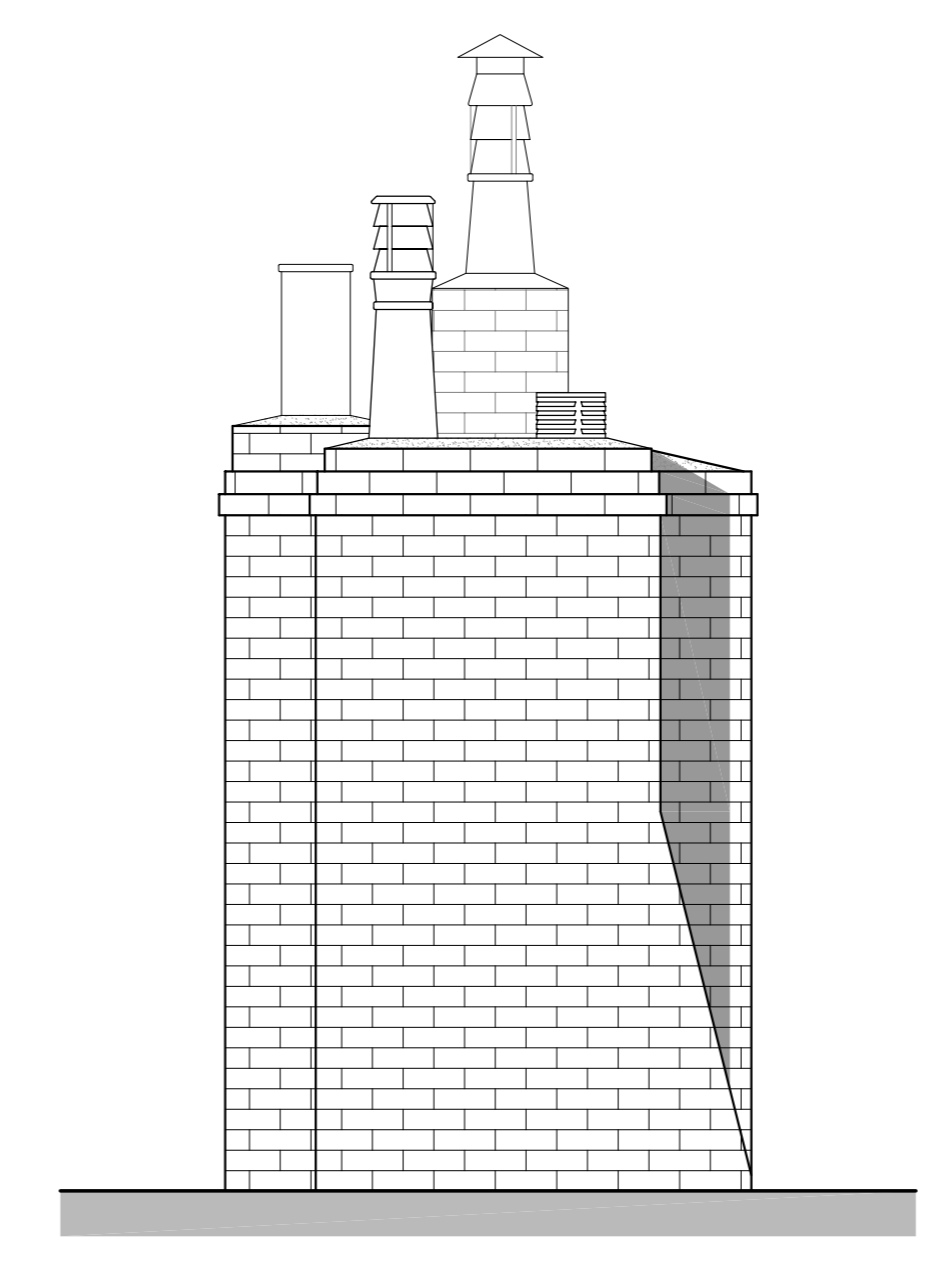

Existing Chimney 'A'
East Elevation

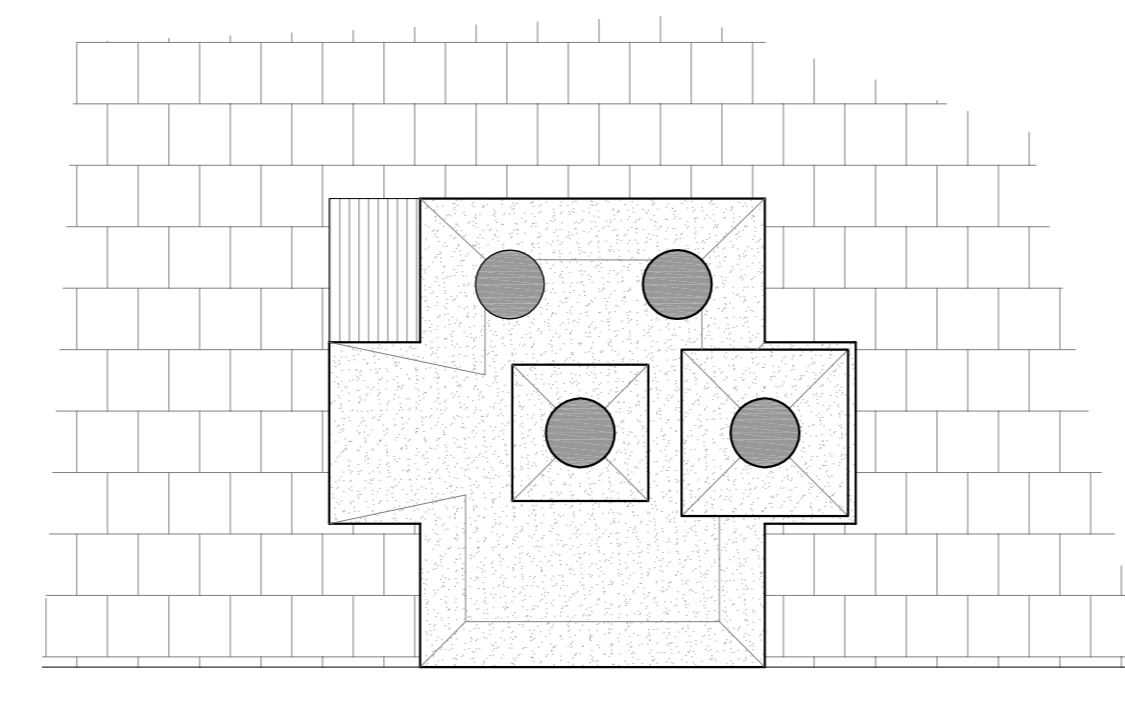

Existing Chimney 'A'
Plan

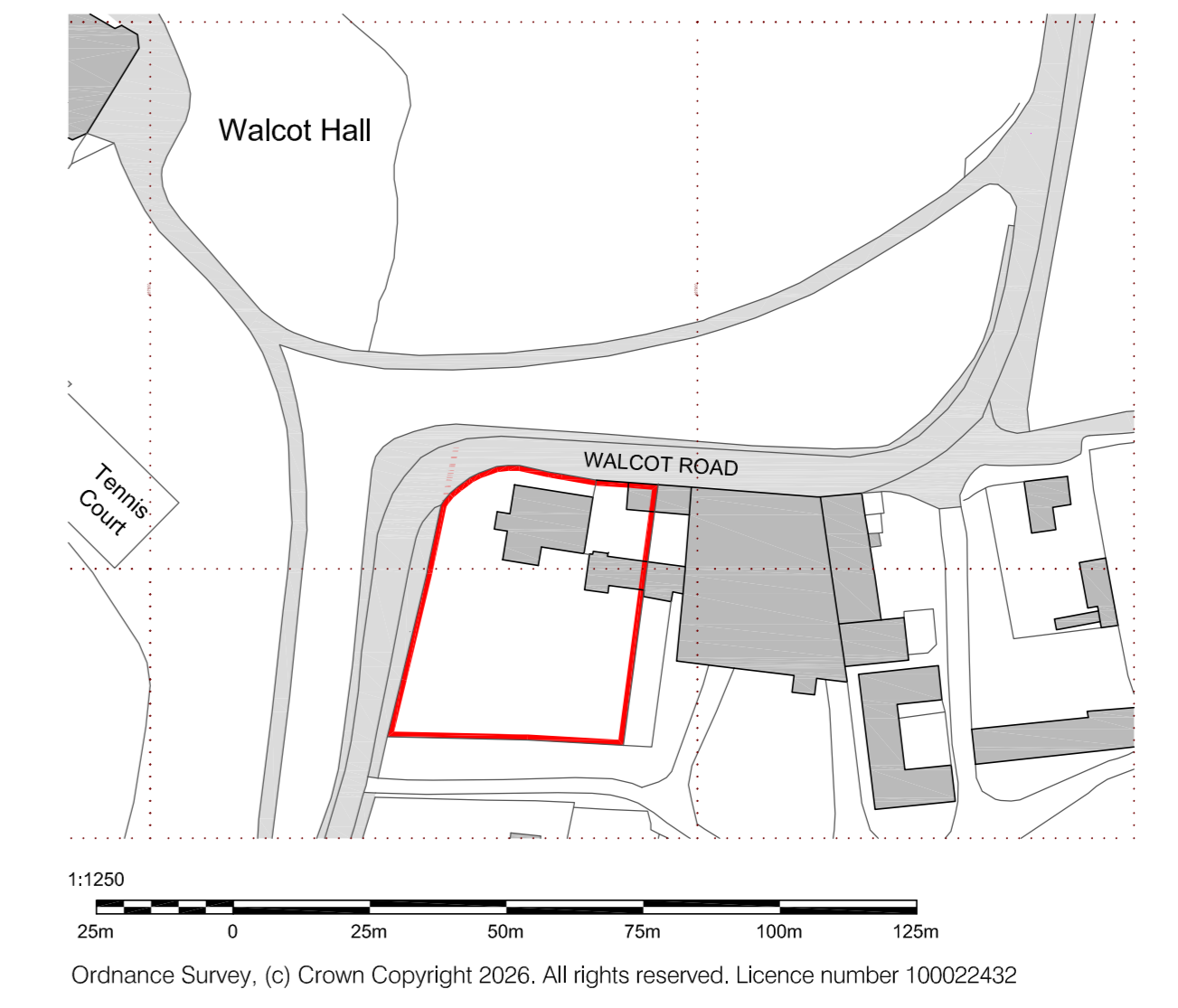

Location Plan
scale 1:1250

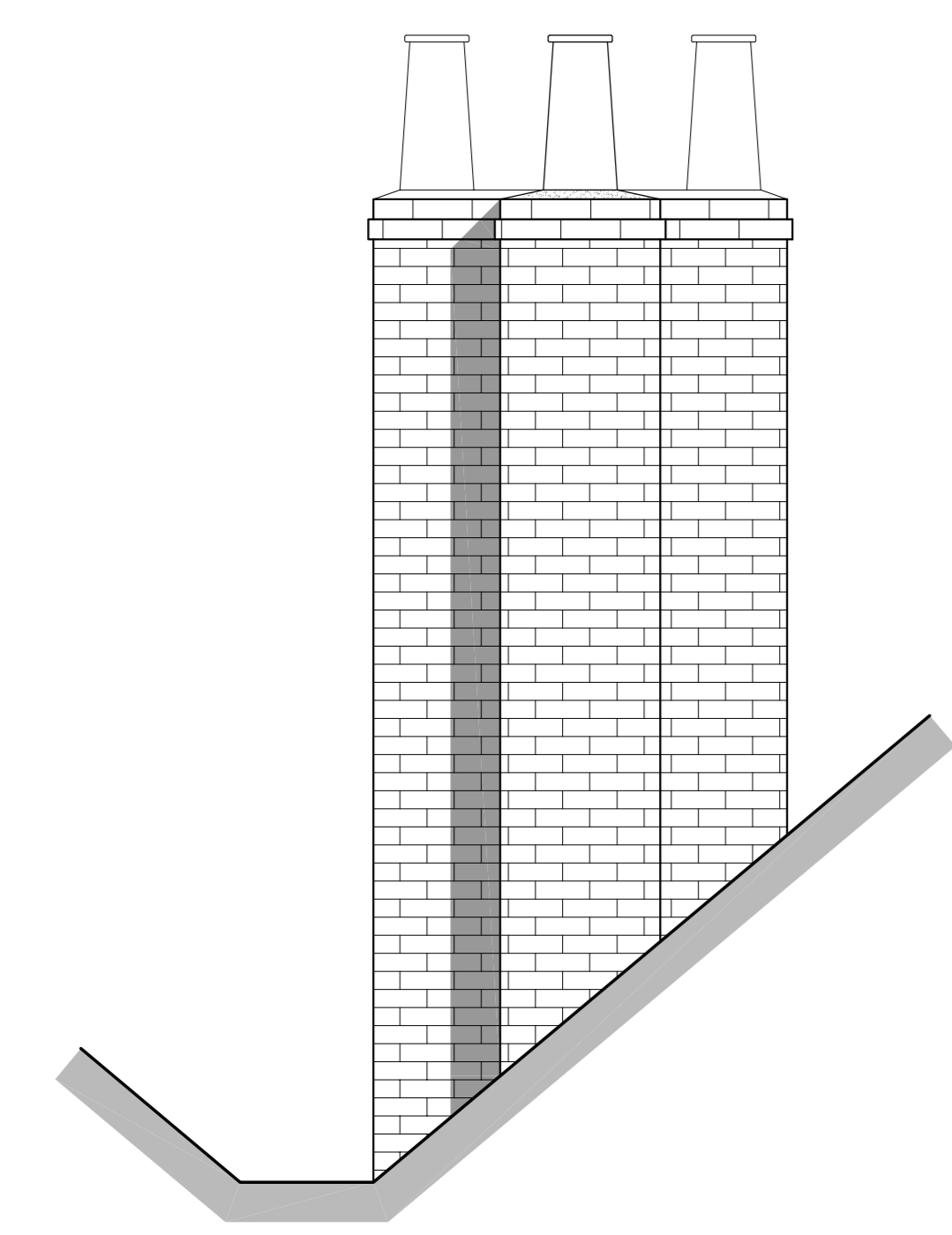

Proposed Chimney 'A'
South Elevation

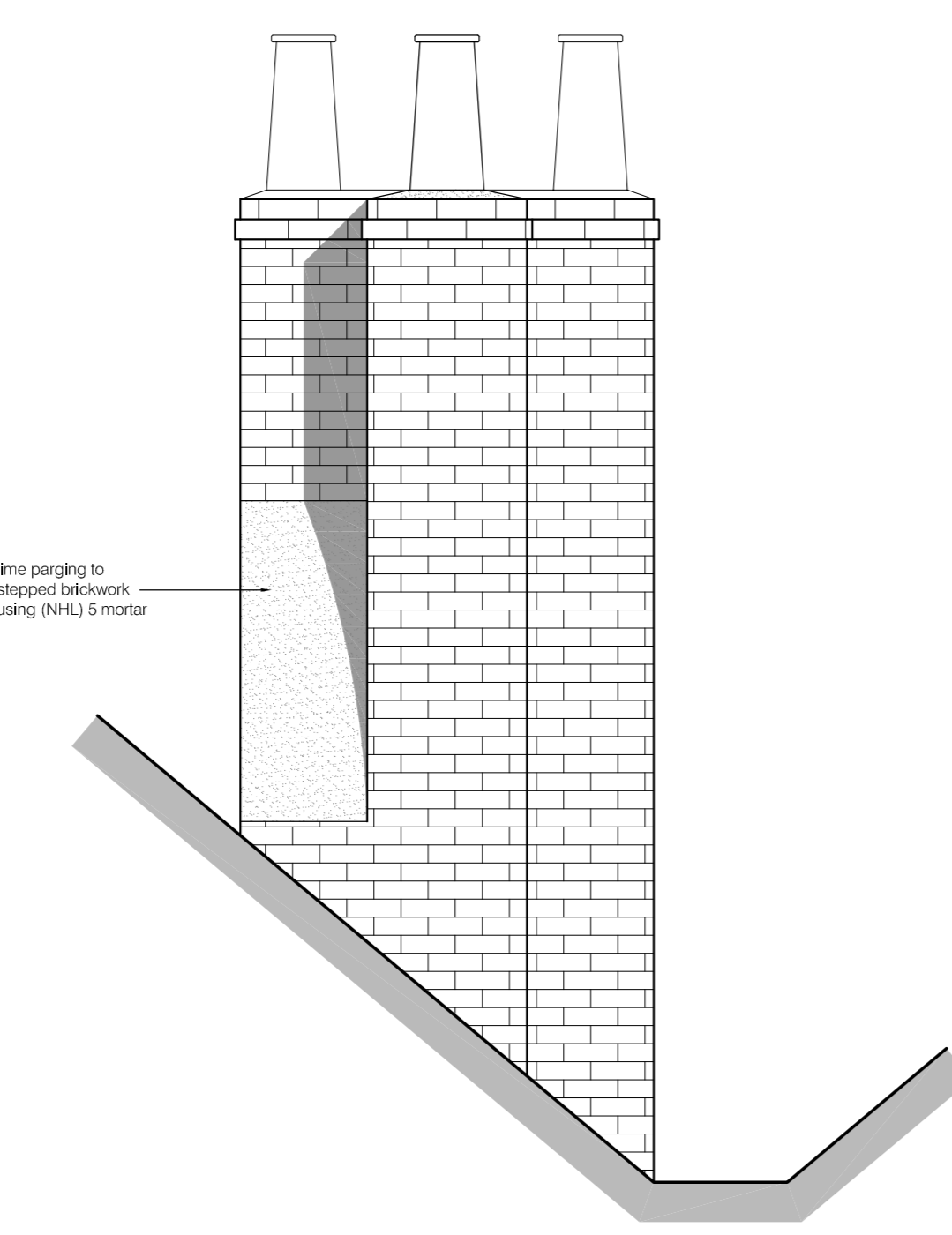

Proposed Chimney 'A'
North Elevation

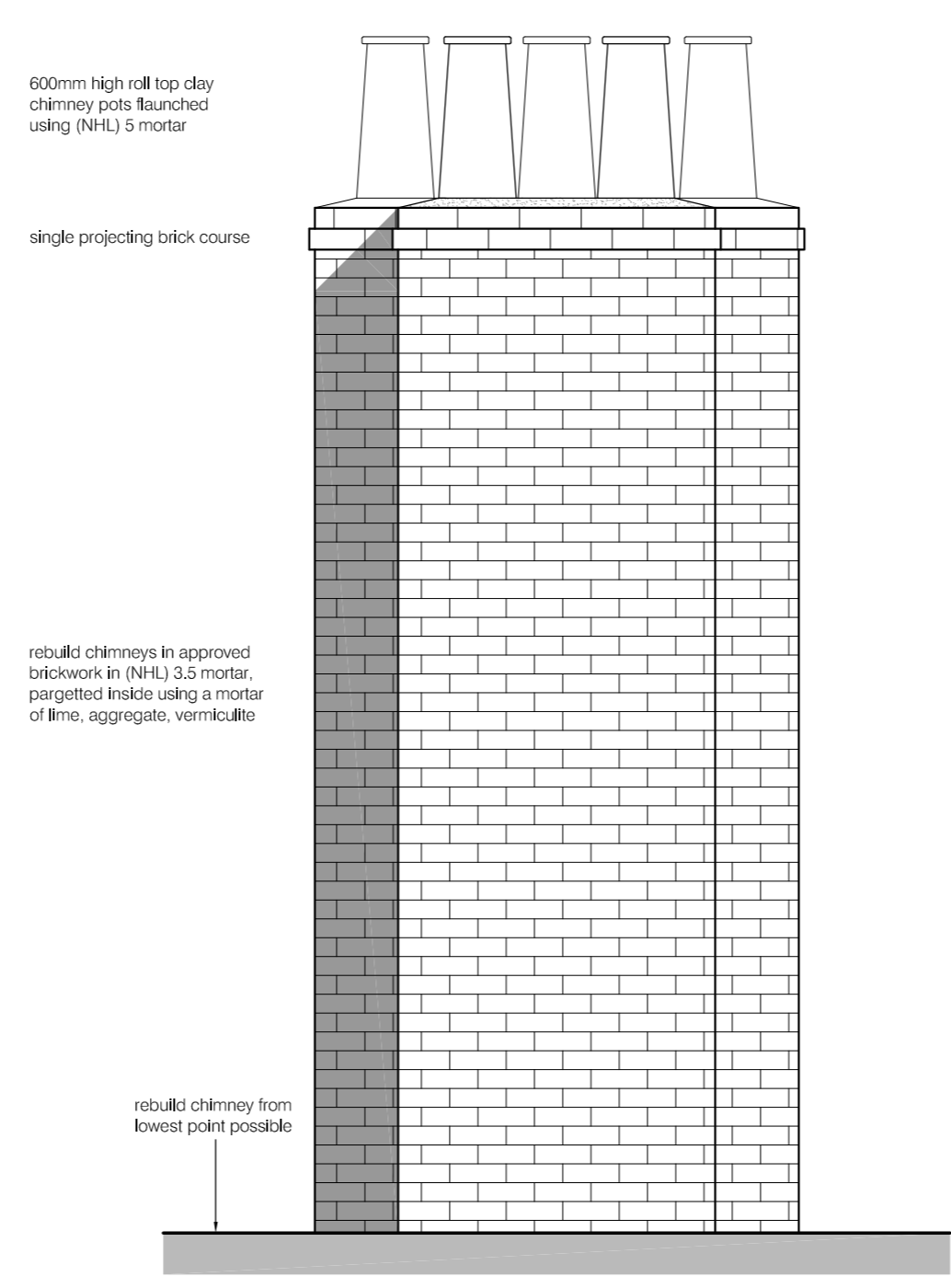

Proposed Chimney 'A'
West Elevation

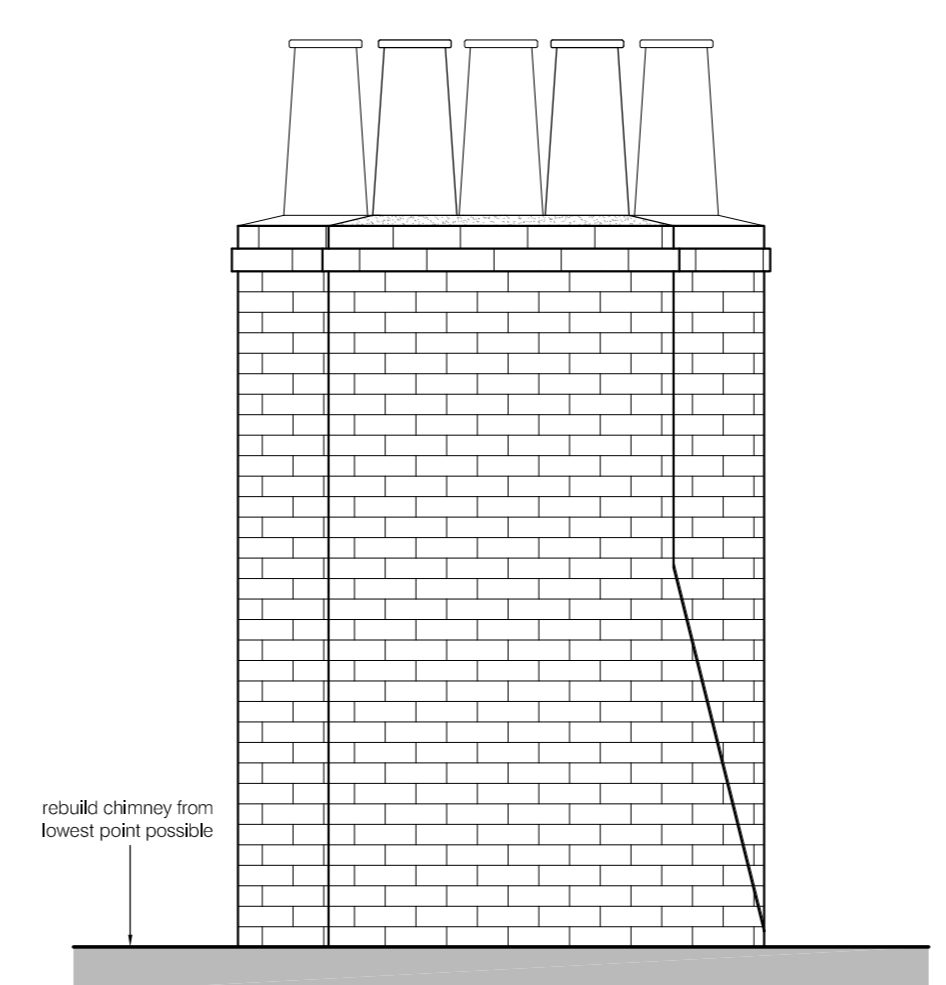

Proposed Chimney 'A'
East Elevation

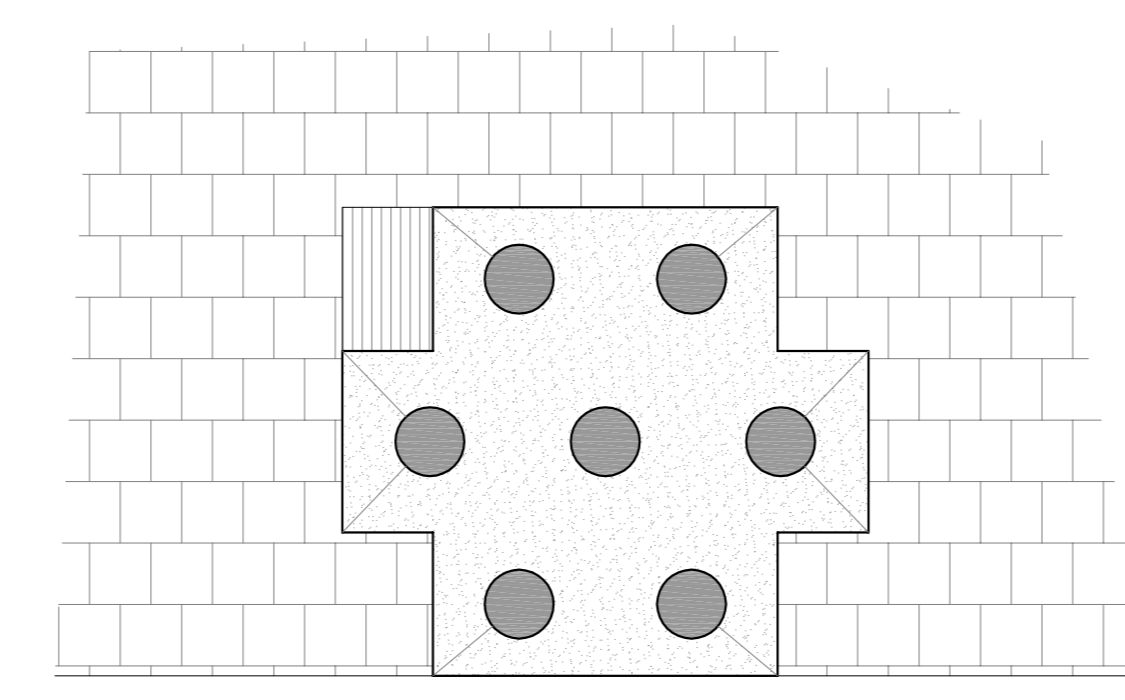

Proposed Chimney 'A'
Plan

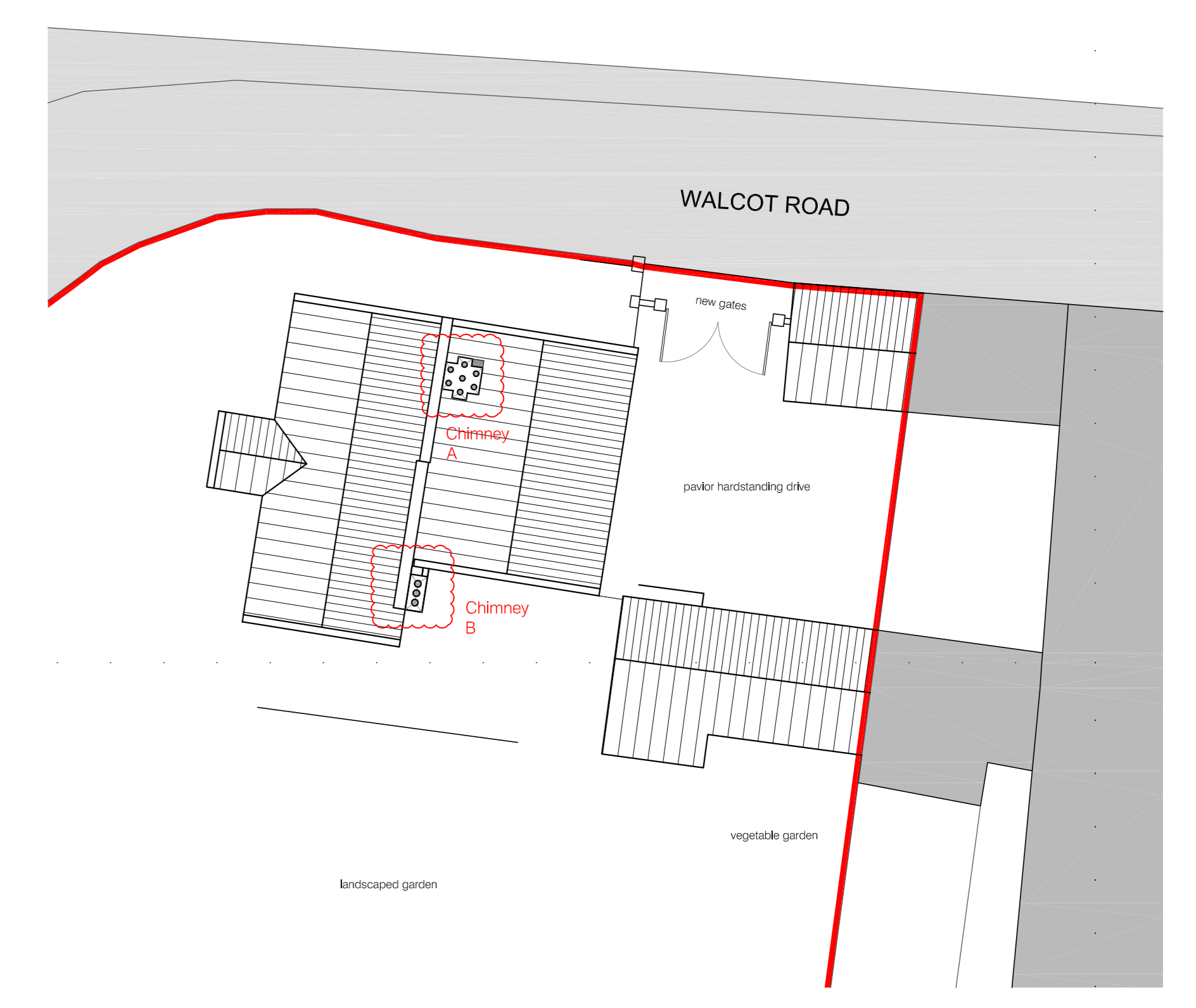

Site Plan
scale 1:200

PLANNING DRAWING ONLY

rev	amendment	date
1	Ex. & Pt. Chimney 'A'	22/09/22
2	Flue & LBC	Mar 26
3	scale 1:25 & 68 noted	drawn by JCB