

- NOTES:**
- THESE NOTES ARE INTENDED TO AUGMENT DRAWINGS AND SPECIFICATIONS. WHERE CONFLICT OF REQUIREMENTS EXIST THE ORDER OF PRECEDENCE SHALL BE AS SHOWN IN THE SPECIFICATION OTHERWISE THE STRICTEST PROVISION SHALL GOVERN.
  - THIS DRAWING IS TO BE READ IN CONJUNCTION WITH ALL OTHER RELEVANT ENGINEERS AND ARCHITECTS DRAWINGS.
  - DRAWINGS NOT TO BE SCALED. ALL DIMENSIONS TO BE CHECKED ON SITE BY THE CONTRACTOR. ANY DISCREPANCIES TO BE NOTIFIED TO THE ENGINEER AND FURTHER INSTRUCTIONS OBTAINED BEFORE WORK IS COMMENCED.
  - ALL DRAWINGS SHOULD BE READ IN CONJUNCTION WITH MCHW SPECIFICATION FOR HIGHWAY WORKS.
  - TACTILE PAVING TO BE LAID IN ACCORDANCE WITH DEPARTMENT OF TRANSPORT RECOMMENDATIONS AND APPENDIX 11/1.
  - BULSTER PATTERN TACTILE PAVING TO BE USED AT PEDESTRIAN CROSSINGS, RED COLOURED AT CONTROLLED CROSSINGS, BUFF COLOURED AT UNCONTROLLED CROSSINGS.
  - KERB TYPE K1 ARE TO BE LAID AT 100mm CHECK.
  - KERB TYPE K3 ARE TO BE LAID AT 0.6mm CHECK AT PEDESTRIAN CROSSING POINTS AND 25mm AT VEHICLE CROSSINGS.
  - ALL DRAWINGS SHOULD BE READ IN CONJUNCTION WITH MCHW SPECIFICATION FOR HIGHWAY WORKS.

- DISCLAIMER:**
- ALL DOCUMENTS ("DESIGNS") PREPARED BY THE CONSULTANT ARE CONFIDENTIAL TO THE CLIENT AND THEIR PROFESSIONAL ADVISERS. THEY MUST NOT BE SHARED, REPRODUCED, OR RELIED UPON BY THIRD PARTIES. THE CONSULTANT ACCEPTS NO LIABILITY FOR ANY USE BEYOND THE ORIGINAL INTENDED PURPOSE.
  - DESIGN DESIGN BASED ON TOPOGRAPHICAL SURVEY INFORMATION P-818-M18-078-003-001 P02 FEBRUARY 2017 AND M181 AS BUILT INFORMATION SEPTEMBER 2025.
  - THE CLIENT MAY REPRODUCE THE DESIGNS ONLY TO COMPLETE THE INTENDED PROJECT. THE CONSULTANT IS NOT LIABLE FOR ANY OTHER USE.
  - NEITHER PARTY MAY DISCLOSE CONFIDENTIAL BUSINESS INFORMATION WITHOUT CONSENT EXCEPT TO PROFESSIONAL ADVISERS/INSURERS, OR AS REQUIRED BY LAW.

- KEYLEGEND:**
- K1 - HALF BATTERED KERB
  - K2 - TRANSITION KERB
  - K3 - BULKHOSED KERB
  - K4 - EDGING KERB
  - K5 - CHANNEL BLOCK
  - K6 - REVERSED BULKHOSED KERB
  - BUFF - BUFF TACTILE PAVING
  - FRM - BUFF FRAME TACTILE PAVING
  - FW1 - FOOTWAY CONSTRUCTION
  - FW2 - FOOTWAY CONSTRUCTION

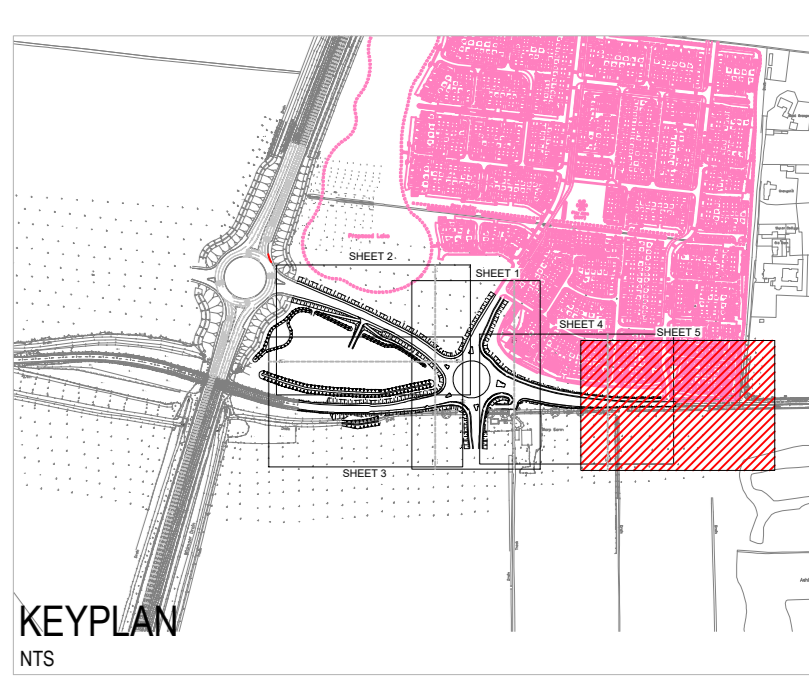

|                  |             |      |     |     |
|------------------|-------------|------|-----|-----|
| P02 FOR APPROVAL | 27.03.25    | BH   | JEK | BH  |
| P01 FIRST ISSUE  | 06.03.25    | HD   | JEK | BH  |
| Rev              | Description | Date | By  | App |

**Alan Wood & Partners**  
www.alanwood.co.uk

**Locations:**  
Hull  
Leeds  
Lincoln  
Scarborough  
Sheffield  
Stockton-on-Tees  
York

**Issuing Office:**  
York Office  
Omega 2  
Monks Cross Drive  
York  
YO32 9GZ  
eng@alanwood.co.uk  
T. 01904 611594

**JOB NO. 53335: NLC M181 SOUTHERN JUNCTION - PHASE 2 B1450 SPUR AND EAST ROUNDABOUT (TEMPORARY PHASE) DRAWING REFERENCE TABLE**

| DOCUMENT TITLE          | DOCUMENT REFERENCE           | DOCUMENT TITLE                          | DOCUMENT REFERENCE                       |
|-------------------------|------------------------------|---|--|
| SITE LAYOUT             | SER-AWP-ZZ-01-DR-C-3001-3002 | DRAINAGE                                | SER-AWP-ZZ-05-DC-3101-3122               |
| VEHICLE TRACKING        | SER-AWP-ZZ-01-DR-C-3010-3015 | EARTHWORKS                              | SER-AWP-ZZ-06-DR-C-3001-3002 & 3001      |
| ALIGNMENTS AND PROFILES | SER-AWP-ZZ-01-DR-C-3020-3026 | PAVEMENT                                | SER-AWP-ZZ-07-DR-C-3001-3002 & 3001      |
| CONTOUR PLAN            | SER-AWP-ZZ-01-DR-C-3030-3031 | KERBS AND FOOTWAYS                      | SER-AWP-ZZ-11-DR-C-3001-3005 & 3001      |
| CROSS SECTIONS          | SER-AWP-ZZ-01-DR-C-3041-3046 | ROAD MARKINGS                           | SER-AWP-ZZ-12-DR-C-3001-3002             |
| H&S RISKS               | SER-AWP-ZZ-01-DR-C-3050-3051 | TRAFFIC SIGN & FOUNDATION DETAILS       | SER-AWP-ZZ-12-DR-C-3011-3012 & 3001-3002 |
| ISOPACHYTE              | SER-AWP-ZZ-01-DR-C-3060-3061 | HIGHWAY LIGHTING                        | SER-BLDS-ZZ-13-D-C-1301-1302             |
| SITE CLEARANCE          | SER-AWP-ZZ-02-DR-C-3001-3002 | ELECTRICAL SCHEMATIC & STANDARD DETAILS | SER-BLDS-ZZ-14-D-C-1401-1406             |
| FENCING                 | SER-AWP-ZZ-03-DR-C-3001-3002 | LANDSCAPING                             | SER-BRD-ZZ-01-DL-0001-0002 & 9005        |
| ROAD RESTRAINT SYSTEMS  | SER-AWP-ZZ-04-DR-C-3001-3002 | HIGHWAY SPECIFICATION                   | SER-AWP-ZZ-XX-6P-C-3101                  |



Project: **BURRINGHAM ROAD - EASTERN ROUNDABOUT DESIGN**

Client: **NORTH LINCOLNSHIRE COUNCIL**

Drawing: **KERBING AND FOOTWAYS (TEMPORARY) - SHEET 5**

Rev: **CIVIL ENGINEER**

|                 |                        |                 |                        |
|-----------------|------------------------|-----------------|------------------------|
| Drawing Status: | <b>FOR APPROVAL</b>    | Submittal Code: | <b>S3</b>              |
| Job no:         | <b>53335</b>           | Scale:          | <b>1 : 250</b>         |
| Rev:            | <b>P02</b>             | Project:        | <b>Burringham Road</b> |
| Drawn:          | <b>CIVIL ENGINEER</b>  | Issue:          | <b>06.03.25</b>        |
| Checked:        | <b>CIVIL ENGINEER</b>  | Level:          | <b>DR</b>              |
| Project:        | <b>Burringham Road</b> | Type:           | <b>DR</b>              |
| Issue:          | <b>06.03.25</b>        | Risk:           | <b>Low</b>             |
| Level:          | <b>DR</b>              | Number:         | <b>3005</b>            |
| Type:           | <b>DR</b>              |                 |                        |
| Risk:           | <b>Low</b>             |                 |                        |
| Number:         | <b>3005</b>            |                 |                        |