

NORTHERN ARM - LONGSECTION
SCALE: H 1:200, V 1:200, DATUM: 2.000

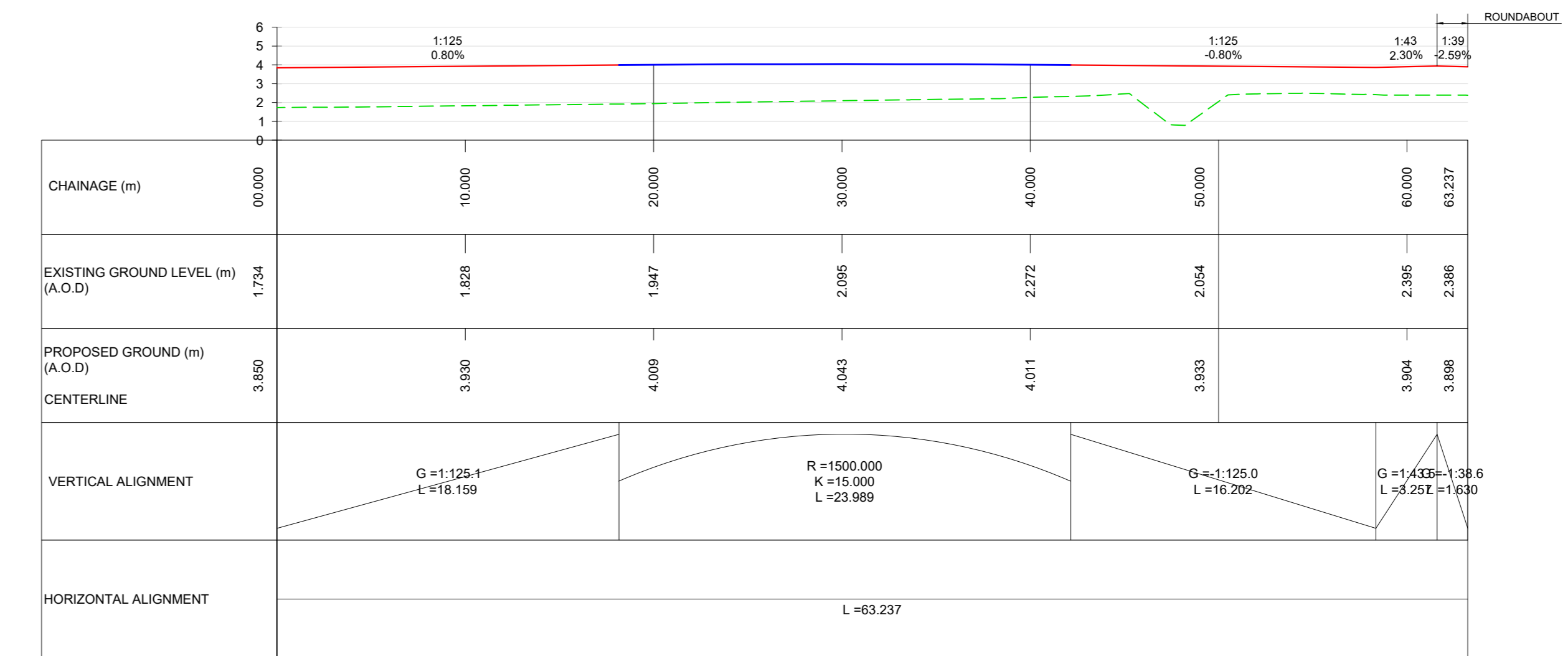

SOUTHERN ARM - LONGSECTION
SCALE: H 1:200, V 1:200, DATUM: 0.000

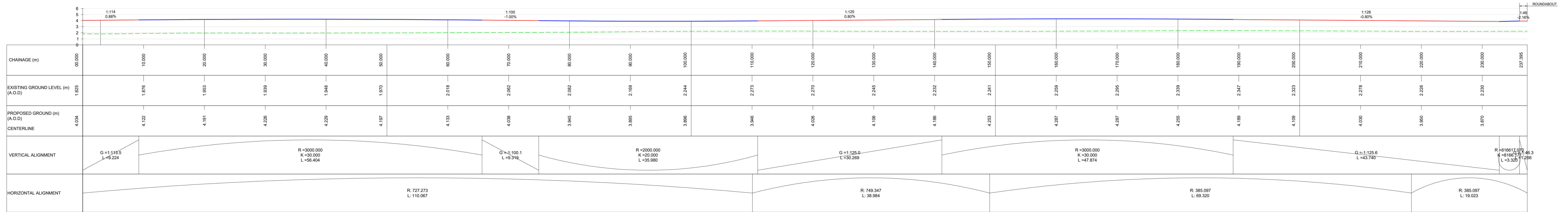

NORTH-WESTERN ARM - LONGSECTION
SCALE: H 1:200, V 1:200, DATUM: 0.000

- NOTES:**
- THESE NOTES ARE INTENDED TO AUGMENT DRAWINGS AND SPECIFICATIONS. WHERE CONFLICT OF REQUIREMENTS EXIST THE ORDER OF PRECEDENCE SHALL BE AS SHOWN IN THE SPECIFICATION, OTHERWISE THE STRICTEST PROVISION SHALL GOVERN.
 - THIS DRAWING IS TO BE READ IN CONJUNCTION WITH ALL OTHER RELEVANT ENGINEERS AND ARCHITECTS DRAWINGS.
 - DRAWINGS NOT TO BE SCALED. ALL DIMENSIONS TO BE CHECKED ON SITE BY THE CONTRACTOR. ANY DISCREPANCIES TO BE NOTIFIED TO THE ENGINEER AND FURTHER INSTRUCTIONS OBTAINED BEFORE WORK IS COMMENCED.
 - ALL DRAWINGS SHOULD BE READ IN CONJUNCTION WITH MCHW SPECIFICATION FOR HIGHWAY WORKS.

- DISCLAIMER:**
- ALL DOCUMENTS ("DESIGNS") PREPARED BY THE CONSULTANT ARE CONFIDENTIAL TO THE CLIENT AND THEIR PROFESSIONAL ADVISERS. THEY MUST NOT BE SHARED, REPRODUCED, OR RELIED UPON BY THIRD PARTIES. THE CONSULTANT ACCEPTS NO LIABILITY FOR ANY USE BEYOND THE ORIGINAL INTENDED PURPOSE.
 - THE CLIENT MAY REPRODUCE THE DESIGNS ONLY TO COMPLETE THE INTENDED PROJECT. THE CONSULTANT IS NOT LIABLE FOR ANY OTHER USE.
 - NEITHER PARTY MAY DISCLOSE CONFIDENTIAL BUSINESS INFORMATION WITHOUT CONSENT EXCEPT TO PROFESSIONAL ADVISERS, INSURERS, OR AS REQUIRED BY LAW.

KEY / LEGEND:

— PROPOSED DESIGN PROFILE

--- EXISTING GROUND LEVEL

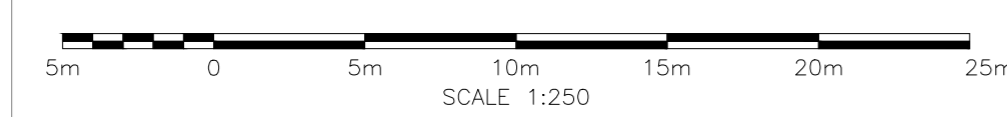

JOB NO. 53335: NLC M181 SOUTHERN JUNCTION - PHASE 2 B1450 SPUR AND EAST ROUNDABOUT (TEMPORARY PHASE) DRAWING REFERENCE TABLE			
DOCUMENT TITLE	DOCUMENT REFERENCE	DOCUMENT TITLE	DOCUMENT REFERENCE
SITE LAYOUT	SER-AWP-ZZ-01-DR-C-3001-3002	DRAINAGE	SER-AWP-ZZ-05-DR-C-3101-3122
VEHICLE TRACKING	SER-AWP-ZZ-01-DR-C-3010-3015	EARTHWORKS	SER-AWP-ZZ-06-DR-C-3001-3002 & 3201
ALIGNMENTS AND PROFILES	SER-AWP-ZZ-01-DR-C-3020-3026	PAVEMENT	SER-AWP-ZZ-07-DR-C-3001-3002 & 3201
CONTOUR PLAN	SER-AWP-ZZ-01-DR-C-3030-3031	KERBS AND FOOTWAYS	SER-AWP-ZZ-11-DR-C-3001-3005 & 3201
CROSS SECTIONS	SER-AWP-ZZ-01-DR-C-3041-3046	ROAD MARKINGS	SER-AWP-ZZ-12-DR-C-3001-3002
H&S RISKS	SER-AWP-ZZ-01-DR-C-3050-3051	TRAFFIC SIGN & FOUNDATION DETAILS	SER-AWP-ZZ-12-DR-C-3010-3011 & 3201-3202
ISOPACHYTE	SER-AWP-ZZ-01-DR-C-3060-3061	HIGHWAY LIGHTING	SER-SLDS-ZZ-13-D-C-1301-1302
SITE CLEARANCE	SER-AWP-ZZ-02-DR-C-3001-3002	ELECTRICAL SCHEMATIC & STANDARD DETAILS	SER-SLDS-ZZ-14-D-C-1401-1406
FENCING	SER-AWP-ZZ-03-DR-C-3001-3002	LANDSCAPING	SER-BRD-ZZ-01-D-L-9001-9002 & 9005
ROAD RESTRAINT SYSTEMS	SER-AWP-ZZ-04-DR-C-3001-3002	HIGHWAY SPECIFICATION	SER-AWP-ZZ-XXX-SP-C-3101

P02 FOR APPROVAL	27.03.26	HD	JEX	BH
P01 FIRST ISSUE	06.03.26	FM	JEX	BH
Rev	Description	Date	By	Chk

Alan Wood & Partners

Locations:
Hull
Leeds
Lincoln
Scarborough
Sheffield
Stockton-on-Tees
York

Engineer / Manage / Deliver /

Issuing Office:
York Office
Ormsley 2
Morris Cross Drive
York
YO32 9GZ

eng@alanwood.co.uk
T. 01904 61594

Project: M181 SOUTHERN JUNCTION - PHASE 2 B1450 SPUR AND EAST ROUNDABOUT

Client: NORTH LINCOLNSHIRE COUNCIL

Drawing: PROFILES (TEMPORARY PHASE) SHEET 1

Rev: CIVIL ENGINEER

Drawing Status: FOR APPROVAL

Job no. 53335 Scale: 1:250

Project Originator: Zone Level Type Risk Number

SER - AWP - ZZ - 01 - DR - C - 3025

Subsity Code: S4

Rev: P02