

- KEY:**
- PROPOSED 8M TUBULAR STEEL LIGHTING COLUMN COMPLETE WITH 0.5M OUTREACH BRACKET AND PHILIPS LUMA 1 DW50 NW 13KLM 74W LUMINAIRE.
 - PROPOSED 8M TUBULAR STEEL LIGHTING COLUMN COMPLETE WITH 0.5M OUTREACH BRACKET AND PHILIPS LUMA 1 DW50 NW 20KLM 119W LUMINAIRE.
 - PROPOSED 8M TUBULAR STEEL LIGHTING COLUMN COMPLETE WITH 0.5M OUTREACH BRACKET AND PHILIPS LUMA 1 DW10 NW 13KLM 74W LUMINAIRE.
 - PROPOSED 10M TUBULAR STEEL LIGHTING COLUMN COMPLETE WITH 0.5M OUTREACH BRACKET AND PHILIPS LUMA 2 DW10 NW 27KLM 160W LUMINAIRE.
 - PROPOSED 12M TUBULAR STEEL LIGHTING COLUMN COMPLETE WITH 0.5M OUTREACH BRACKET AND PHILIPS LUMA 2 DW10 NW 27KLM 160W LUMINAIRE.
 - PROPOSED 5M TUBULAR STEEL LIGHTING COLUMN COMPLETE WITH POST TOP MOUNTED PHILLIPS LUMA MICRO DW50 LANTERN NW 1.4KLM 9W LUMINAIRE.
 - PROPOSED 10M TUBULAR STEEL LIGHTING COLUMN COMPLETE WITH 0.5M OUTREACH BRACKET AND PHILIPS LUMA 1 DW50 NW 20KLM 119W LUMINAIRE.
 - PROPOSED 10M TUBULAR STEEL LIGHTING COLUMN COMPLETE WITH 0.5M OUTREACH BRACKET AND PHILIPS LUMA 1 DW50 NW 13KLM 74W LUMINAIRE.
 - PROPOSED 12M PASSIVELY SAFE ALUMINIUM LIGHTING COLUMN OF TYPE 100.NE:3 WITH 0.5M OUTREACH BRACKET AND PHILIPS LUMA 2 DW10 NW 27 KLM 160W LUMINAIRE
 - EXISTING LIGHTING COLUMN TO REMAIN
 - 1L 100MM ORANGE FLEXI-DUCTS (STREETLIGHTING - NUMBER AS SHOWN)
 - 2L 50MM ORANGE FLEXI-DUCT (STREETLIGHTING)
 - PROPOSED FEEDER PILLAR. REFER TO STANDARD DETAILS.
 - PROPOSED DUCT ACCESS CHAMBER. REFER TO STANDARD DETAILS.
 - PROPOSED EARTH ELECTRODE.

- NOTES:**
1. DUCT RUNS, CHAMBERS AND LIGHTING COLUMN LOCATIONS ARE INDICATIVE. EXACT LOCATIONS ARE TO BE DECIDED FOLLOWING ASSESSMENT OF SITE CONDITIONS AND EXISTING UNDERGROUND APPARATUS.
 2. EXISTING STATUTORY UNDERTAKERS APPARATUS IS SHOWN ON DRAWING NOS. LLHI-AWP-01-01-DR-D-0101 TO 0105.
 3. FOR ROAD RESTRAINT SYSTEMS LAYOUT SEE DWG. NOS. LLHI-AWP-01-04-DR-D-0001 TO 0005.
 4. FOR SIGNAGE LAYOUT INFORMATION SEE DWG. NOS. LLHI-AWP-01-12-DR-D-0001 TO 0011.

Rev	Description	Date	By	Chk	App
P01	FOR TENDER	09.11.20	SD	LS	RL

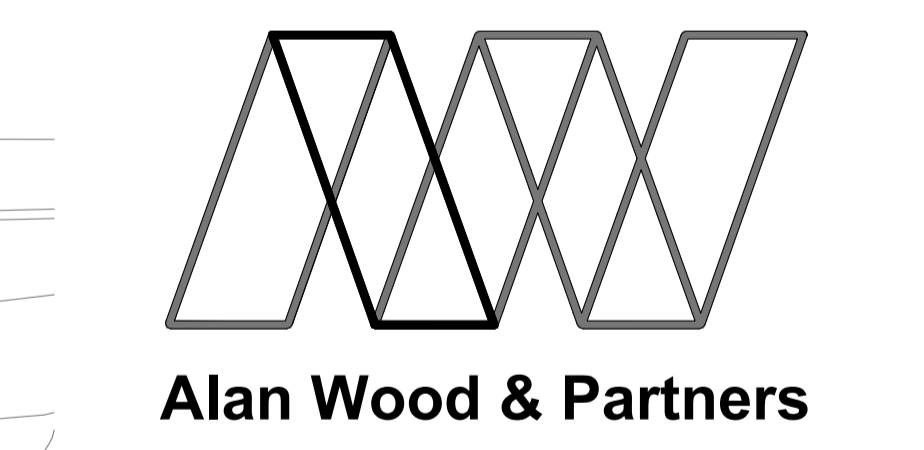
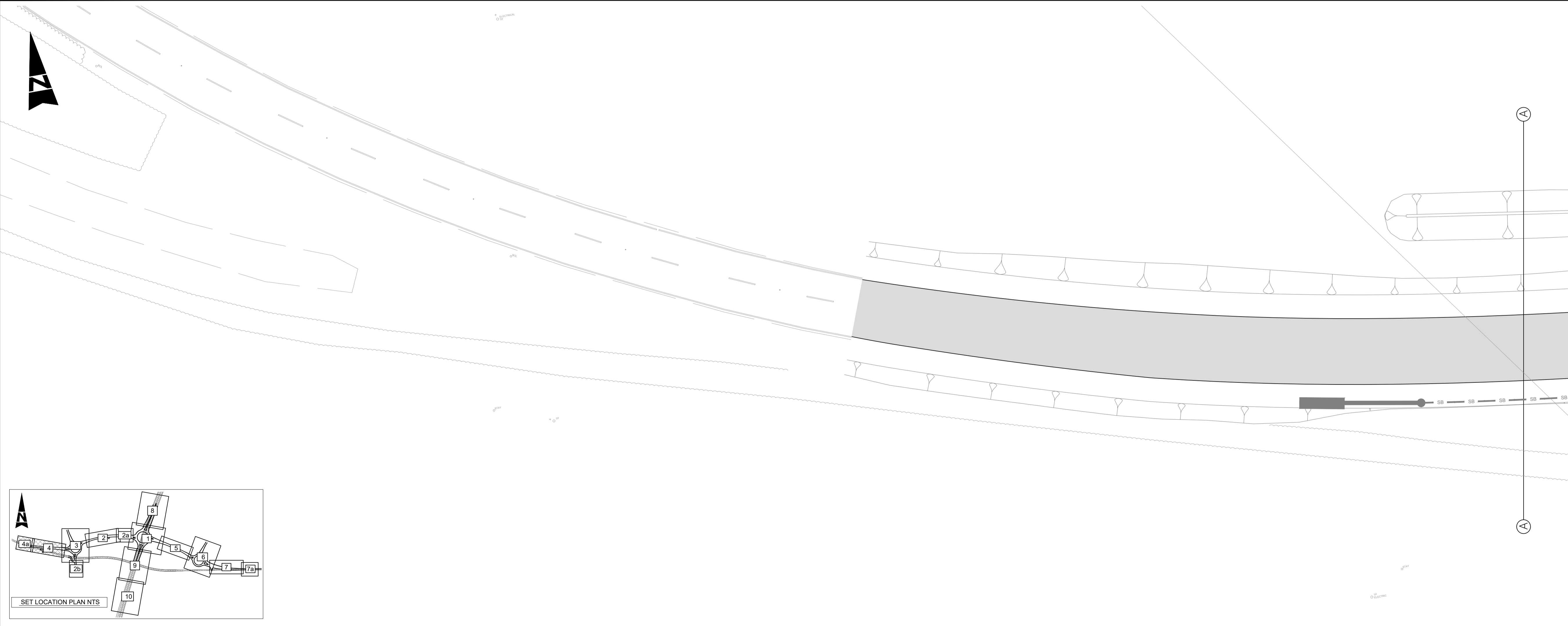

York Office
 Omega 2
 Monks Cross Drive
 York
 YO32 9GZ

Consulting Civil & Structural Engineers
Project Managers
Building Surveyors

Hull T. 01462 442138
 Lincoln T. 01522 300210
 London T. 02071 860761
 Scarborough T. 01723 865484
 Sheffield T. 01142 440077
 Leeds T. 01135 311098

T. 01904 611594
 www.alanwood.co.uk

Project: LINCOLNSHIRE LAKES, SCUNTHORPE
 M181/B1450 HIGHWAY WORKS



Client: MALTGRADE

Drawing: PROPOSED LIGHTING AND DUCTING SHEET 4

Role: CIVIL ENGINEER

Drawing Status: FOR TENDER

Job no. 43972 Scale@ A1: 1:250 Rev. P01

Project Originator Volume Level Type Role Number
 LLHI - AWP - 01 - 05 - DR - D - 0204

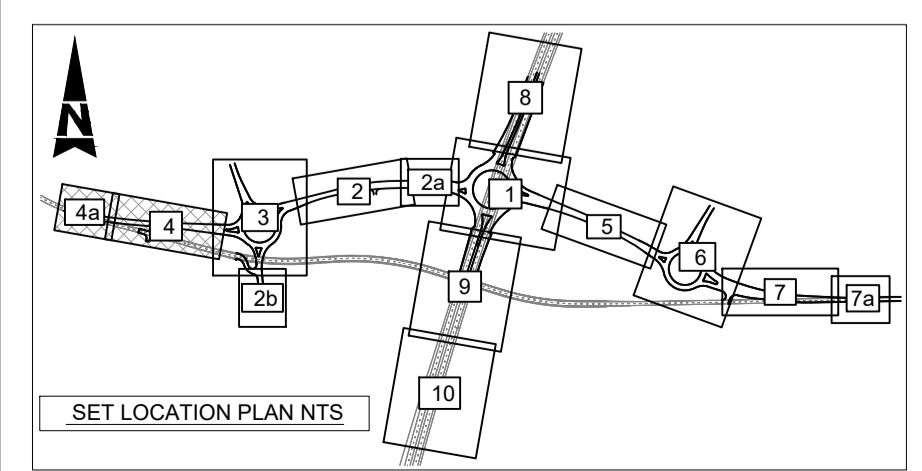

100mm at A1