

C Roundabout - CL - N Arm - Ch.0.00m

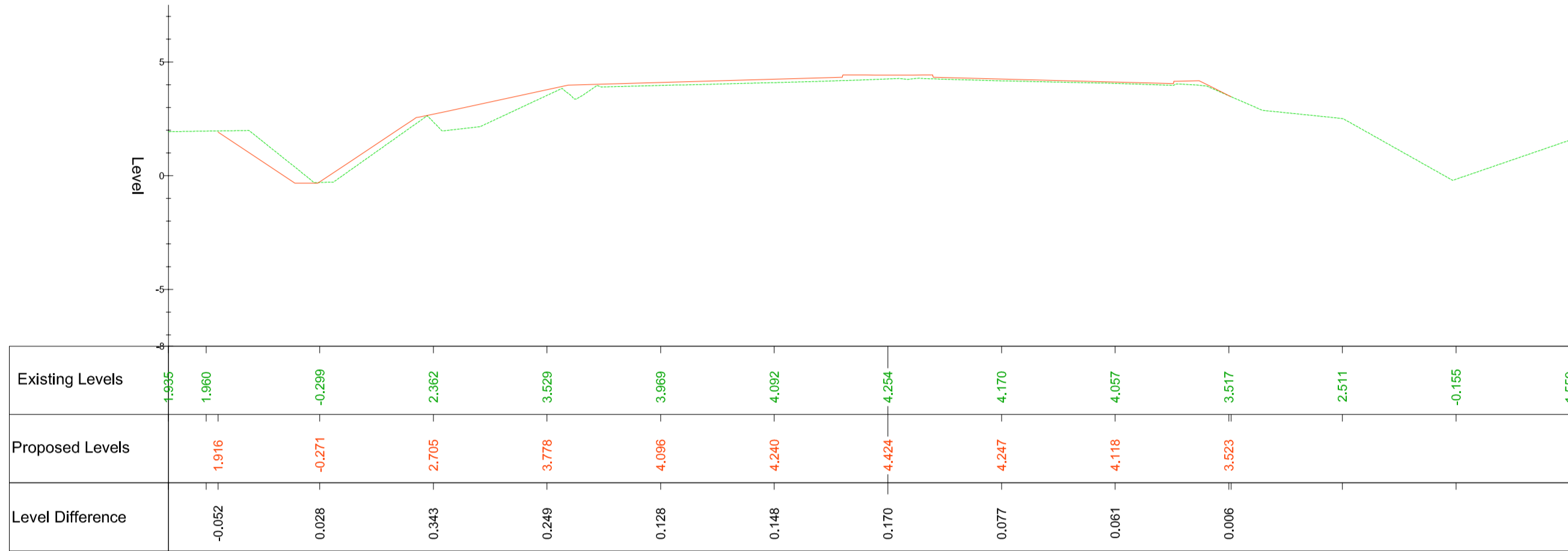

C Roundabout - CL - N Arm - Ch.20.00m

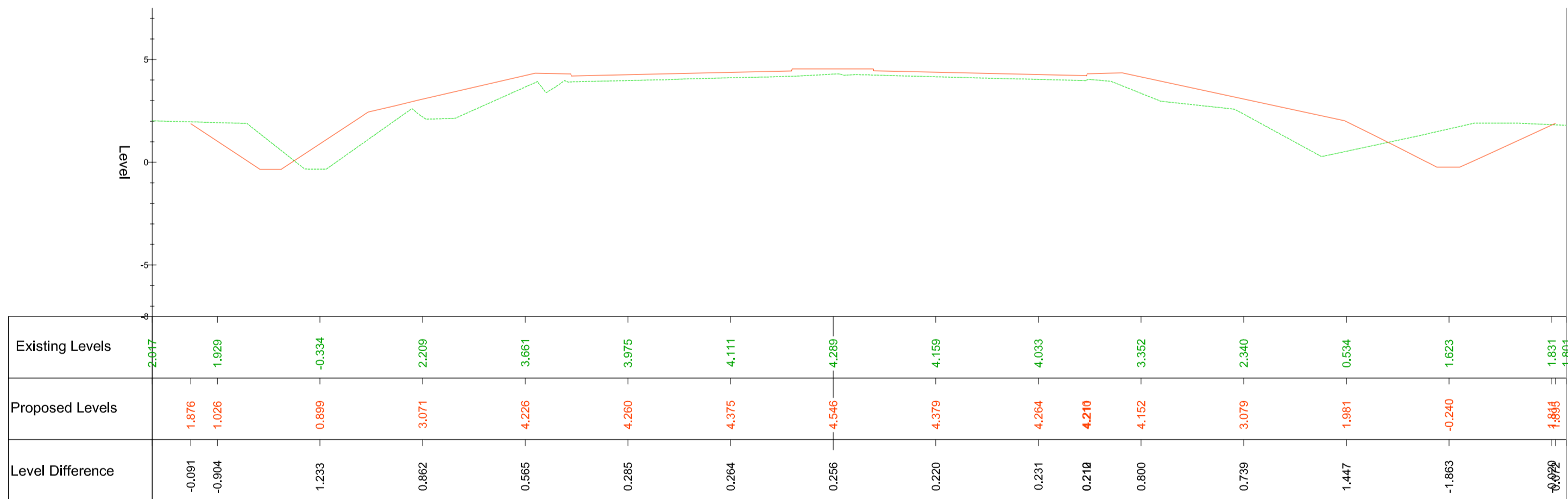

C Roundabout - CL - N Arm - Ch.40.00m

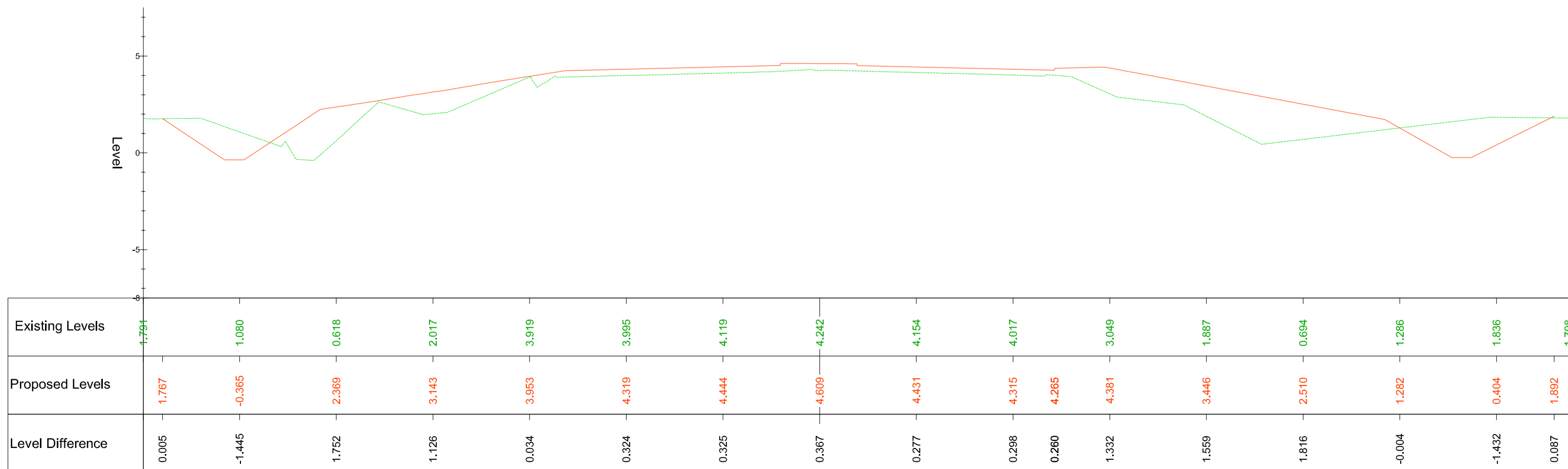

C Roundabout - CL - N Arm - Ch.60.00m

100mm at A1

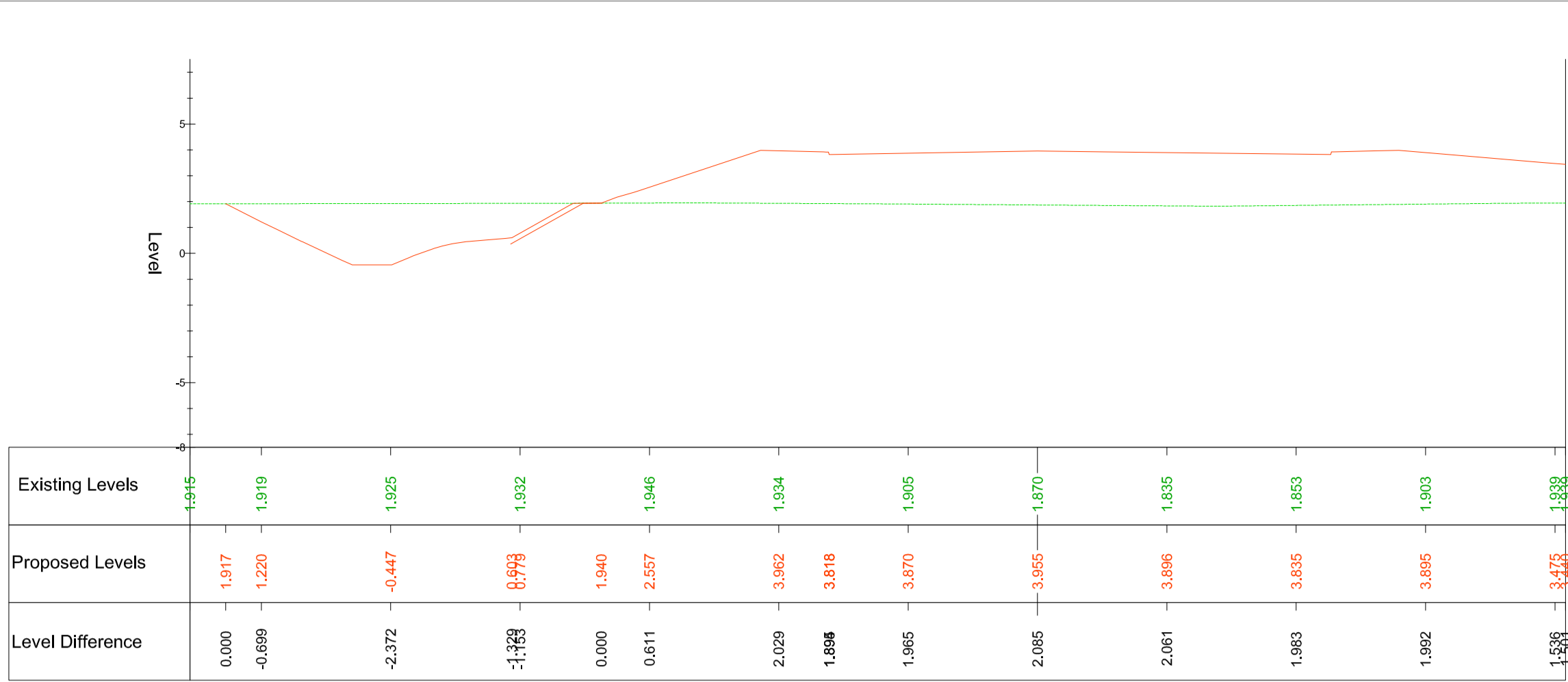

E Roundabout - CL - W Arm - Ch.20.00m

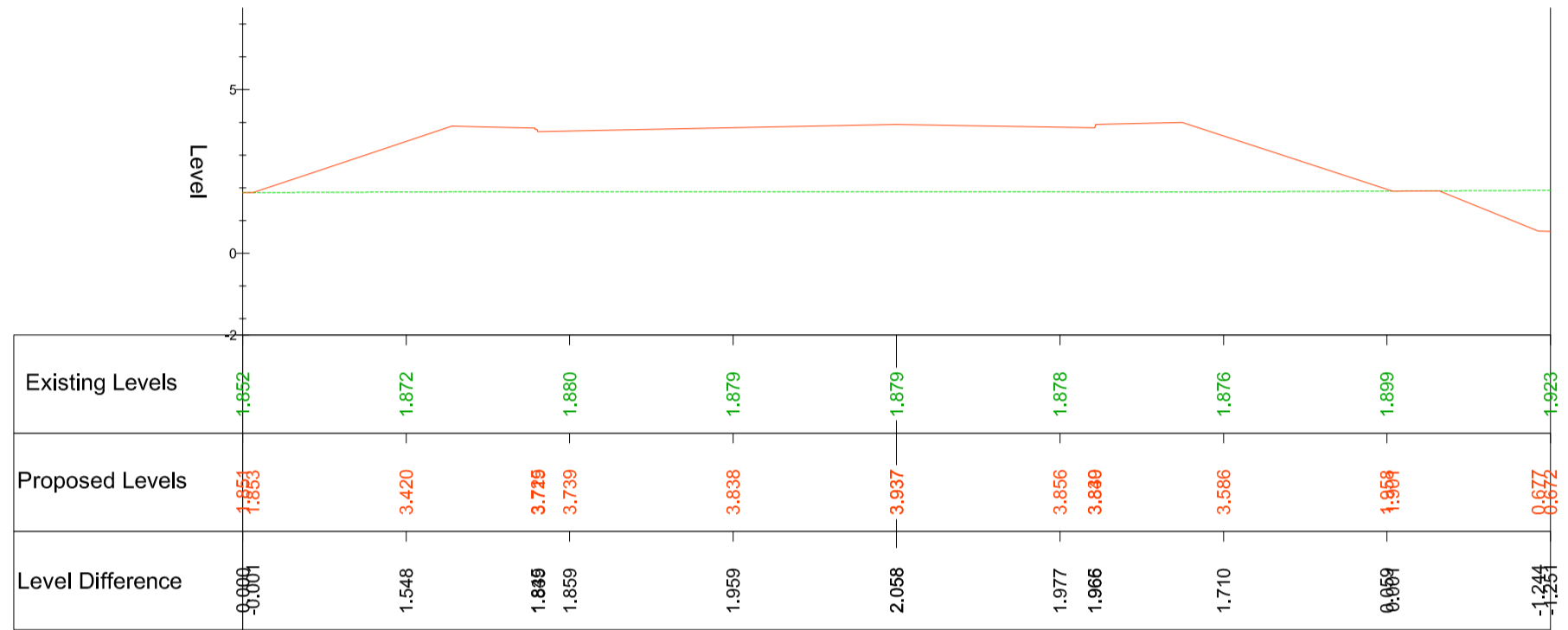

W Roundabout - CL - E Arm - Ch.280.00m

- NOTES:**
- THESE NOTES ARE INTENDED TO AUGMENT DRAWINGS AND SPECIFICATIONS. WHERE CONFLICT OF REQUIREMENTS EXIST THE ORDER OF PRECEDENCE SHALL BE AS SHOWN IN THE SPECIFICATION, OTHERWISE THE STRICTEST PROVISION SHALL GOVERN.
 - THIS DRAWING IS TO BE READ IN CONJUNCTION WITH ALL OTHER RELEVANT ENGINEERS AND ARCHITECTS DRAWINGS.
 - DRAWINGS NOT TO BE SCALED. ALL DIMENSIONS TO BE CHECKED ON SITE BY THE CONTRACTOR. ANY DISCREPANCIES TO BE NOTIFIED TO THE ENGINEER AND FURTHER INSTRUCTIONS OBTAINED BEFORE WORK IS COMMENCED.
 - PROPOSED CONTOURS ARE BASED ON THE 3D DESIGN MODEL AND THE TOPOGRAPHICAL SURVEY. THIS DRAWING IS FOR INFORMATION ONLY. REFER TO SETTING OUT DETAILS FOR LEVEL INFORMATION.
 - REFER TO DRAWING NUMBER M181-AWP-01-01-DR-Q-0321 - CROSS SECTION OVERVIEW FOR SPECIFIC CHAINAGE LOCATION.

- KEY:**
- PROPOSED GROUND
 - EXISTING GROUND

C01 FOR CONSTRUCTION	20.05.24	GDV	BH	BH
P01 FIRST ISSUE	29.09.22	CK	RL	JAG
Rev Description	Date	By	Chk	App

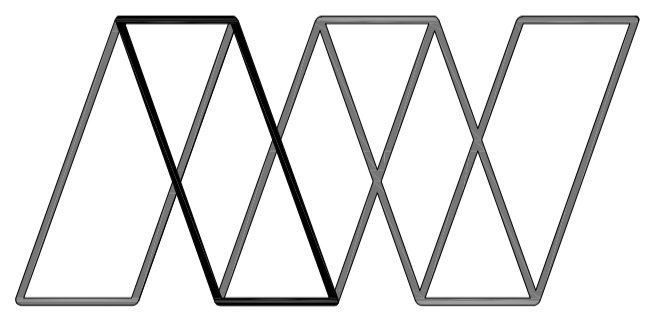

Alan Wood & Partners

<p>York Office Omega 2 Monks Cross Drive York YO32 9GZ</p> <p>T. 01904 611594 www.alanwood.co.uk</p>	<p>Consulting Civil & Structural Engineers Project Managers Building Surveyors</p> <p>Hull Lincoln London Scarborough Sheffield Leeds</p> <p>T. 01482 442138 T. 01522 300210 T. 02071 860761 T. 01723 865484 T. 01142 440077 T. 01135 311098</p>
--	--

Project:	M181/B1450 BURRINGHAM ROAD ROUNDABOUT					
Client:	North Lincolnshire Council					
Drawing:	CROSS SECTION - CENTRAL ROUNDABOUT - SHEET 1					
Role:	CIVIL ENGINEER					
Drawing Status:	FOR CONSTRUCTION					
Job. no.	47603	Scale@: A1: 1:200	Rev. C01			
Project	Originator	Volume	Level	Type	Role	Number
M181 - AWP - 01 - 01 - DR - D - 0328						